

CERTIFIED CORNER RECORDATION

Corner 1 MS 6152B T 27 N. R. 31 W. P.M.M. LINCOLN County

I. Record: 1901 Mineral survey by Burton Adams: Set a post 5 ins. square, 4ft. long 2 ft. deep, from which:

A blazed Hemlock, 10 ins. diam., bears N56°48'W., 57.00 ft. dist., marked 1-6152B BT.
A blazed Cedar, 8 ins. diam., bears N15°30'E., 86.00 ft. dist., marked 1-6152B BT.

II. Found: No evidence found

III. Perpetuation: At the calculated position from survey, set a aluminum pipe 2½ ins. diam. 30 ins. long 24 ins. in the ground, with a ¾ in. diam. aluminum cap marked as shown below :

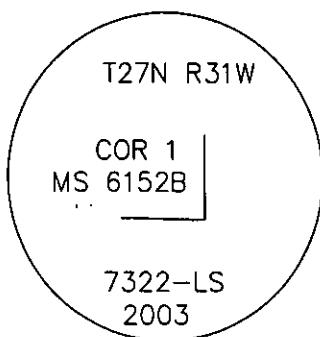

From which:

A Larch, 13 ins. diameter, bears N54°E., 22.30 ft. dist., scribed 1-6152B BT.
A Grand fir, 6 ins. diameter, bears N44°W., 16.55 ft. dist., scribed 1-6152B BT.

Painted red bands around BT's and attached Bearing Tree and Land Survey Monument signs.

Raise a collar of stone 2 ft. diam. around the set monument.

Magnetic declination: 20° East assumed

Equipment used: Hand compass and loggers tape

Kootenai Surveyors Inc., 314 California Av., Libby, MT. 59923 (406) 293-4354

Gold Bugg Mill Site

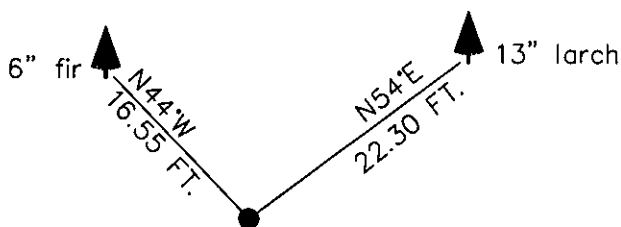

SKETCH OF CORNER

CERTIFICATION

I, John Damon
certify the information shown herein is true and correct.

John Damon
Signature Ground Party Chief

I, Alvah F. Hughes
certify that this Corner Record correctly represents work performed by me or under my direction in compliance with the "Corner Recordation Act" (70-22-101, et seq., M.C.A.)

Alvah F. Hughes
Signature of Surveyor & Seal

Date: 12/9/2004 Reg. No. 7322-LS

Employer: Kootenai Surveyors Inc.

Office of Clerk and Recorder. County of Lincoln. This "corner

record" was filed 181262 BOOK: CCR CC&R'S PAGE: 10714 Pages: 1

was noted on the STATE OF MONTANA LINCOLN COUNTY

book No. RECORDED: 12/14/2004 12:54 KOI: CC&R'S

CORAL M. CUMMINGS CLERK AND RECORDER

FEE: \$0.00

BY: Coral M. Cummings

TO: FILED

Cross Index No. _____ T. 27N. R. 31W. P.M., MT

Adopted July 1, 1981, Montana Board of Professional Engineers & Land Surveyors

UNSURVEYED
SEC 36

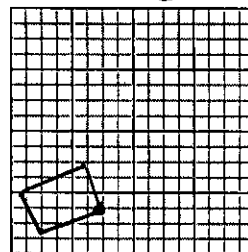

• corner this sheet