

CERTIFIED CORNER RECORDATION

Corner CS 1/16 S13 T. 27 N. R. 30 W. P.M.M. Lincoln County

I. Record: 1977 COS No. 310 and Land Corner Record by J.H. Ninneman: Set a 5/8 inch diameter steel rod with cap stamped JHN 4661S, from which:

A fir, 10 ins. diam., bears S65°W., 8.6 ft. dist. mkd. CS 1/16 S13 BT.
A pine, 10 ins. diam., bears S78°E., 21.0 ft. dist. mkd. CS 1/16 S13 BT.

1992 Land Corner Record by A. F Hughes: Replaced found Ninneman rebar with a 2 1/2 inch diameter Aluminum pipe with a 3 1/4 inch diameter Aluminum cap from which:

A spruce, 16 ins. diam., bears N64°E, 75.30 ft. dist., mkd. CS 1/16 S3 BT.
A hemlock, 7 ins. diam., bears N20°E., 27.30 ft. dist., mkd. with X with BT at base.

II. Found: A 2 1/2 ins. diam. Aluminum pipe with a 3 1/4 ins. diam. Aluminum cap mkd. as shown below from which:

A hemlock, 9 ins. diam., bears N12°E., (N20°E), 27.30 ft. dist., marked X and BT on base.
A spruce, 18 ins. diam., bears N60°E., (N64°E), 75.30 ft. dist., with visible scribes.

III. Perpetuation:

Painted faces and 6 in. wide red bands to all bearing trees and attached Land Survey Monument and Bearing Tree signs where needed.

Set a steel post on line 2.60 ft. East of found monument with attached Survey Monument and Property Line stickers.

Magnetic declination: 18° East

Equipment used: Hand compass and loggers tape

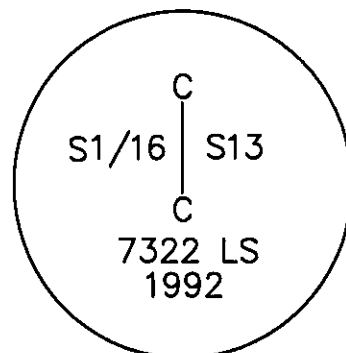

Kootenai Surveyors Inc., 314 California Av., Libby, MT. 59923 (406) 293-4354

PCTC Schreiber Lake 2010

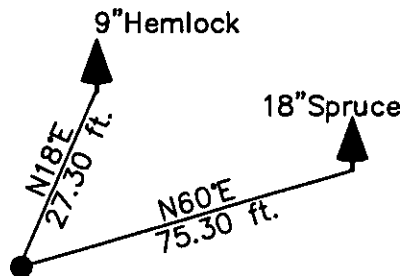

SKETCH OF CORNER

CERTIFICATION

I, Kelly Rooney
certify the information shown herein is true and correct.

Kelly Rooney
Signature Ground Party Chief

I, Alvah F. Hughes
certify that this Corner Record correctly represents work performed by me or under my direction in compliance with the "Corner Recordation Act" (70-22-101, et seq., M.C.A.)

Alvah F. Hughes
Signature of Surveyor & Seal

Date: 11/08/2010 Reg. No. 7322-LS

Employer: Kootenai Surveyors Inc.

Office of Clerk and Recorder, County of Lincoln This "corner

record" was filed for record on 229745 BOOK: CCR CC&R'S PAGE: 11665 Pages: 1

was noted on the cross-ir STATE OF MONTANA LINCOLN COUNTY

book No. RECORDED: 11/16/2010 2:05 KOI: CC&R'S

TAMMY D. LAUER CLERK AND RECORDER

FEE: \$0.00

BY: Alvah F. Hughes

TO: KOOTENAI SURVEYORS INC. P.O. BOX 393, LIBBY, MT 59923

Cross Index No. M 23 T. 27N R. 30W P.M., MT

Adopted July 1, 1981, Montana Board of Professional Engineers & Land Surveyors

Sec. 13

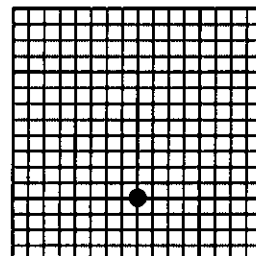

• corner this sheet