

INSTRUCTIONS

1. Original and/or subsequent record used to evaluate the corner position.
2. Description of evidence found, notations in the record, state method of establishing lost or obliterated corners.
3. Description of monument and accessories to perpetuate the corner position.
4. Sketch of corner, show all pertinent data which can best be shown in a sketch example, corner marking, topography ties, position of accessories, etc.
5. Certification must be signed and sealed by Land Surveyor registered in the State of Montana.
6. Fill in Cross Index & Section Diagram at bottom of sheet.

CERTIFIED CORNER RECORDATION

Corner C1/4 Sec. 25 T. 27 North R. 30 West P.M.M. Lincoln County

ORIGINAL

The new corner monument was established as a result of a subdivisional survey of the Section. Said subdivisional survey was made in accordance with methods and procedures contained in the Manual of Surveying Instructions (1973); U.S. Bureau of Land Management.

SET:

Set a standard 2½" x 30" aluminum monument with ¾" aluminum cap, marked as shown below, 24" in the ground with rock cairn around monument, from which:

An 8" Larch bears S51°W, 15.6 feet distant, blaze and scribe "C1/4 S25 BT".

A 6" Larch bears N28°W, 19.8 feet distant, blaze and scribe "C1/4 S25 BT".

Set steel posts with Forest Service decal, 2' north and 2.8' west of monument

Bearing trees were painted red and bearing tree tags attached. Distances were measured to an aluminum nail in side center of trees.

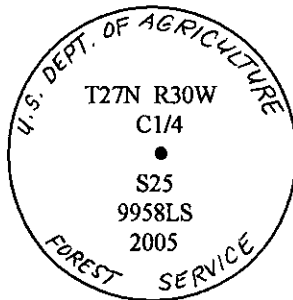

CERTIFICATION

I, James R. Staples

Certify the information shown herein is true and correct.

James R. Staples
Signature Ground Party Chief

I, James R. Staples

certify that this Corner Record correctly represents work performed by me or under my direction in compliance with the "Corner Recordation Act" (70-22-101, et seq., M.C.A.)

James R. Staples
Signature of Surveyor & Seal

Date: 9/14/05 Reg. No 9958LS

Employer: J.R.S. Surveying, Inc.

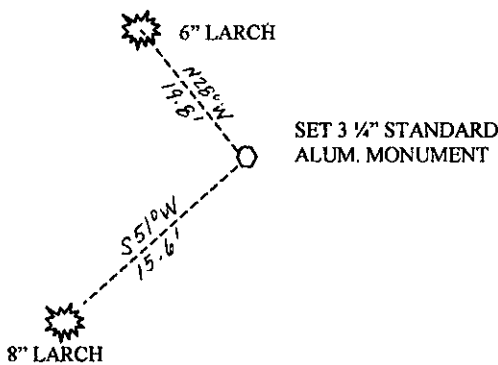
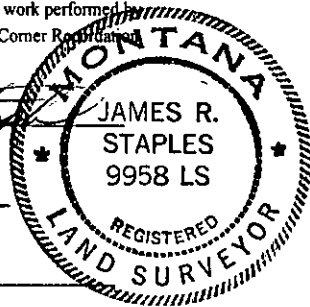

SKETCH OF CORNER

Office of Clerk and Recorder, County of _____ This "corner

record" was filed for record

was noted on the cross-index

book no. _____

188050 BOOK: CCR CC&R'S PAGE: 10846 Pages: 1

STATE OF MONTANA LINCOLN COUNTY

RECORDED: 09/20/2005 10:05 KOI: CC&R'S

CORAL M. CUMMINGS CLERK AND RECORDER

FEE: \$0.00

BY: *James R. Staples*
Deputy

TO: FILED

Cross Index No. T23 T. 27N R. 30W PMM

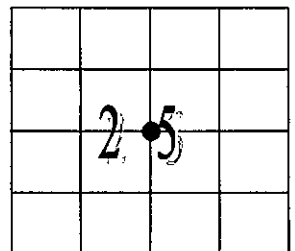

Adopted July 1, 1981, Montana Board of Professional Engineers & Land Surveyors

• - Corner this sheet