

**-CERTIFIED CORNER RECORDATION**

**Corner** 1/4      **Secs.** 1&2      **T.** 27N    **R.** 30W      **P.M., MT**    **Lincoln**    **County**

- I. 1900 G.L.O. Record by Burton S. Adams: Set a limestone, 26x12x3 ins., 20 ins. in the ground, for 1/4 sec. cor., mkd. "1/4" on W. face.

Established two bearing trees:

A fir, 8 ins. diam., bears N81°15'E, 33 lks. dist., mkd. "1/4 S1 BT".  
A pine, 8 ins. diam., bears S61°W, 69 lks. dist., mkd. "1/4 S2 BT".

1969 B.L.M. Remonumentation Record by Roy G. Leedy: The 1/4 sec. cor. of secs. 1 & 2, monu-  
mented with a broken limestone, firmly set, mkd. "1/4" on the W. face, and witnessed by the remains of  
the original bearing trees. At the corner point, set an iron post, 30 ins. long, 2 1/2 ins. diam., 24 ins. in  
the ground, with brass cap mkd. as shown.

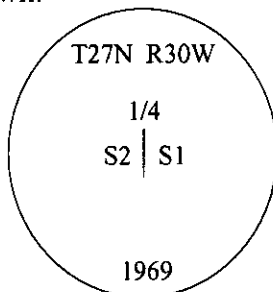

Established two new bearing tree and bury the original stone alongside and raise a collar of stone, 2.0 ft.  
diam., around the iron post.

- II. Found a 2 1/2 in. diam. iron pipe, firmly set, protruding 7 ins. above the ground, with a collar of stone  
surrounding the 3 1/4 in. diam. B.L.M. brass cap, mkd. as shown.

from which:

A pine, 13 ins. diam., bears S89°E, 40.3 ft.. dist., with a healed face. (BLM-record)  
A rotten pine stump, bears S61°W, 45.5 ft. dist., with visible scribe. (GLO-record)  
A fir, 10 ins. diam., bears N70°W, 13.9 ft. dist., with a healed face. (BLM-record)  
A steel post, with Property Boundary and Land Survey Monument decals attached.

- III. Set a 6 ft. galvanized steel guard post, North, 3.0 ft. dist. of the corner, with Property Boundary and  
Land Survey Monuement decals attached.

Painted bearing trees and attached Land Survey Monument and Bearing Tree signs.

Magnetic Declination: 20° East

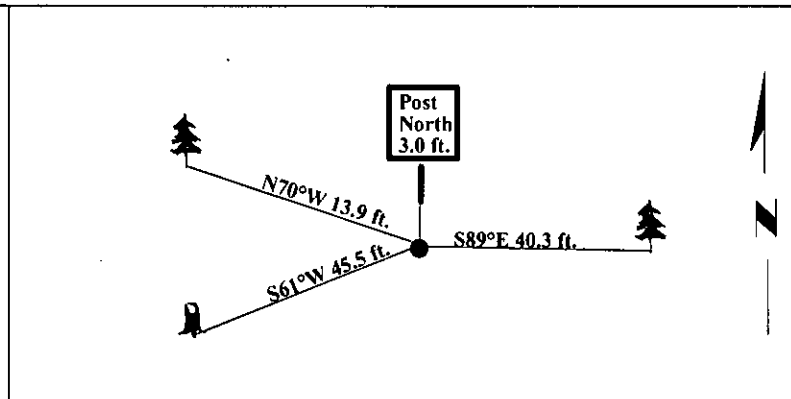

**SKETCH OF CORNER**

**CERTIFICATION**

I. Rex O. Rice  
certify the information shown herein is true and correct.

*Rex O. Rice*

I. Steven A. Boyer  
certify that this Corner Record correctly represents work performed by me or under my  
direction in compliance with the "Corner Recordation Act" (70-22:101, et seq., M.C.A.)

*Steven A. Boyer*  
Signature of Surveyor & Seal

Date: 6/29/98

Reg. No.: 9750LS

Employer: U.S. FOREST SERVICE

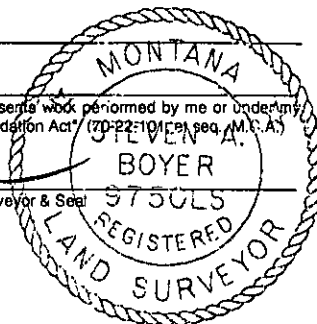

Office of Clerk and Recorder, County of Lincoln. This "corner record" was filed for  
record on 8-19-98 and was noted on the cross-index plat and is assigned page No. 10194  
in book No. \_\_\_\_\_

*Coral M. Cummings*  
County Official

**Sec. 2**

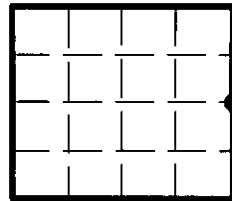

● - corner this sheet

No.

Cross Index

C-21

T.

27N

R.

30W

P.M., MT