

-CERTIFIED CORNER RECORDATION

Corner 1/4 **Secs.** 2&3 **T.** 27N **R.** 30W **P.M., MT** **Lincoln** **County**

- I. 1900 G.L.O. Record by Burton S. Adams: Set a pine post, 3.0 ft. long, 5 ins. square, 24 ins. in the ground, for 1/4 sec. cor., mkd. "1/4 S3" on the W. face.

Established two bearing trees:

A pine, 32 ins. diam., bears S32°45'E, 19 lks. dist., mkd. "1/4 S2 BT".
A pine, 18 ins. diam., bears N38°45'W, 54 lks. dist., mkd. "1/4 S3 BT".

1966 B.L.M. Remonumentation Record by Roy G. Leedy: The 1/4 sec. cor. of secs. 2 & 3, as determined by the remains of the original bearing trees. Found original monument, a limestone, 18x10x6 ins., mkd. "1/4" lying loose. At the corner point, set an iron post, 30 ins. long, 2 1/2 ins. diam., 24 ins. in the ground, with brass cap mkd. as shown.

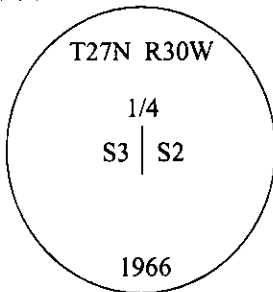

Established two new bearing tree and bury the original stone alongside the iron post.

- II. Found a 2 1/2 in. diam. iron pipe, firmly set, protruding 2 ins. above the ground, with a 3 1/4 in. diam. B.L.M. brass cap, mkd. as shown.

from which:

A larch, 13 ins. diam., bears N10°E, 25.0 ft. dist., with a healed face. (BLM-record)
A rotten pine stump, bears S33°E, 12.5 ft. dist., with visible scribe. (GLO-record)
A pine, 24 ins. diam., bears N39°W, 35.6 ft. dist., with a chopped face. (GLO-record)
A fir, 16 ins. diam., bears N56°W, 15.2 ft. dist., with a healed face. (BLM-record)

- III. Painted bearing trees and attached Land Survey Monument and Bearing Tree signs.

Magnetic Declination: 20° East

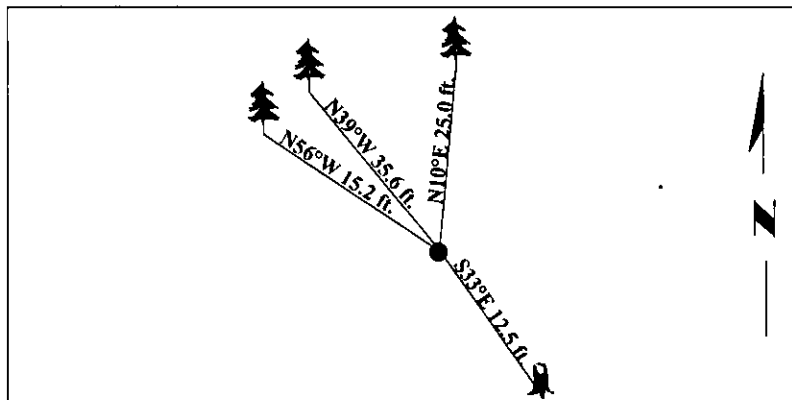

SKETCH OF CORNER

CERTIFICATION

- I. Rex O. Rice
certify the information shown herein is true and correct.

Rex O. Rice

- I. Steven A. Boyer
certify that this Corner Record correctly represents work performed by me or under my direction in compliance with the "Corner Recordation Act" (70-22-101, et seq., M.C.A.)

Steven A. Boyer
Signature of Surveyor & Seal

Date: 6/29/98

Reg. No.: 9750LS

Employer: U.S. FOREST SERVICE

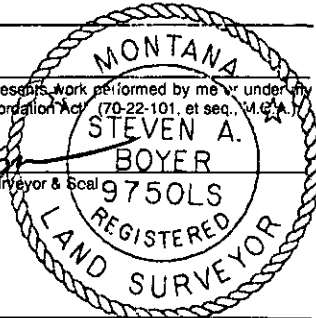

Office of Clerk and Recorder, County of Lincoln. This "corner record" was filed for record on 8-19-98 and was noted on the cross-index plat and is assigned page No. 10193 in book No. _____.

Carol M. Cunningham
County Official

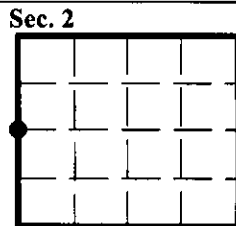

• - corner this sheet