

CERTIFIED LAND CORNER RECORDATION

DESCRIPTION OF CORNER EVIDENCE FOUND, AND ORIGINAL RECORD (IF KNOWN)

Section Corner common to sections 17,18,19 and 20 Twp. 27 N., R. 29 W P.M.M. destroyed.

DESCRIPTION OF MONUMENT AND ACCESSORIES ESTABLISHED TO PERPETUATE THE ORIGINAL LOCATION OF THIS CORNER:

Date of work: 12/18/80

See sketch on reverse side

SKETCH, WITH COURSE AND DISTANCE TO ADJACENT CORNERS IF DETERMINED IN THIS SURVEY. (MAY SKETCH OR PASTE REPRODUCTION ON REVERSE SIDE.)

See sketch on reverse side.

Surveyor's Seal

I, David Stanley certify that the information shown herein is true and correct.

Signature of David Stanley, Chief of Ground Party

I, Jack H. Ninneman certify that I have carefully performed or reviewed the work done on the diagrammed corner as reported on this recordation form and approve the same.

Signature of Jack H. Ninneman, Surveyor

DIAGRAM OF CORNER:

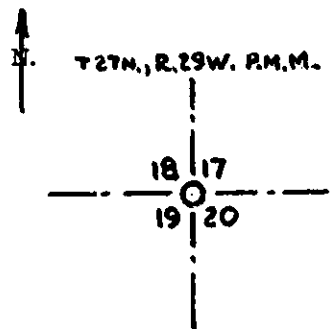

= Corner recorded on the sheet

46613 Registration Number

Office of Clerk and Recorder, County of Lincoln

This "corner record" was filed for record on the 28th day of January, 1981, was noted on the cross-index plat and is assigned page No. 972-A, in book No. 1

Signature of County Official: Clarence L. Taughan, Deputy

Cross Index No. J-5 T. 27N R. 29W Mer. N-3 N-7 N-5 P-5

TWP. 27 N., R. 29 W. P.M.M.

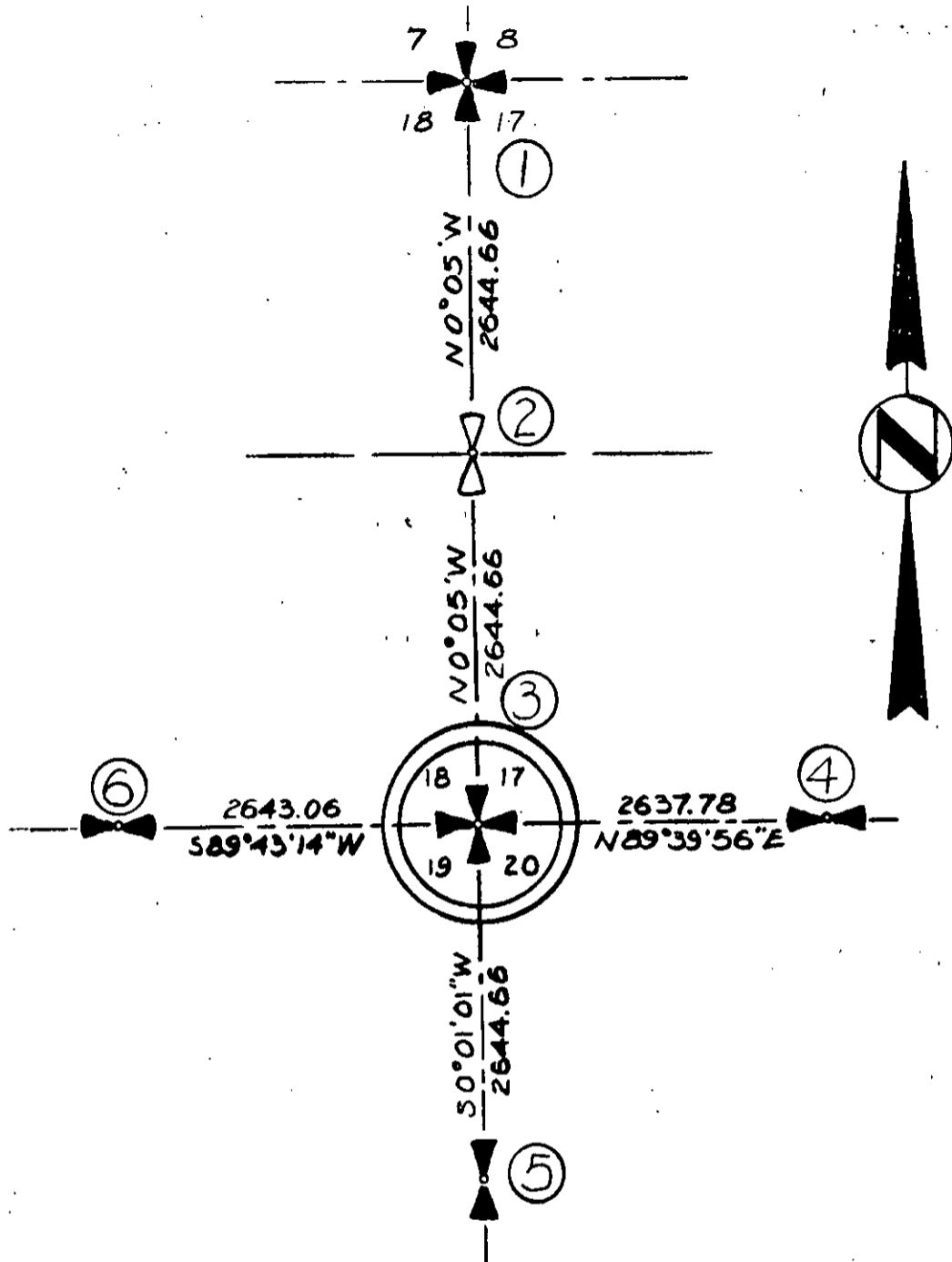

- (1) B.L.M. B.C. 4 B.T.s
- (2) Corner destroyed position computed. Not set.
- (3) Set a Brass Cap from which a 50" Cottonwood bears N 73° E 29.6 feet Scribed S 17 B.T. and posted. A 20" Cottonwood bears S 58° 30' E 31.1 feet Scribed S 20 B.T. and posted.
- (4) B.L.M. B.C. 1 B.T.
- (5) B.L.M. B.C. 2 B.T.s
- (6) B.L.M. B.C. 2 B.T.s

