

INSTRUCTIONS

1. Original and/or subsequent record used to evaluate the corner position.
2. Description of evidence found, note discrepancies in the record, state method of establishing lost or obliterated corners.
3. Description of monument and accessories set to perpetuate the corner position.
4. Sketch or corner, show all pertinent data which can best be shown in a sketch example, corner marking, topography lies, position of accessories, etc.
5. Certification must be signed and sealed by Registered Land Surveyor in State of Montana.
6. Fill in Cross Index & Section Diagram at bottom of sheet.

CERTIFIED CORNER RECORDATION

Corner $\frac{1}{4}$ cor. sec. 34 and 3 T. 27N R. 29W P.M.M. Lincoln County

Record 1902

Set a lime stone 15x10x5 ins., 10 ins. in the ground for $\frac{1}{4}$ cor. marked $\frac{1}{4}$ on N face; from which;

A fir, 10 ins. dia. bears N46°45'E, 27 lks. dist. marked $\frac{1}{4}$ S34 BT
A fir, 10 ins. dia. bears S23°W, 21 lks. dist. marked $\frac{1}{4}$ S3 BT

Record 1966 B.L.M.

The $\frac{1}{4}$ sec. cor. of secs. 3 and 34 on the N. bdy. of the Tp., monumented with a limestone, 16x10x6 ins., firmly set, marked with $\frac{1}{4}$ on the N. face and witnessed by the remains of one of the original bearing trees. At the corner point. Set a iron post, 30" long, 2 $\frac{1}{2}$ " dia., 24" in the ground, with a brass cap marked as shown below. From which;

The original bearing trees:

A dead fir, 12" dia. bears S23°W, 21 lks. dist. marked $\frac{1}{4}$ S3 BT

The new bearing trees:

A larch, 8" dia., bears S3°W, 27 lks. dist. marked $\frac{1}{4}$ S3 BT

A larch, 14" dia., bears N27 $\frac{1}{2}$ °W, 50 lks. dist. marked $\frac{1}{4}$ S34 BT

Bury the original stone alongside the iron post.

FOUND

Found a standard B.L.M. brass cap on a steel post, standing dead 8" tamarack S5°W 18.0' scribing partly readable, Dead and down 14" tamarack N26°W 33.0' scribed $\frac{1}{4}$ S34 BT, No original BTs found

NEW BEARING OBJECTS

A U.S.D.A. 6' steel post set 18" into the ground bears South 13.45'
A U.S.D.A. 6' steel post set 18" into the ground bears North 13.50'
Attached required signs to bearing objects.
a U.S.D.A. 6' steel post set 18" into the ground bears West 3' with Land Survey Monument sticker

note: no live trees within 400' radius.

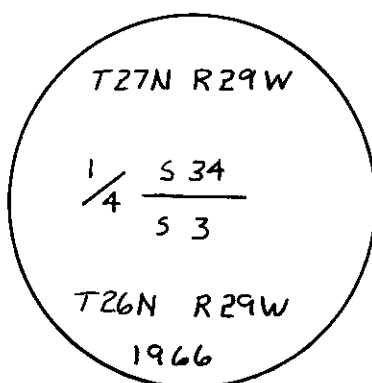
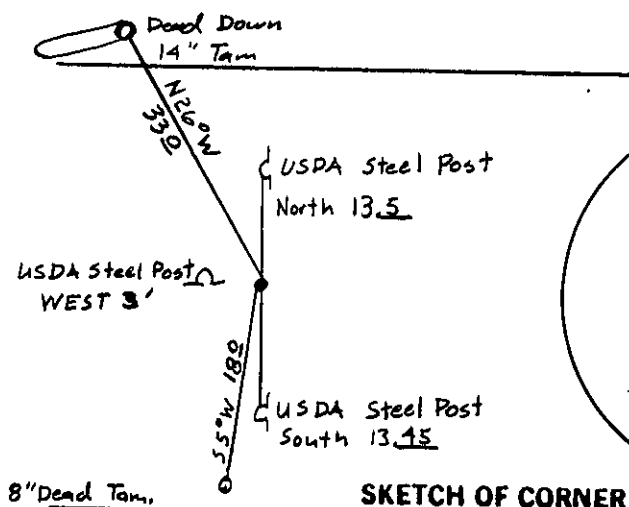

CERTIFICATION
I, Dan Croft,
certify the information shown herein is true and correct.

Signature of Ground Party
I, H. Gene Warren,
certify that this Corner Record correctly represents the monument
by me or under my direction in compliance with the "Corner
Recordation Act" (70-23-101, et seq., M.D.A.)

H. Gene Warren
Signature of Surveyor & Seal

Date: 6/27/89 Reg. No. 2734S
Employer: Rocky Mt. Surveyors

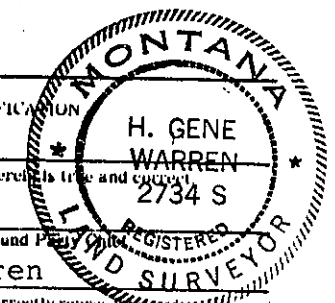

Office of Clerk and Recorder, County of Lincoln. This "corner
record" was filed for record on the July 3 day of 1989
was noted on the cross-index plat and is assigned page No. 4063, in
book No. _____

James B. Sugit by Bill Backoff
County Official Dip.

Cross Index No. Z-15 T. 27N R. 29W P.M.M.

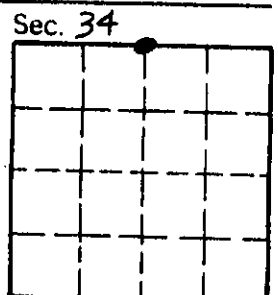

• - corner this sheet