

INSTRUCTIONS

1. Original and/or subsequent record used to evaluate the corner position.
2. Description of evidence found, note discrepancies in the record, state method of establishing lost or obliterated corners.
3. Description of monument and accessories set to perpetuate the corner position.
4. Sketch of corner, show all pertinent data which can best be shown in a sketch example, corner marking, topography lies, position of accessories, etc.
5. Certification must be signed and sealed by Registered Land Surveyor in State of Montana.
6. Fill in Cross Index & Section Diagram at bottom of sheet.

CERTIFIED CORNER RECORDATION

Corner 1/4 Secs. 27 and 34 T. 27N R. 29W P.M.M. Lincoln County

Record 1902

Set a limestone 15x12x10 ins. 10 ins. in the ground, for 1/4 sec. cor. marked 1/4 on N. face; From which:

A fir, 7" dia. bears N78°45'E, 54 lks. dist. marked 1/4 S27 BT
 A tamarack 30" dia. bears S77°15'E, 53 lks. dist. marked 1/4 S34 BT

FOUND

Original stone 15"x12"x10" with 1/4 on North face well set; from which
 Original BTs A 30" tamarack bears S75°E 35.8' scribe overgrown
 A 14" fir bears N83°E 36.2' scribe overgrown.

SET

Set a standard Forest Service 3 1/4" aluminum cap on a aluminum pipe at the exact center of the base of the corner stone, which is now buried along the north side of the new monument.
 Maintained Original BTs painted red bands around BTs and attached required signs to BTs. A U.S.D.A. 6' steel post bears West 3'.

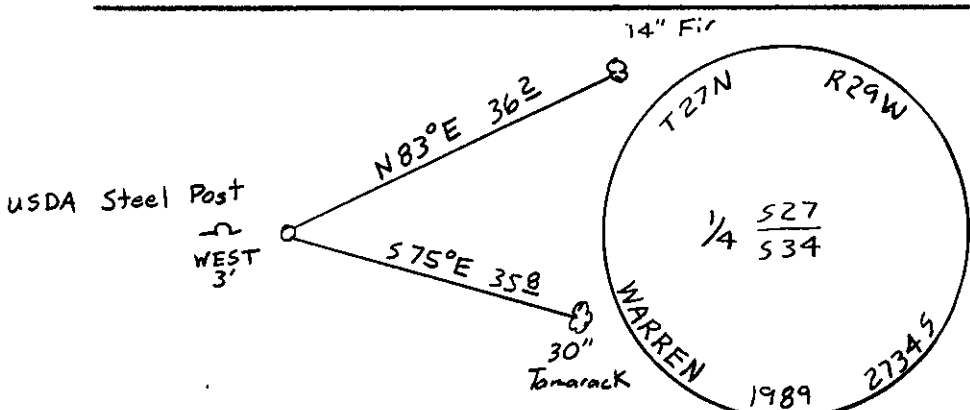

SKETCH OF CORNER

CERTIFICATION

I, Dan Croft certify the information shown herein is true and correct.

Signature of Registered Professional Surveyor

I, H. Gene Warren certify that this Corner Record correctly represents the monument returned by me or under my direction in compliance with the "Corner Recordation Act" (70-21-101, et seq., M.D.A.)

H. Gene Warren
 Signature of Surveyor & Seal

Date: 6/27/89 Reg. No. 2734S
 Employer: Rocky Mt. Surveyors

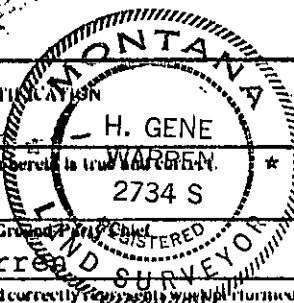

Office of Clerk and Recorder, County of Lincoln. This "corner record" was filed for record on the July 3 day of 1989 was noted on the cross-index plat and is assigned page No. 4062, in book No. _____

Janet BF Sugil by Bill Beckhoff
 County Official Dep.

