

## INSTRUCTIONS

1. Original and/or subsequent record used to evaluate the corner position.
2. Description of evidence found, note discrepancies in the record, state method of establishing lost or obliterated corners.
3. Description of monument and accessories set to perpetuate the corner position.
4. Sketch of corner, show all pertinent data which can best be shown in a sketch example, corner marking, topography ties, position of accessories, etc.
5. Certification must be signed and sealed by Registered Land Surveyor in State of Montana.
6. Fill in Cross Index & Section Diagram at bottom of sheet.

## CERTIFIED CORNER RECORDATION

Corner ¼ secs. 26 and 27 T. 27N R. 29W P.M.M. Lincoln County

Record 1902

Set a limestone, 18x12x3 ins., 12 ins. in the ground, for ¼ sec. cor. marked ¼ on W. face; From which:

A fir, 6" dia. bears N44°13'E, 24 lks. dist. marked ¼ S26 BT  
A fir, 6" dia. bears N87°45'W, 12 lks. dist. marked ¼ S27 BT

FOUND

Original stone 18"x12"x3" with ¼ on West face well set; From which  
Original BTs, A 10" fir bears N45°E 16.82' scribe partly visible  
A 8" fir bears N88°W 7.95' scribe overgrown.

SET

Set a standard Forest Service 3¼" aluminum cap on a aluminum pipe at the exact center of the base of the corner stone, which is now buried along the West side of the new monument.  
Maintained Original BTs painted red bands around BTs and attached required signs to BTs. A U.S.D.A. 6' steel post bears South 3'

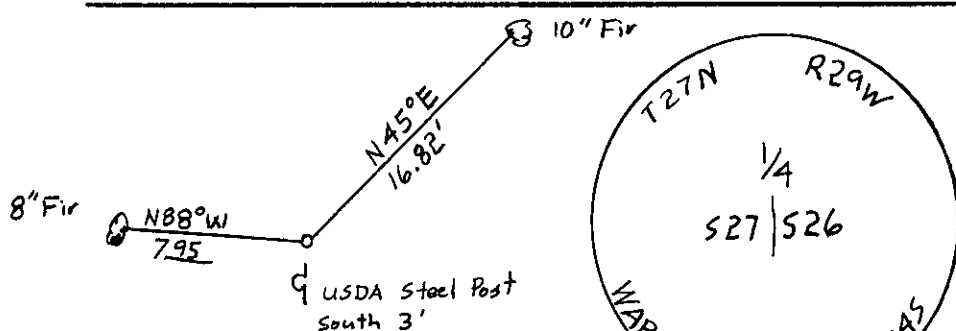

SKETCH OF CORNER

1. Dan Croft certify the information shown herein is true and correct.

2. H. Gene Warren certify that this Corner Record correctly represents work performed by me or under my direction in compliance with the "Corner Recordation Act" (70-22-101, et seq., M.D.A.)

Signature of Surveyor & Seal  
Date: 6/27 Reg. No. 2734S  
Employer: Rocky Mt. Surveyors

Office of Clerk and Recorder, County of Lincoln. This "corner record" was filed for record on the July 3 day of 1989 was noted on the cross-index plat and is assigned page No. 4061, in book No. \_\_\_\_\_

Janet B. Sigel by Bill Backoff  
County Official Dep.

Cross Index No. T-17 T. 27N R. 29W P.M.M.

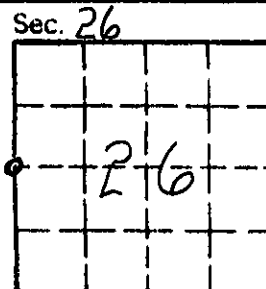

• - corner this sheet