

INSTRUCTIONS

1. Original and/or subsequent record used to evaluate the corner position.
2. Description of evidence found, note discrepancies in the record, state method of establishing lost or obliterated corners.
3. Description of monument and accessories set to perpetuate the corner position.
4. Sketch of corner, show all pertinent data which can best be shown in a sketch example, corner marking, topography ties, position of accessories, etc.
5. Certification must be signed and sealed by Land Surveyor registered in the State of Montana.
6. Fill in Cross Index & Section Diagram at bottom of sheet.

CERTIFIED CORNER RECORDATION

Corner N1/4 Sec. 27 T. 27N R. 29W P.M.M. Lincoln County

GLO - 1902 - Burton Adams and William Weeks

.....39.98 chains, Set a limestone 15x10x4 inches, 10 inches in the ground for 1/4 Section corner marked 1/4 on north face; from which:

A pine, 10 inches diameter, bears N58°45'E, 9 links (5.94 feet) distant, marked 1/4 S22 BT.

A pine, 8 inches diameter, bears S62°30'E, 22 links (14.52 feet) distant, marked 1/4 S27 BT.

FOUND:

Found original stone of record size, 14x9x4 inches firmly set with marks on north face; from which:

Root remains bears N59°E, 6.0 feet distant.

ESTABLISH:

Replace original found stone with 3 1/4" aluminum cap on standard 2 1/2" x 30" standard aluminum monument, 24 inches in the ground, marked as shown below, from which establish two new accessories for this corner:

A 7 inch lodgepole pine bears S76 1/4°W, 18.87 feet distant, blaze and scribe "1/4 S27 BT".

An 8 inch lodgepole pine bears N15°W, 12.48 feet distant, blaze and scribe "1/4 S22 BT".

Bearing tree signs were attached and blazes painted red.

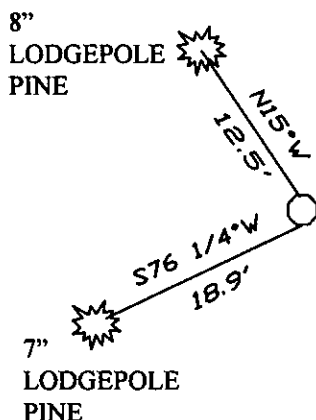

SKETCH OF CORNER

CERTIFICATION

I, Stephen Jeske
Certify the information shown herein is true and correct.

Stephen Jeske
Signature Ground Party Chief

I, Stephen Jeske
certify that this Corner Record correctly represents work performed by me or under my direction in compliance with the "Corner Recordation Act" (70-22-101, et seq., M.C.A.)

Stephen Jeske
Signature of Surveyor & Seal

Date: 7-15-2008 Reg. No. 14230

Employer: J.R.S. Surveying, Inc.

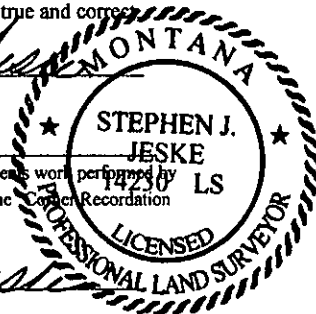

Office of Clerk and Recorder, County of Lincoln. This "corner
record" was filed for record on 213158 BOOK: CCR CC&R'S PAGE: 11260 Pages: 1
STATE OF MONTANA LINCOLN COUNTY
was noted on the cross-index plat RECORDED: 07/28/2008 12:38 KOI: CCR'S
TAMMY D. LAUER CLERK AND RECORDER
book no. FEE: \$0.00 BY:
TO: J.R.S. SURVEYING P.O. BOX 1050, LIBBY, MONTANA 59923

County Official

Cross Index No. R15 T. 27N R. 29W PMM

Adopted July 1, 1981, Montana Board of Professional Engineers & Land Surveyors

• - Corner this sheet

