

INSTRUCTIONS

1. Original and/or subsequent record used to evaluate the corner position.
2. Description of evidence found, note discrepancies in the record, state method of establishing lost or obliterated corners.
3. Description of monument and accessories set to perpetuate the corner position.
4. Sketch of corner, show all pertinent data which can best be shown in a sketch example, corner marking, topography ties, position of accessories, etc.
5. Certification must be signed and sealed by Land Surveyor registered in the State of Montana.
6. Fill in Cross Index & Section Diagram at bottom of sheet.

CERTIFIED CORNER RECORDATION

Corner S1/4 Sec. 16 T. 27N R. 29W P.M.M. Lincoln County

GLO - 1902 - Burton Adams and William Weeks

..... 39.92 chains A fir, 4 inches diameter, for 1/4 section corner. I mark 1/4 S16 on north and 1/4 S21 on south sides; from which:

- A fir, 10 inches diameter, bears N46°15'E, 26 links (17.16 feet) distant, marked "1/4 S16 BT".
- A fir, 8 inches diameter, bears S66°E, 31 links (20.46 feet) distant, marked "1/4 S21 BT".

FOUND:

No evidence of corner tree or original bearing trees were found.
 Found an 8" fir with visible scribe and bearing tree tag.
 Found a 9" fir with visible scribe and bearing tree tag.

ESTABLISH:

Establish position for 1/4 corner by proportion. Set a 3 1/2" aluminum cap on 2 1/2" x 30" standard aluminum monument, 24 inches in the ground, marked as shown below; from which accepted found bearing tree accessories for new position of 1/4 corner.

- An 8 inch fir, with open blaze and scribed S21 RM, bears S75 3/4°E, 9.4 feet distant.
 - A 9 inch fir, with open blaze and scribed S16 RM, bears N25 1/2°W, 5.9 feet distant.
- Bearing trees were painted red and new bearing tree tags were attached.

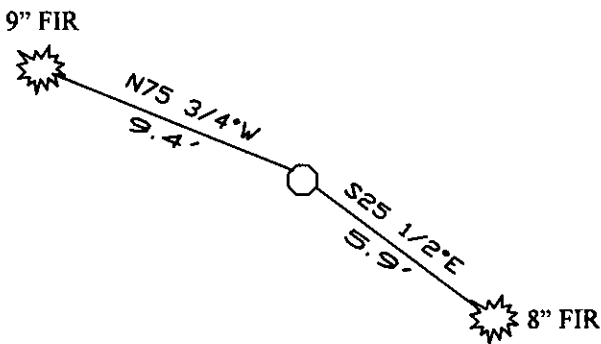

SKETCH OF CORNER

CERTIFICATION

I, Stephen Jeske
 Certify the information shown herein is true and correct.

Stephen Jeske
 Signature Ground Party Chief

I, Stephen Jeske
 certify that this Corner Record correctly represents work performed by me or under my direction in compliance with the "Corner Recordation Act" (70-22-101, et seq., M.C.A.)

Stephen Jeske
 Signature of Surveyor & Seal

Date: 7-15-2008 Reg. No. 14230

Employer: J.R.S. Surveying, Inc.

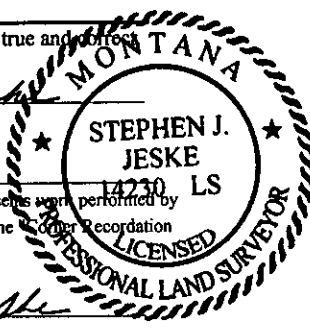

Office of Clerk and Recorder, County of _____ This "corner record" was filed for record on _____ 213154 BOOK: CCR CC&R'S PAGE: 11256 Pages: 1
 STATE OF MONTANA LINCOLN COUNTY
 was noted on the cross-index plat and RECORDED: 07/28/2008 12:25 KOI: CC&R'S
 book no. _____ TAMMY D. LAUER CLERK AND RECORDER
 FEE: \$0.00 BY: *Tammy D. Lauer*
 TO: J.R.S. SURVEYING P.O. BOX 1030, LIBBY, MONTANA 59923
 County Official

	16	

Cross Index No. N11 T. 27N R. 29W PMM

• - Corner this sheet