

## INSTRUCTIONS

1. Original and/or subsequent record to evaluate the corner position.
2. Description of evidence found, note discrepancies in the record, state method of establishing lost or obliterated corners.
3. Description of monument and accessories set to perpetuate the corner position.
4. Sketch of corner, show all pertinent data which can best be shown in a sketch example, corner marking, topography ties, position of accessories, etc.
5. Certification must be signed and sealed by Land Surveyor registered in the State of Montana.
6. Fill in Cross Index & Section Diagram at bottom of sheet.

## CERTIFIED CORNER RECORDATION

Corner NW Cor. Sec. 27 T. 27N R. 29W P.M.M. Lincoln County**GLO - 1902 - Burton Adams and William Weeks**

Set a limestone 18x10x6 inches, 12 inches in the ground for corner of Sections 21, 22, 27, and 28, marked with 2 notches on south and 3 notches on east edges; from which:

- A pine, 9 inches diameter, bears N59°15'E, 25 links (16.5 feet) distant, marked T27N R29W S22 BT.
- A fir, 15 inches diameter, bears S56°W, 9 links (5.94 feet) distant, marked T27N R29W S27 BT.
- A pine, 8 inches diameter, bears S86°E, 25 links (16.5 feet) distant, marked T27N R29W S28 BT.
- A fir, 6 inches diameter, bears N9°45'W, 32 links (21.12 feet) distant, marked T27N R29W S21 BT.

**BLM - 1969**

The corner of Sections 21, 22, 27, and 28 monumented with a limestone 16x10x6 inches, firmly set, marked 3 notches on the east and 2 notches on the south edges and witnessed by the remains of the original bearing trees:

- A burnt stump bears S56°W, 9 links (5.94 feet) distant with no visible marks.

At the corner point, set an iron post, 30 inches long, 2½ inches diameter, 24 inches in the ground with brass cap marked as shown below; from which:

- A pine, 6 inches diameter, bears N6°E, 8 links (5.28 feet) distant, marked T27N R29W S22 BT.
- A pine, 6 inches diameter, bears N76°W, 18 links (11.88 feet) distant, marked T27N R29W S21 BT.

Bury the original stone along side and raise a collar of stone, 2 feet diameter, around the iron post.

**1980 - Alvan Hughes**

Found a 2½" diameter iron pipe, 9 inches above ground with ¾" diameter brass cap, marked as shown below; from which:

- A lodgepole pine, 6 inches diameter, bears N16°E, 5.4 feet distant, scribed T27N R29W S22 BT (BLM).
- A lodgepole pine, 8 inches diameter, bears N50°E, 17.7 feet distant, scribed S22 RM.
- A lodgepole pine, 7 inches diameter, bears S64°E, 3.1 feet distant, scribed S27 RM.
- A rotten stump, 15 inches diameter, bears S42°W, 5.2 feet distant, no visible scribing (original).
- A lodgepole pine, 6 inches diameter, bears S80°W, 16.8 feet distant, scribed S28 RM.
- A lodgepole pine, 7 inches diameter, bears N77°E, 11.7 feet distant, scribed T27N R29W S21 BT (BLM).
- A lodgepole pine, 8 inches diameter, bears N55°W, 4.0 feet distant, scribed S21 RM.

**FOUND:**

- A 9" lodgepole pine with open blaze and visible scribe, bears N52½°E, 17.5 feet distant with existing bearing tag (S56°W, 27½ links - 18.15 feet).
- A 7" lodgepole pine with open blaze and visible scribe, bears N16°E, 5.4 feet distant with existing bearing tag (S6°W, 8 links - 5.28 feet).
- An 8" lodgepole pine with open blaze and visible scribe, bears N56°W, 3.8 feet distant, with existing bearing tree tag (S54°E, 5 links - 3.3 feet).
- An 8" lodgepole pine with open blaze and visible scribe, bears N78¼°W, 11.02 feet distant, with existing bearing tree tag (S76¼°E, 18 links - 11.88 feet).
- A 6" lodgepole pine snag with visible scribe, bears S80°W, 16.5 feet distant, with existing bearing tree tag (N80°E, 25 links - 16.5 feet).
- An 8" lodgepole pine with open blaze and visible scribe, bears S64¼°E, 3.1 feet distant, with existing bearing tree tag (N56°W, 5½ links - 3.63 feet).

Bearing trees were painted red. No new BT tags were attached.

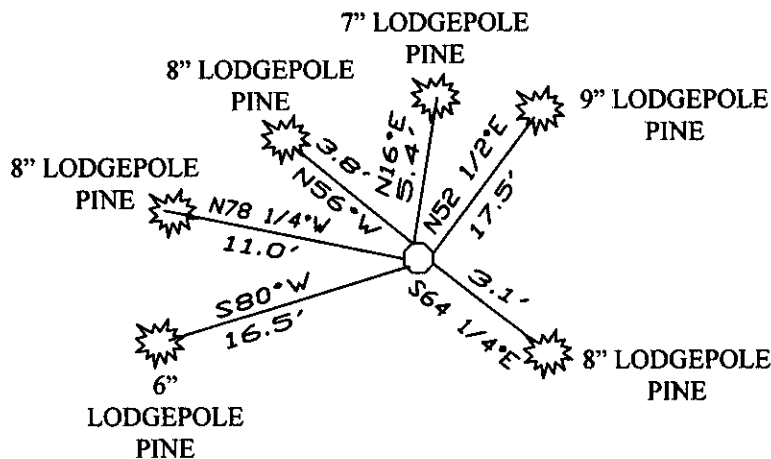
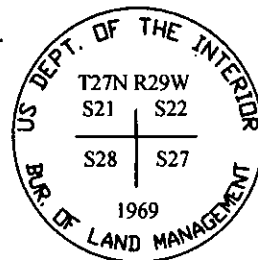

SKETCH OF CORNER

## CERTIFICATION

I, Stephen Jeske  
Certify the information shown herein is true and correct.

Stephen Jeske  
Signature Ground Party Chief

I, Stephen Jeske  
certify that this Corner Record correctly represents work performed by me or under my direction in compliance with the "Corner Record Act" (70-22-701, et seq., M.C.A.)

Stephen Jeske  
Signature of Surveyor & Seal

Date: 7-15-2008 Reg. No. 14230

Employer: J.R.S. Surveying, Inc.

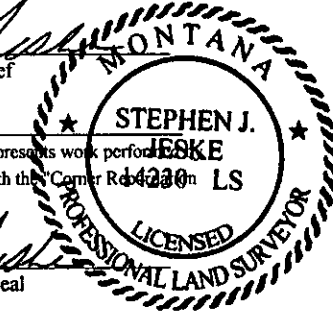

Office of Clerk and Recorder, County of

record" was filed for record on

was noted on the cross-index plat and

book no. \_\_\_\_\_

This "corner  
213149 BOOK: CCR CC&R'S PAGE: 11251 Pages: 1

STATE OF MONTANA LINCOLN COUNTY

RECORDED: 07/28/2008 12:00 KOI: CC&R'S

TAMMY D. LAUER CLERK AND RECORDER

FEE: \$0.00

BY: Francis D. Lauer

TO: J.R.S. SURVEYING P.O. BOX 1050, LIBBY, MONTANA 59923

County Official

Cross Index No. R13 T. 27N R. 29W PMM