

# CERTIFIED CORNER RECORDATION

Corner SE Cor. S24 T 27 N. R. 29 W. P.M.M. Lincoln County

I. Record: 1902 original GLO survey by Burton S. Adams and William Weeks: Set a lime stone 18x12x5 ins. 12 ins. in the ground, marked with 2 notches on S, and 4 notches on N edge from which:

A pine, 10 ins. diam., bears S.16°45'W., 39 lks. dist., (25.74 ft.), mkd.T27N R29W S25 BT.  
A tamarack, 18 ins. diam., bears N.76°30'W., 37 lks. dist., (24.42 ft.), mkd. T27N R29W S24 BT.

1966 BLM Remonumentation by R. Leedy: Set a iron post, 30 ins. long, 2 1/2 ins. diam., 24 ins. in the ground from which:

A pine snag, 8 ins. diam., bears N.16°30'W., 39 lks. dist., (25.74 ft) with visible scribing.  
A larch, 24 ins. diam., bears N.74°15'W., 37 lks. dist., (24.42 ft) with visible scribing.  
A fir, 10 ins. diam., bears S.44°30'W., 28 lks. dist., (18.48 ft.) mkd. T27N R28 S25 BT.

II. Found: A 3 1/4 ins. diam., BLM brass cap on a 2 1/2 ins. diam. iron pipe firmly set from which:

A larch snag, 24 ins. diam., bears N.74°W., 24.50 ft. dist. with visible scribes.  
A fir stump, 15 ins. diam., bears S.38°W., 19.60 ft. dist., with overgrown face.

III. Perpetuation: We establish 2 new bearing tree described below:

A fir, 6 ins. diam., bears S.1°W., 5.65 ft. dist., scribed X BT.  
A fir, 12 ins. diam., bears N.24°W., 9.70 ft. dist., mkd. T27N R29W S24 BT.

Painted faces and 6 in. wide red bands to all bearing trees and attached Land Survey Monument and Bearing Tree signs.

Magnetic declination: 18° East

Equipment used: Hand compass and loggers tape

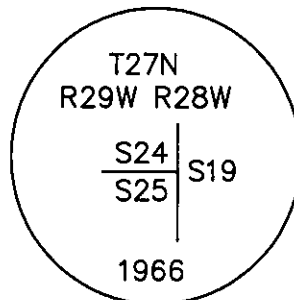

Kootenai Surveyors Inc., 314 California Av., Libby, MT. 59923 (406) 293-4354

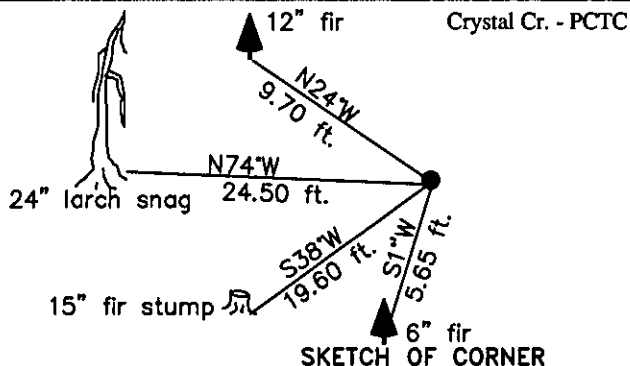

CERTIFICATION  
I, Levi Powell  
certify the information shown here is true and correct.  
Levi Powell  
Signature Ground Party Chief  
I, Alvah F. Hughes  
certify that this Corner Record correctly represents work performed by me or under my direction in compliance with the "Corner Recordation Act" (70-22-101, et seq., M.C.A.)  
Alvah F. Hughes  
Signature of Surveyor & Seal  
Date: 6/30/2008 Reg. No. 7322-LS  
Employer: Kootenai Surveyors Inc.

Office of Clerk and Recorder, County of Lincoln This "corner

Sec. 24

record" was file 213031 BOOK: CCR CC&R'S PAGE: 11239 Pages: 1

was noted on STATE OF MONTANA LINCOLN COUNTY

RECORDED: 07/23/2008 9:34 KOI: CC&R'S

book No. TAMMY D. LAUER CLERK AND RECORDER

FEE: \$0.00

BY: Levi Powell  
TO: KOOTENAI SURVEYORS INC. P.O. BOX 393, LIBBY, MT 59923

Cross Index No. R 25 T. 27N R. 29W P.M., MT

Adopted July 1, 1981, Montana Board of Professional Engineers & Land Surveyors

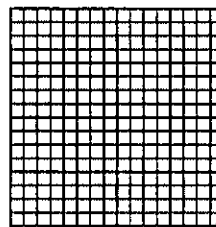

• corner this sheet