

CERTIFIED CORNER RECORDATION

Corner Cor. 4 MS 6231 T. 27 N. R. 29 W. P.M.M. LINCOLN County

I. Record: 1901 Mineral survey by Nimrod Jenkins: Set a post 4 1/2 ins. square 4 feet long, 2 feet deep marked 4-6231 for cor. No. 4.

A Tamarack, 12 ins. diam. bears N. 55°W. 18 ft. dist. marked 4-6231 BT.  
A Tamarack, 20 ins. diam. bears S. 25°E., 14.50 ft. dist. marked 4-6231 BT.

II. Found: A search of the area, no accesories or original wood post were found.

III. Perpetuation: At the corner point, determined by survey, Set an 5/8 ins. diam. steel rebar, 24 ins. long, 21 ins. in the ground, with a 3 1/4 ins. diam. cap marked as shown below from which:

A Larch, 9 ins. diam., bears N.73°E., 14.60 ft. dist., scribed 4 MS 6231 BT.

A fir, 5 ins. diam., bears S.22°E., 34.40 ft. dist., scribed 4 MS 6231 BT.

Painted scribed faces red and 6 in. wide bands around BT's and attached Bearing Tree and Land Survey Monument signs.

Magnetic declination: 18° East

Equipment used: Hand compass and loggers tape

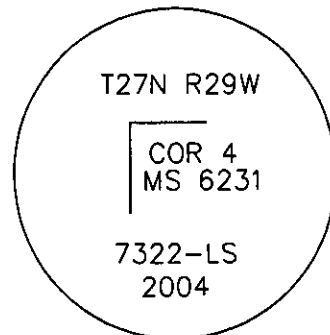

Kootenai Surveyors Inc., 314 California Av., Libby, MT. 59923 (406) 293-4354

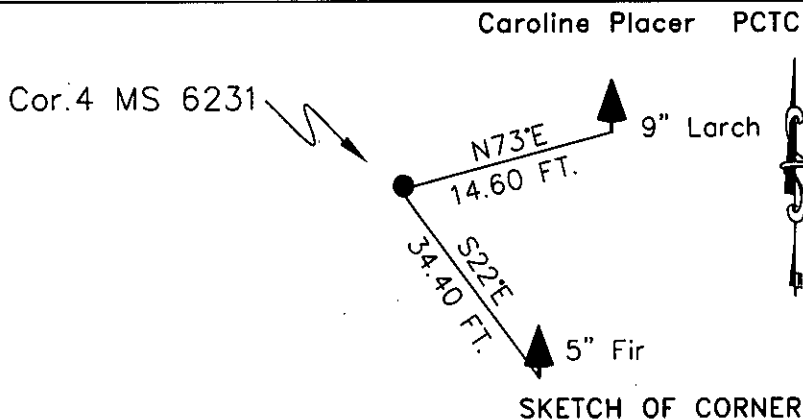

CERTIFICATION

I, Kenneth Kern  
certify the information shown herein is true and correct.  
Kenneth Kern  
Signature Ground Party Chief

I, Alvah F. Hughes  
certify that this Corner Record correctly represents work performed by me or under my direction in compliance with the "Corner Recordation Act" (70-22-101 et seq., M.C.A.)  
Alvah F. Hughes  
Signature of Surveyor & Seal  
7322 LS  
Date: 6/21/2006 Reg. No. 7322 LS  
Employer: Kootenai Surveyors Inc.

Office of Clerk and Recorder, County of Lincoln. This "corner

record" was filed for record on 195367 BOOK: CCR CC&R'S PAGE: 10943 Pages: 1

was noted on the cross-index STATE OF MONTANA LINCOLN COUNTY  
book No. RECORDED: 07/05/2006 4:30 KOI: CC&R'S

CORAL M. CUMMINGS CLERK AND RECORDER

FEE: \$0.00

BY: [Signature]

TO: KOOTENAI SURVEYORS INC. P.O. BOX 393, LIBBY, MT 59923

Cross Index No. 27N. R. 29W. P.M., MT

Adopted July 1, 1981, Montana Board of Professional Engineers & Land Surveyors

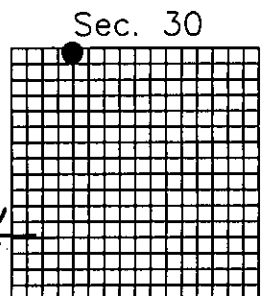

• corner this sheet