

CERTIFIED CORNER RECORDATION

Corner Cor. 1 MS 6230 T 27N. R. 29 W. P.M.M. LINCOLN County

I. Record: 1901 Mineral survey by Nimrod Jenkins: Set a post 4 1/2 ins. square 4 ft. long 2 ft. deep, marked 1-6230 from which:

A blazed fir, 14 ins. diam., bears N.15°W., 24.00 ft. dist., marked 1-6230 BT.
A blazed tamarack, 20 ins. diam., bears S5°W., 6.60 ft. dist., marked 1-6230 BT.

II. Found: No evidence of original wood post monument found.

A Douglas fir stump, 24 ins. diam. bears N. 15°W., 24.00 ft. dist. with visible scribing.
A larch snag, 24 ins. diam., bears S.5°W., 6.60 ft. dist., with visible scribing.

III. Perpetuation: From the original bearing trees, a distance distance tie, set a aluminum pipe 2 1/2 ins. diam., 30 ins. long 24 ins. in the ground, with a 3 1/4 in. diam. aluminum cap marked as shown below from which:

A Alpine fir, 9 ins. diam., bears N.14°W., 22.90 ft. dist., scribed 1 MS 6230 BT
A Alpine fir, 9 ins. diam., bears N.86°30'W., 45.50 ft. dist., scribed 1 MS 6230 BT.

Painted scribed faces red and 6 in. wide bands around the bearing trees and attached Bearing Tree and Land Survey Monument signs.

Raise a collar of stone 2 ft. diam. around the set monument.

Set a steel post 1 ft. N. of set corner.

Note: all measurements are from the face of discribed Bearing trees.

Magnetic declination: 18° East

Equipment used: Hand compass and loggers tape

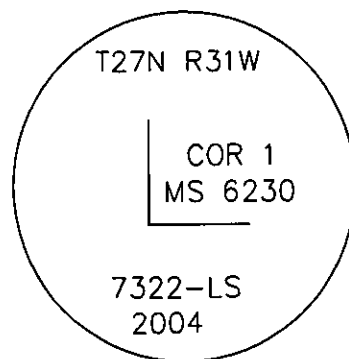

Kootenai Surveyors Inc., 314 California Av., Libby, MT. 59923 (406) 293-4354

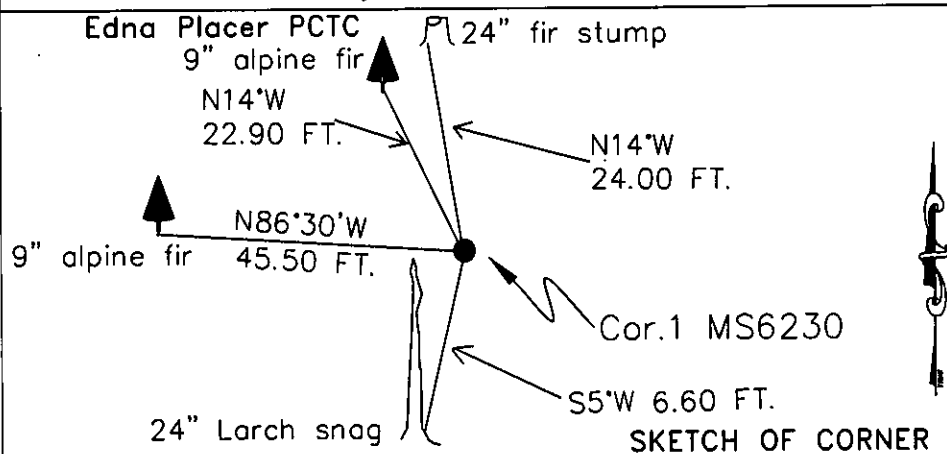

CERTIFICATION
I, John Damon
certify the information shown herein is true and correct.
John Damon
Signature Ground Party Chief
I, Alvah F. Hughes
certify that this Corner Record correctly represents work performed by me or under my direction in compliance with the "Corner Recordation Act" (70-22-101, et seq., M.C.A.)
Alvah F. Hughes
Signature of Surveyor & Seal ALVAH F. HUGHES
Date: 6/21/2006 Reg. No. 23227 LS
Employer: Kootenai Surveyors, Inc.

Office of Clerk and Recorder, County of Lincoln. This "corner

record" was filed for record 195364 BOOK: CCR CC&R'S PAGE: 10940 Pages: 1

was noted on the cross-index STATE OF MONTANA LINCOLN COUNTY

book No. RECORDED: 07/05/2006 4:15 KOI: CC&R'S

CORAL M. CUMMINGS CLERK AND RECORDER

FEE: \$0.00

BY:

TO: KOOTENAI SURVEYORS INC. P.O. BOX 393, LIBBY, MT 59923

Cross Index No. T. 27N. R. 29W. P.M., MT

Adopted July 1, 1981, Montana Board of Professional Engineers & Land Surveyors

Sec. 30

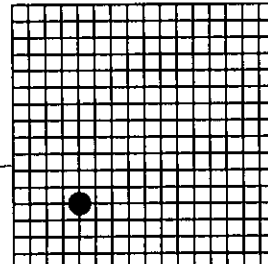

• corner this sheet