

CERTIFIED CORNER RECORDATION

CORNER N 1/4 Cor. S 13 T. 27 N., R. 29 W., P.M.M. LINCOLN COUNTY

RECORD:

1903 original GLO notes by William K. Trippet

"Set a lime stone, 16 x 8 x 6 ins., 11 ins. in the ground, for 1/4 sec. cor., marked 1/4 on N. face; from which

A Fir, 12 ins. in diam., bears S. 82° E., 58 lks, dist., marked 1/4 S 13 BT.

A Tamarack bears N 64° W, 13 lks. dist."

FOUND EVIDENCE:

Found original stone with (2) BT's

A original Tamarack, 10 ins. diam., S 12 BT bears N. 64° W., 38.2 ft. dist.

A Alpine Fir, 9 ins. diam., scribed T 27 N R 29 W S 13 BT bears S. 82° E., 8.5 ft. dist.

PERPETUATION:

Replaced original stone with a 3 1/4 inch aluminum cap stamped (see diagram below) on a 5/8 inch dia. rebar 30 inches long. From which:

Found bearing trees were in good condition used them for bearing trees.

Painted 6 inch wide band with attached bearing tree signs to all trees.

MAGNETIC DECLINATION: 18° E

10" Tamarack

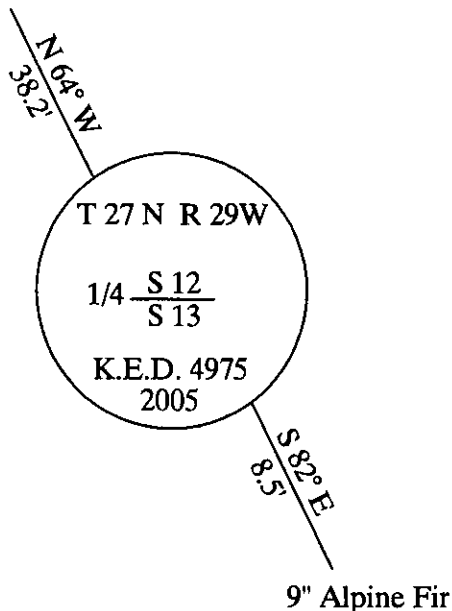

CERTIFICATION

I, GEORGE CLARK

Certify the information shown herein is true and correct

Signature of Ground Party Chief

I, KENNETH E. DAVIS

certify that the above Record correctly represents work performed by me or under my direction in compliance with the

Corner Recordation Act

79-32-101, G.S.M.C.

KENNETH E. DAVIS

Signature of Surveyor & Seal

License No. 4975-S

Employer Surveyor's Surveying & Real Estate Co.

SKETCH OF CORNER

SECTION

Office of Clerk and Recorder, County of _____

This "corner record" 187823 BOOK: CCR CC&R'S PAGE: 10841 Pages: 1

was noted on the c: STATE OF MONTANA LINCOLN COUNTY

No. _____ RECORDED: 09/09/2005 9:32 KOI: CC&R'S

In book No. _____ CORAL M. CUMMINGS CLERK AND RECORDER

FEE: \$0.00

BY: George Clark

TO: FILED

Cross Index No. _____ T. _____ N., R. _____ W., P.M.M.

THIS CORNER

