

CERTIFIED CORNER RECORDATION

Corner SW Cor. Sec. 30 T 27 N. R. 29 W. P.M.M. LINCOLN County

I. Record: 1900 GLO survey by Burton Adams :Set a limestone 20x8x4 ins., 15 ins. in the ground, marked with 1 notch on S. and 5 notches on N. edges, from which:

- A fir, 4 ins. diam., bears N.2°15'E., 32 lks. dist. (21.12 ft.), mkd. T27N R29W S30 BT.
- A fir, 16 ins. diam., bears S.14°30'E., 118 lks. dist. (77.88 ft.), mkd. T27N R29W S31 BT.
- A pine, 14 ins. diam., bears S.48°45'W., 41 lks. dist. (27.06 ft.), mkd. T27N R30W S36 BT.
- A pine, 12 ins. diam., bears N.87°W., 75 lks. dist. (49.50 ft.), mkd. T27N R30W S25 BT.

II. Found: A 3/4 in. diam. steel pipe (unrecorded).

- A fir, 12 ins. diam., bears N.2°15'E., 21.12 ft. dist., with overgrown face.
- A pine stump, 18 ins. diam., bears N.87°W., 49.50 ft. dist., with visible scribes.

III. Perpetuation: At the position from a distance distance tie from existing found bearing trees, set a aluminum pipe 2 1/2 ins. diam. 30 ins. long 24 ins. in the ground, with a 3 1/4 in. diam. aluminum cap marked as shown below from which :

- A fir, 11 ins. diam., bears S.33°E., 31.60 ft. dist., scribed T27N R29W S31 BT.
- A fir, 18 ins. diam., bears S.23°W., 34.30 ft. dist., scribed T27N R30W S36 BT.
- A fir, 10 ins. diam., bears N.76°W., 36.40 ft. dist., scribed T27N R30W S25 BT.

Painted faces and 6 in. wide red bands around BT's and attached Bearing Tree and Land Survey Monument signs.

Raise a collar of stone 2 ft. diam. around the set monument.

Magnetic declination: 18° East assumed

Equipment used: Hand compass and loggers tape

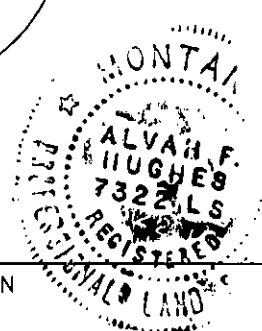
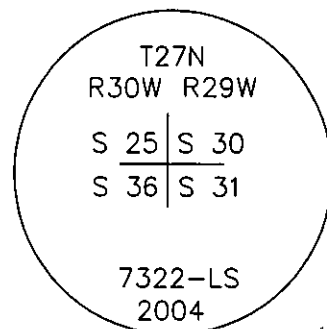

Kootenai Surveyors Inc., 314 California Av., Libby, MT. 59923 (406) 293-4354

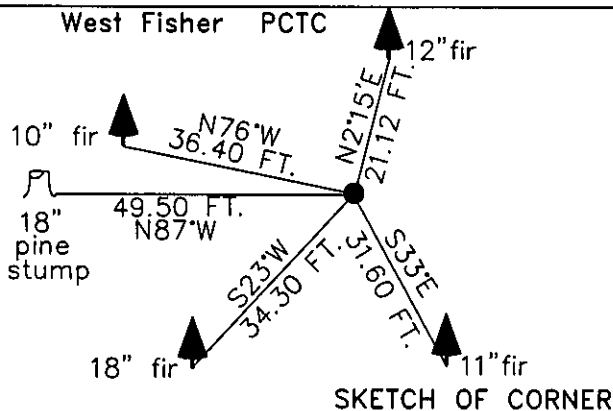

SKETCH OF CORNER

CERTIFICATION
I, Pete Landis
certify the information shown herein is true and correct.
Pete Landis
Signature Ground Party Chief
I, Alvan F. Hughes
certify that this Corner Record correctly represents work performed by me or under my direction in compliance with the "Corner Recordation Act" (70-22-101, et seq., M.C.A.)
Alvan F. Hughes
Signature of Surveyor & Seal
Date: 12/9/2004 Reg. No. 7322-LS
Employer: Kootenai Surveyors Inc.

Office of Clerk and Recorder, County of Lincoln This "corner

record" was filed for rec 181349 BOOK: CCR CCR'S PAGE: 10745 Pages: 1
was noted on the cross-
book No. STATE OF MONTANA LINCOLN COUNTY
RECORDED: 12/17/2004 9:30 KOI: CCR'S
CORAL M. CUMMINGS CLERK AND RECORDER
FEE: \$0.00 BY: *Jeanie Harris*
Deputy

Cross Index No. V1 T. 27N. R. 29W. P.M., MT

Adopted July 1, 1981, Montana Board of Professional Engineers & Land Surveyors

Sec. 30

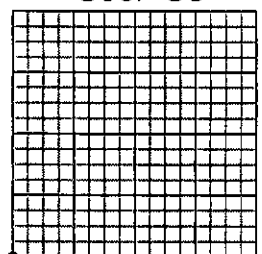

• corner this sheet