

CERTIFIED CORNER RECORDATION

Corner S35 Sec. CC S2|S1 T. 27 N., R. 29 W., P.M.M. Lincoln County

Record :

1911 GLO Township Subdivisions by Govt. Surveyor W.C. Perkins.

"Set a limestone, 16x12x4 ins., 11 ins. in the ground, for closing cor. of Secs 1 and 2, marked CC on S. face, with 5 grooves on W. and 1 groove on E. face; from which:

A pine, 4 ins. in diam., bears S 37° E, 11 lks. dist., marked T27N R29W S1 BT.
A pine, 6 ins. in diam., bears S 66° E, 9 lks. dist., marked T27N R29W S2 BT."

1966 BLM Remonumentation by Govt. Surveyors Damm, French and Lindenberg.

"At a corner point, set an iron post, 30 ins. long, 2 1/2 ins. diam., 24 ins. in the ground, with brass cap, from which:

A Pine, 7 ins. diam., bears S 41 1/2° E, 11 lks. dist., marked T27N R29W S1 CC BT.
A Pine, 7 ins. diam., bears S 66° W, 9 lks. dist., marked T27N R29W S2 CC BT.

Bury the original stone alongside the iron post."

Found Evidence :

A 2 1/2 in. diam. iron pipe, 6 ins. above ground with a 3 1/4 in. diam. brass cap marked as shown below. The original Bearing Trees described in both previous surveys are pine snags with visible scribing that have fallen over on the steep sidehill.

Perpetuation :

We established two new Bearing Trees described as follows:

A Douglas Fir, 10 1/2 ins. diam., bears S 63° W, 12.90 ft. dist., scribed "T27N R29W S2 CC BT."
A Douglas Fir, 11 ins. diam., bears S 61° E, 22.10 ft. dist., scribed "T27N R29W S1 CC BT."

Paint 6 inch wide bands and scribed faces red on both Bearing Trees.

Attached Bearing Tree and Land Survey Monument signs to both trees.

Set a 6 ft. long steel post 2 ft. in the ground with attached Land Survey Monument and Property Line decals S. 3.00 ft. dist. on line.



Magnetic Declination: 18° East

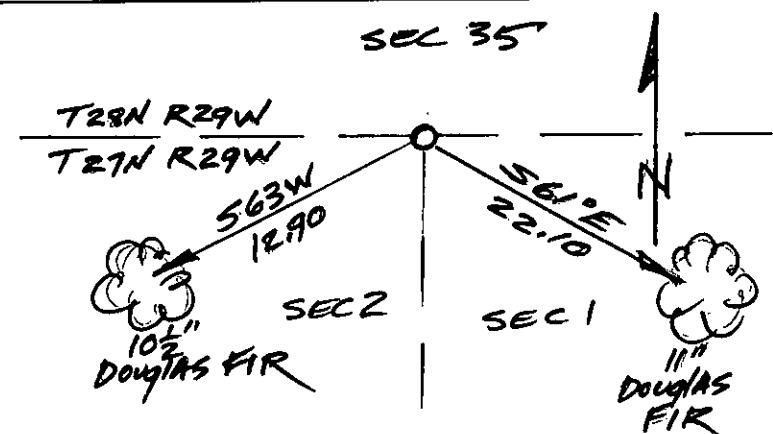

Sketch of Corner

CERTIFICATION

I, John Damon

certify the information shown herein is true and correct

Signature of Ground Party Chief

I, Ken E. Davis

certify that this Corner Record correctly represents work performed by me or under my direction in compliance with the "Corner Recordation Act" (70-22-101, et seq., M.C.A.)

Signature of Surveyor & Seal

Date: 9/29/98

Reg. No. 4975 S

Employer: Davis Surveying, Inc.

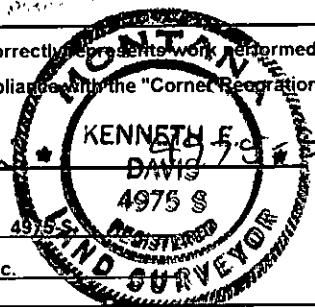

Office of Clerk and Recorder, County of Lincoln

This "corner record" was filed for record on 10-6-98

was noted on the cross-index plat and is assigned page No. 10214

in book No. Coral M. Cumming By Deb

County Official

Section

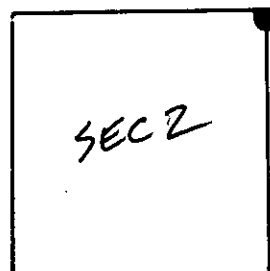

Cross Index No. S35 Sec. CC S1|S2 T. 27 N., R. 29 W., PMM • THIS CORNER