

## INSTRUCTIONS

1. Original and/or subsequent record used to evaluate the corner position.
2. Description of evidence found, note discrepancies in the record, state method of establishing lost or obliterated corners.
3. Description of monument and accessories set to perpetuate the corner position.
4. Sketch of corner, show all pertinent data which can best be shown in a sketch example, corner marking, topography ties, position of accessories, etc.
5. Certification must be signed and sealed by Land Surveyor registered in the State of Montana.
6. Fill in Cross Index & Section Diagram at bottom of sheet.

## CERTIFIED CORNER RECORDATION

Corner S21  $\frac{1}{4}$  S22 T. 27 N R. 28 W P.M.M. LINCOLN County

ORIGINAL AND/OR  
SUBSEQUENT RECORD

ORIGINAL RECORD: Set a Lime Stone, 15"x8"x6", 10" in the ground, marked  $\frac{1}{4}$  on W face;

From Which:

A fir 6" in diam. bears N68°30'E, 55 lks. dist. marked  $\frac{1}{4}$  S22 B.T.

A fir 16" in diam. bears N41°15'W, 23 lks. dist. marked  $\frac{1}{4}$  S21 B.T.

## EVIDENCE FOUND

Original Stone Not Found. Found original BT a 12" D. Fir with grown over blaze and BLM BT sign bears N 68° 30' E 36.3'.

## PERPETUATION

Set  $3\frac{1}{4}$ " Alum. Cap on  $3\frac{1}{4}$ " x 24" Rebar from Original BT. Established New RM Tree a 8" D. Fir bears N16°W, 28', Blazed, Painted and Tagged with MARLS Land Monument Sign.

Note: Declination used -18°E

Measurements taken to Center of Tree.

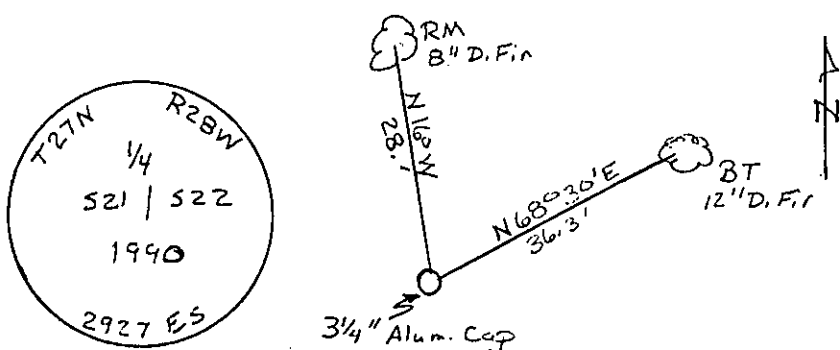

SKETCH OF CORNER

## CERTIFICATION

I, Rod Cone  
certify the information shown herein is true and correct.

Signature Ground Party Chief

TERRY L. DRUYVESTEIN

I, TERRY L. DRUYVESTEIN  
certify that this Corner Record correctly represents work performed by me or under my direction in compliance with the "Corner Recordation Act" (40-22-101, et seq., M.C.A.)

Signature of Surveyor Seal

Date: 02/90 Reg. No. 2927ES

Employer: STENSATTER DRUYVESTEIN & ASSOCIATES, INC.

Sec. 22

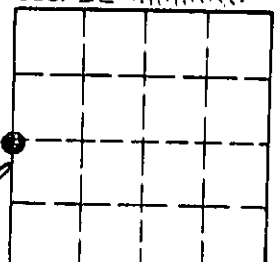

Office of Clerk and Recorder, County of Lincoln. This "corner record" was filed for record on 1-4-91

was noted on the cross-index plat and is assigned page No. 4440, in book No.                     

Janet E. Sigel by Bill Buckner  
County Official

Cross Index No. P-13 T. 27 N R. 28 W P.M.M.

• corner this sheet