

INSTRUCTIONS

1. Original and/or subsequent record used to evaluate the corner position.
2. Description of evidence found, note discrepancies in the record, state method of establishing lost or obliterated corners.
3. Description of monument and accessories set to perpetuate the corner position.
4. Sketch of corner, show all pertinent data which can best be shown in a sketch example, corner marking, topography ties, position of accessories, etc.
5. Certification must be signed and sealed by Land Surveyor registered in the State of Montana.
6. Fill in Cross Index & Section Diagram at bottom of sheet.

CERTIFIED CORNER RECORDATION

Corner M.C. $\frac{S24}{S25}$ West Side T. 27 N R. 28 W P.M.M. LINCOLN County

ORIGINAL AND/OR SUBSEQUENT RECORD

ORIGINAL RECORD: Set a Lime Stone 18" x 12" x 6", 12" in the ground, marked M.C. on E face, with 2 grooves on S face;
 From Which:
 A pine 15" in diam. bears S44°W, 94 lks. dist. mkd. T27N R28W S25 M.C. B.T.
 A pine 24" in diam. bears S36°30'W 90 lks. dist. mkd. T27N R28W S24 M.C. B.T.

EVIDENCE FOUND

Original Stone Not Found. Found Original BT bears S44°W, 62.0'

PERPETUATION

Set 1 1/2" Alum. Cap from record Bearing and Distance from remaining BT. Mounded monument with stone and set a 5' Steel Fence Post at approximately 1' East of Monument. Established one New RM a 7"D. Fir bears S13°W, 40.1' with MARLS Land Monument Sign. Both RM and BT Trees Painted with Red Band around them.

Note: Declination used - 20°E
 Measurements taken to Center of tree

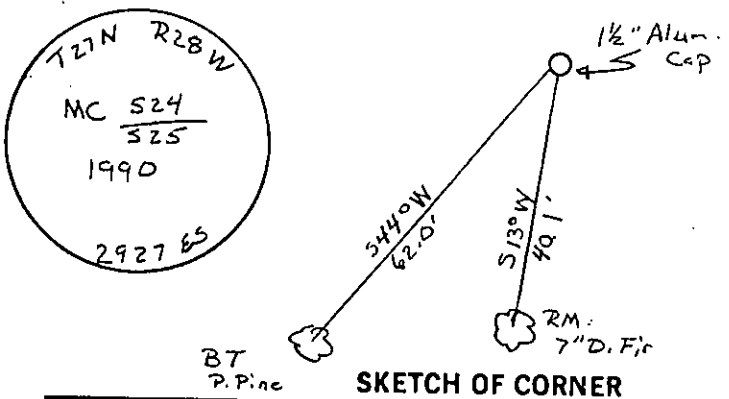

CERTIFICATION

I, Glenn R. Howard
 certify the information shown herein is true and correct.

Glenn R. Howard
 Signature Ground Party Chief

I, TERRY L. DRUYVESTEIN
 certify that this Corner Record correctly represents work performed by me or under my direction in compliance with the Corner Recordation Act (70-22-101, et seq., M.C.A.)

Terry L. Druyvestein
 Signature of Surveyor & Seal

Date: 07/90 Reg. No. 2927ES

Employer: STENSATTER DRUYVESTEIN & ASSOCIATES

MONTANA REGISTERED SURVEYOR

Office of Clerk and Recorder, County of Lincoln. This "corner record" was filed for record on 1-4-91 was noted on the cross-index plat and is assigned page No. 4435, in book No. _____

Janet H. Sugil by Bill Gault
 County Official

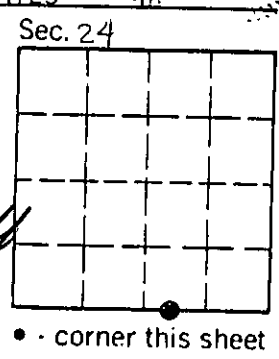

Cross Index No. R-23-24 T. 27 N R. 28 W P.M.M.