

INSTRUCTIONS

1. Original and/or subsequent record used to evaluate the corner position.
2. Description of evidence found, note discrepancies in the record, state method of establishing lost or obliterated corners.
3. Description of monument and accessories set to perpetuate the corner position.
4. Sketch of corner, show all pertinent data which can best be shown in a sketch example, corner marking, topography ties, position of accessories, etc.
5. Certification must be signed and sealed by Land Surveyor registered in the State of Montana.
6. Fill in Cross Index & Section Diagram at bottom of sheet.

CERTIFIED CORNER RECORDATION

Corner N 1/4 Sec 27 / Sec 28 T. 27 N R. 28 W P.M.M. LINCOLN County

ORIGINAL AND/OR  
SUBSEQUENT RECORD None

EVIDENCE FOUND - 3/4" Steel Rod.

PERPETUATION Set 1 1/2" Alum. Cap on 5/8" x 24" Rebar. Established Two RM Trees.  
An 15" D. Fir bears N69°E, 27.7' with J. Niel Lum. Co Tag 1975.  
An 20" D. Fir bears S45°W, 15.3' with J. Niel Lum. Co. Tag 1975.

Note: Declination used - 20°E  
 Measurements taken to center of tree.

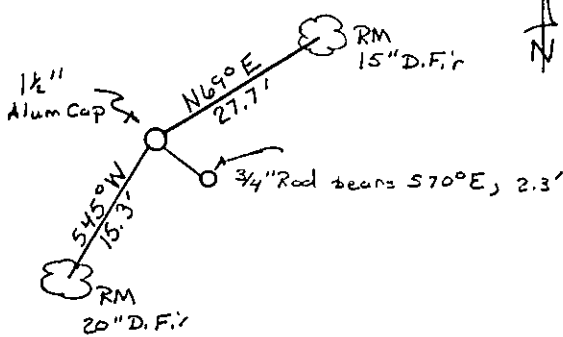
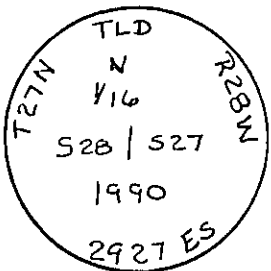

SKETCH OF CORNER

CERTIFICATION

1. Glenn R. Howard  
 certify the information shown herein is true and correct.

Glenn R. Howard  
 Signature Ground Party Chief

1. TERRY L. DRUYVESTEIN

certify that this Corner Record correctly represents work performed by me or under my direction in compliance with the "Corner Recordation Act" (70-22-101, et seq., M.C.A.)

Terry L. Druyvestein  
 Signature of Surveyor & Seal

Date: 07/90 Reg. No. 2927 ES

Employer: STENSATTER DRUYVESTEIN & ASSOCIATES

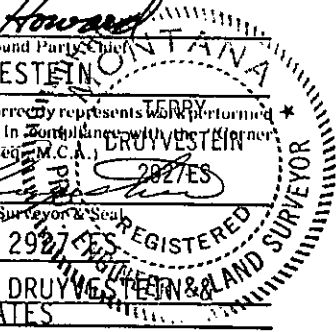

Office of Clerk and Recorder, County of Lincoln. This "corner record" was filed for record on 1-4-91 was noted on the cross-index plat and is assigned page No. 4429 in book No. \_\_\_\_\_

Janet R. Siegel by Bill Buschhoff  
 County Official

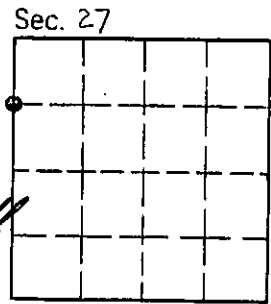

Cross Index No. S-13 T. 27N R. 28W P.M.M.

• corner this sheet