

CERTIFIED CORNER RECORDATION

CORNER CS 1/16 SEC.15 T. 27N , R. 28W , P.M.M., LINCOLN COUNTY

RECORD: NONE

FOUND: NOTHING

MAINTENANCE: SET 5/8"x24" REBAR WITH YPC STAMPED AS SHOWN, FROM WHICH;
 5" PINE BEARS N38°W, 22.90' SCRIBED RM.
 SET STEEL POSTS 1 FOOT NORTH AND 1 FOOT WEST OF CORNER.
 PAINTED RED BAND AND BLAZE ON BT.

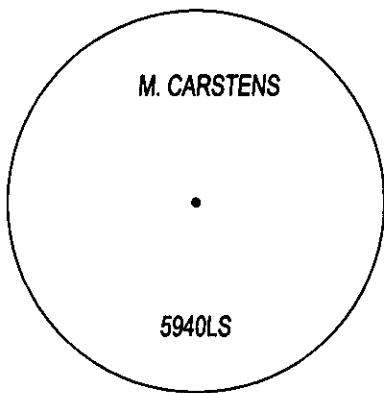
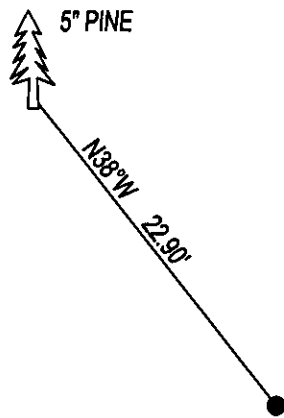

SKETCH OF CORNER

CERTIFICATION

I, DAN CROFT
 CERTIFY THE INFORMATION SHOWN HEREIN IS TRUE AND CORRECT.

SIGNATURE GROUND PARTY CHIEF

I, MARC J. CARSTENS
 CERTIFY THAT THIS CORNER RECORD CORRECTLY REPRESENTS WORK
 PERFORMED BY ME OR UNDER MY DIRECTION IN COMPLIANCE WITH THE
 "CORNER RECORDATION ACT" (70-22-101, ET SEQ., M.C.A.)

 SIGNATURE OF SURVEYOR & SEAL

03-21-14
 DATE
CARSTENS SURVEYING
 EMPLOYER

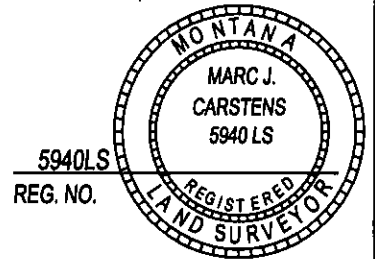

OFFICE OF CLERK AND RECORDER COUNTY OF LINCOLN
 THIS "CORNER RECORD" WAS FILED 250576 BOOK: CCR CC&R'S PAGE: 12110 Pages: 1
 WA: STATE OF MONTANA LINCOLN COUNTY
 AND IS ASSIGNED PAGE NO. RECORDED: 03/24/2014 11:55 KOI: CC&R'S
 COUNTY OFFICIAL TAMMY D. LAUER CLERK AND RECORDER
 FEE: \$0.00 BY *Francis Deunne*
 FOR: CARSTENS LAND SURVEYING P.O. BOX 1374, POLSON, MONTANA

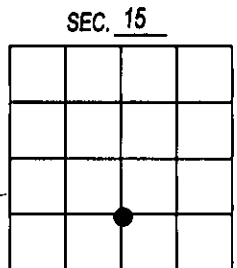

CROSS INDEX NO. M-15 T. 27N , R. 28W , P.M.M.
 ADOPTED JULY 1, 1981, MONTANA BOARD OF PROFESSIONAL ENGINEERS & LAND SURVEYORS

● CORNER THIS SHEET