

CERTIFIED CORNER RECORDATION

CORNER E1/4 CORNER SEC.15 T. 27N , R. 28W , P.M.M., LINCOLN COUNTY

FOUND: 3 1/4' ALUM CAP STAMPED AS SHOWN FROM WHICH;
11" FIR WITH TAGS BEARS N85°E 27.70' WITH SCRIBING.
15" FIR WITH TAGS BEARS S28°W 33.60' WITH PITCHEDOVER SCRIBE.
8" PINE WITH TAGS BEARS N30°W 44.50' WITH SCRIBING.

MAINTENANCE: REMOVED BRUSH AND TREE LIMBS
PAINTED RED BAND AND BLAZE ON BT.

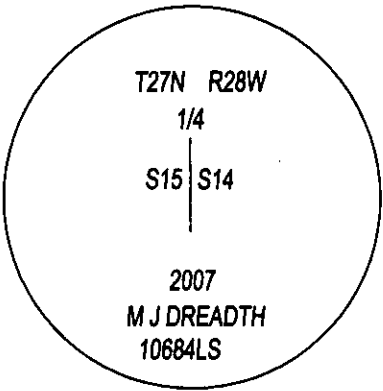
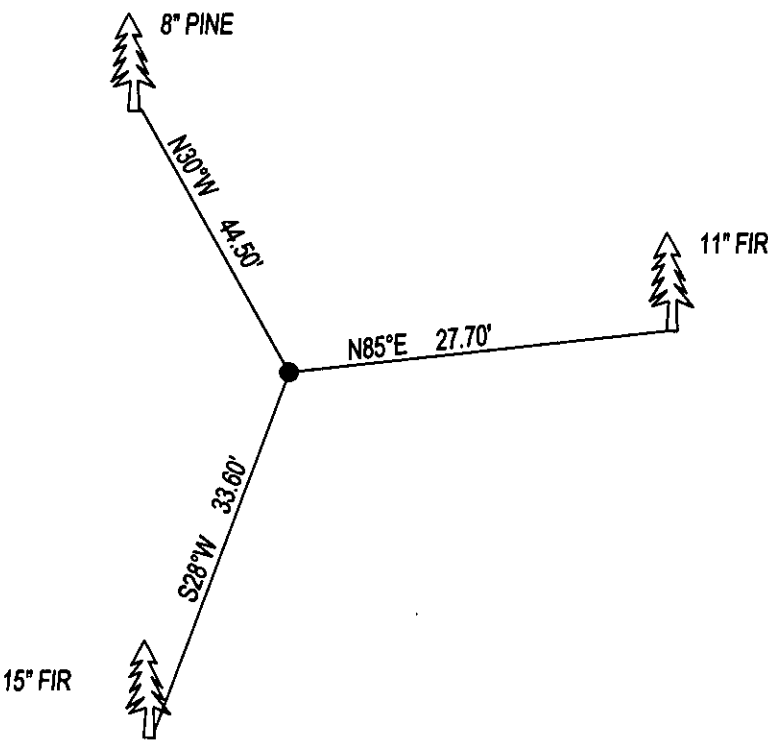

SKETCH OF CORNER

CERTIFICATION

I, DAN CROFT
CERTIFY THE INFORMATION SHOWN HEREIN IS TRUE AND CORRECT.

SIGNATURE GROUND PARTY CHIEF
I, MARC J. CARSTENS
CERTIFY THAT THIS CORNER RECORD CORRECTLY REPRESENTS WORK
PERFORMED BY ME OR UNDER MY DIRECTION IN COMPLIANCE WITH THE
"CORNER RECORDATION ACT" (70-22-101, ET SEQ., M.C.A.)

SIGNATURE OF SURVEYOR & SEAL
03-21-14
DATE
CARSTENS SURVEYING
EMPLOYER

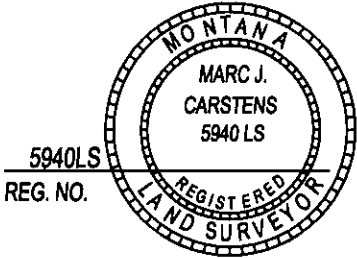

OFFICE OF CLERK AND RECORDER, COUNTY OF LINCOLN
THIS "CORNER RECORD" WAS FILED 250568 BOOK: CCR CC&R'S PAGE: 12102 Pages: 1
WAS N STATE OF MONTANA LINCOLN COUNTY
AND IS ASSIGNED PAGE NO. RECORDED: 03/24/2014 11:15 KOI: CC&R'S
TAMMY D. LAUER CLERK AND RECORDER
FEE: \$0.00 BY:
COUNTY OFFICIAL FOR: CARSTENS LAND SURVEYING P.O. BOX 1374, POLSON, MONTANA
CROSS INDEX NO. L-17 T. 27N , R. 28W , P.M.M.
ADOPTED JULY 1, 1981, MONTANA BOARD OF PROFESSIONAL ENGINEERS & LAND SURVEYORS

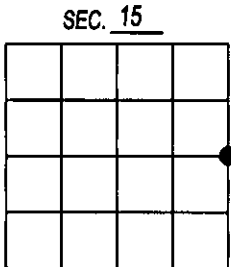

● CORNER THIS SHEET