

CERTIFIED CORNER RECORDATION

Corner N1/16 Cor. S20 T. 27 N. R. 28 W. P.M.M. Lincoln County

- I. Record: 1902 original GLO Subdivision of Township 27 North, Range 28 West by Burton S. Adams and William Weeks.
- II. Found: A field search found no monuments.
- III. Perpetuation: At the corner point, determined by survey, set a 5/8 inch diam. steel rebar 24 ins. long, 23 ins. in the ground, with a 3 1/4 inch diam. Aluminum cap marked as shown below from which:

A fir, 12 ins. diam., bears N.60°E., 14.40 ft. dist., scribed N 1/16 S21 BT.  
A fir, 11 ins. diam., bears N.35°W., 48.90 ft. dist., scribed N 1/16 S20 BT.  
A 6 ft. steel post, bears North on line 2.10 ft. dist.  
A 6 ft. steel post, bears West on line 2.40 ft. dist.  
Attach Survey Monument and Property Line stickers to both witness posts.

Painted faces and 6 in. wide red bands to all bearing trees and attached Land Survey Monument and Bearing Tree signs.

Magnetic declination: 18° East

Equipment used: Hand compass and loggers tape

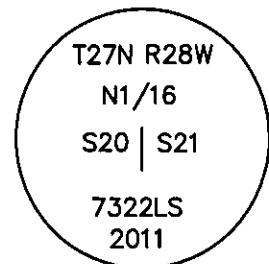

Note: Refer to Certificate of Survey No. 4106 Lincoln County Records for additional survey information.

Kootenai Surveyors Inc., 314 California Av., Libby, MT. 59923 (406) 293-4354

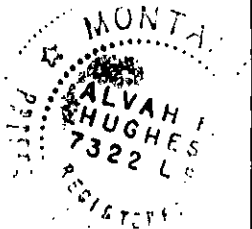

Lower Fritz - PCTC

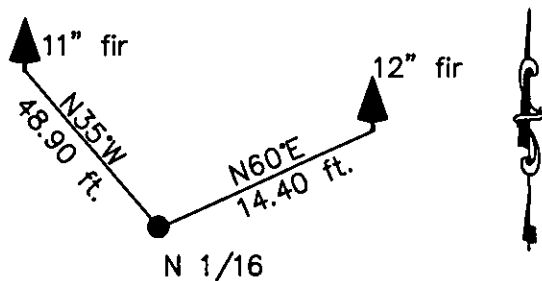

SKETCH OF CORNER

CERTIFICATION

I, Kelly Rooney  
certify the information shown herein is true and correct.  
Kelly Rooney  
Signature Ground Party Chief

I, Alvah F. Hughes  
certify that this Corner Record correctly represents work performed by me or under my direction in compliance with the "Corner Recordation Act" (70-22-101, et seq., M.C.A.)  
Alvah F. Hughes  
Signature of Surveyor & Seal

Date: 8/18/2011 Reg. No. 7322-LS  
Employer: Kootenai Surveyors Inc.

Office of Clerk and Recorder, County of Lincoln This "corner

Sec. 20

record" was filed for record on 235238 BOOK: CCR CC&R'S PAGE: 11917 Pages: 1  
was noted on the cross-index of STATE OF MONTANA LINCOLN COUNTY  
book No. RECORDED: 10/13/2011 3:28 KOI: CC&R'S  
TAMMY D. LAUER CLERK AND RECORDER  
FEE: \$0.00 BY: [Signature]  
TO: KOOTENAI SURVEYORS INC. P.O. BOX 393, LIBBY, MT 59923

Cross Index No. 0 09 T. 27N R. 28W P.M., MT

Adopted July 1, 1981, Montana Board of Professional Engineers & Land Surveyors

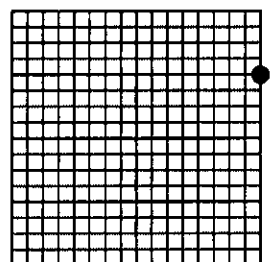

• corner this sheet