

CERTIFIED CORNER RECORDATION

Corner SW Cor. S19 T. 27 N. R. 28 W. P.M.M. Lincoln County

- I. Record: 1902 original GLO survey by Burton S. Adams and William Weeks: Set a limestone, 15x12x5 ins. 10 ins. the ground, marked with 2 notches on the S and 4 notches on the N edge from which:
- A pine, 30 ins. diam., bears N.70°E., 51 lks. dist., (33.66 ft.), mkd.T27 N28 S19 BT.
- A fir, 8 ins. diam., bears S.65°30'E., 39 lks. dist., (25.74 ft.), mkd.T27 R28 S30 BT.
- II. Found: A limestone 14x10x4 ins., 10 ins. in the ground with 2 notches on the S and 4 notches on the N edges, from which:
- A fir snag, 16 ins. diam., bears S.63°E., 26.20 ft. dist., with visible scribes.
- A pine stump, 27 ins. diam., bears N.70°E., 33.95 ft. dist., with healed face.
- III. Perpetuation: At the corner point, determined by the original found stone monument, set a Aluminum pipe 2 1/2 ins. diam., 30 ins. long 24 ins. in the ground, with a 3 1/4 ins. diam. Aluminum cap marked as shown below from which:
- A fir, 12 ins. diam., bears N.30°E., 11.30 ft. dist., scribed T27N R28W S19 BT.
- A fir, 11 ins. diam., bears S.58°E., 44.10 ft. dist., scribed T27N R28W S30 BT.
- Painted faces and 6 in. wide red bands to all bearing trees and attached Land Survey Monument and Bearing Tree signs.

Magnetic declination: 18° East

Equipment used: Hand compass and loggers tape

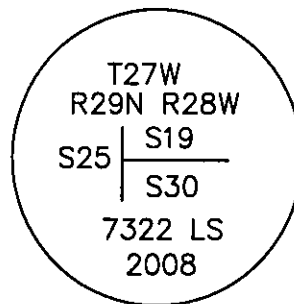

Kootenai Surveyors Inc., 314 California Av., Libby, MT. 59923 (406) 293-4354

Crystal Cr.- PCTC

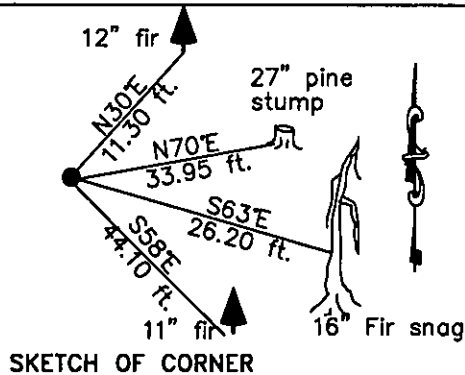

SKETCH OF CORNER

CERTIFICATION

I, Kelly Rooney
certify the information shown hereby is true and correct.

Kelly Rooney
Signature Ground/Party Chief

I, Alvah F. Hughes
certify that this Corner Record correctly represents work performed by me or under my direction in compliance with the "Corner Recordation Act" (70-22-101, et seq., M.C.A.)

Alvah F. Hughes
Signature of Surveyor & Seal

Date: 6/30/2008 Reg. No. 7322-LS

Employer: Kootenai Surveyors Inc.



Office of Clerk and Recorder, County of Lincoln This "corner

record" was filed 213029 BOOK: CCR CC&R'S PAGE: 11237 Pages: 1

was noted on the STATE OF MONTANA LINCOLN COUNTY

RECORDED: 07/23/2008 9:30 KOI: CC&R'S

book No. TAMMY D. LAUER CLERK AND RECORDER

FEE: \$0.00

BY: Alvah F. Hughes

TO: KOOTENAI SURVEYORS INC. P.O. BOX 393, LIBBY, MT 59923

Cross Index No. R 01 T. 27N R. 28W P.M., MT

Adopted July 1, 1981, Montana Board of Professional Engineers & Land Surveyors

Sec. 19

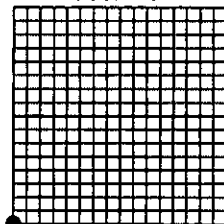

• corner this sheet