

INSTRUCTIONS

1. Original and/or subsequent record used to evaluate the corner position.
2. Description of evidence found, note discrepancies in the record, state method of establishing lost or obliterated corners.
3. Description of monument and accessories set to perpetuate the corner position.
4. Sketch of corner, show all pertinent data which can best be shown in a sketch example, corner marking, topography ties, position of accessories, etc.
5. Certification must be signed and sealed by Land Surveyor registered in the State of Montana.
6. Fill in Cross Index & Section Diagram at bottom of sheet.

CERTIFIED CORNER RECORDATION

Corner C1/4 SEC. 22 T. 28N R. 27W P.M.M. Flathead County

The new corner monument was established as a result of a subdivisional survey of the Section. Said subdivisional survey was made in accordance with methods and procedures contained in the Manual of Surveying Instructions (1973); U.S. Bureau of Land Management.

FOUND:

Found a 3/4" aluminum cap #7318S which was not accepted, from which:

An 8" tamarack with open blaze and visible scribing with attached bearing tree tag marked N87°W, 28.8' distant,

Dated: 8/99

An 8" fir with open blaze and visible scribing with attached bearing tree tag marked S21°W, 35.7' distant,

Dated: 8/99

ESTABLISH:

Establish new position for C1/4 Section 22. Set a 3/4" aluminum cap on standard aluminum monument #9958LS, marked as shown below; from which:

An 11" fir bears N16 1/2°E, 35.2 feet distant, blaze and scribe "C1/4 S22 BT".

A 9" fir bears S81 3/4°E, 41.9 feet distant, blaze and scribe "C1/4 S22 BT".

Bearing trees were painted red and bearing tree tags were attached.

A 3/4" aluminum cap #7318S on a 5/8" rebar bears N70°09'31"W, 25.93'.

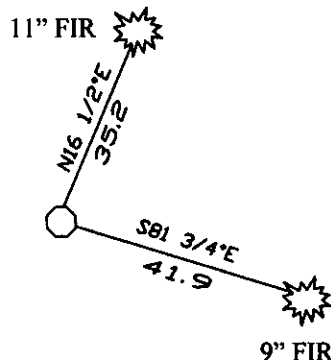

SKETCH OF CORNER

CERTIFICATION

I, Stephen Jeske
Certify the information shown herein is true and correct.

Stephen Jeske
Signature Ground Party Chief

I, Stephen Jeske
certify that this Corner Record correctly represents work performed by
me or under my direction in compliance with the "Corner Recordation
Act" (70-22-101, et seq., M.C.A.)

Stephen Jeske
Signature of Surveyor & Seal

Date: 05-27-08 Reg. No. 14230LS

Employer: J.R.S. Surveying, Inc.

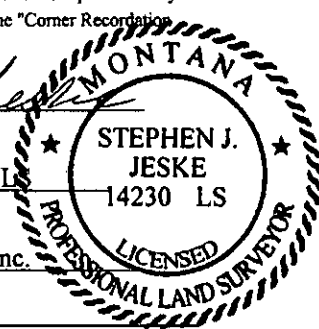

Office of Clerk and Recorder, County of _____ This "corner

record" was filed for record on 211737 BOOK: CCR CC&R'S PAGE: 11217 Pages: 1

was noted on the cross-index pla STATE OF MONTANA LINCOLN COUNTY

book no. _____ TAMMY D. LAUER CLERK AND RECORDER

FEE: \$0.00

BY: Heidi Blomdehl, Deputy

TO: J.R.S. SURVEYING P.O. BOX 1050, LIBBY, MONTANA 59923

Cross Index No. P15 T. 28N R. 27W PMM

