

INSTRUCTIONS

1. Original and/or subsequent record used to evaluate the corner position.
2. Description of evidence found, note discrepancies in the record, state method of establishing lost or obliterated corners.
3. Description of monument and accessories set to perpetuate the corner position.
4. Sketch of corner, show all pertinent data which can best be shown in a sketch example, corner marking, topography ties, position of accessories, etc.
5. Certification must be signed and sealed by Land Surveyor registered in the State of Montana.
6. Fill in Cross Index & Section Diagram at bottom of sheet.

CERTIFIED CORNER RECORDATION

Corner EW1/64 SEC.S 21/28 T. 27N R. 28W P.M.M. Lincoln County

The new corner monument was established as a result of a subdivisional survey of the Section. Said subdivisional survey was made in accordance with methods and procedures contained in the Manual of Surveying Instructions (1973); U.S. Bureau of Land Management.

FOUND:

Found 5/8" rebar with plastic cap #7318S, marked as shown below.

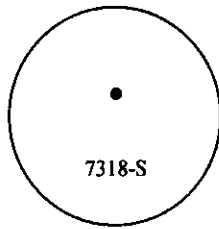

ESTABLISH:

Establish 2 new accessories for this corner.

A 10" Douglas Fir bears S4 3/4°W, 104.9 feet, blaze and scribe "1/64 S28 BT".

A 6" Douglas Fir bears N87 1/4°E, 79.3 feet, blaze and scribe "1/64 S21 BT".

Bearing tree blazes were painted red and bearing tree tags were attached.

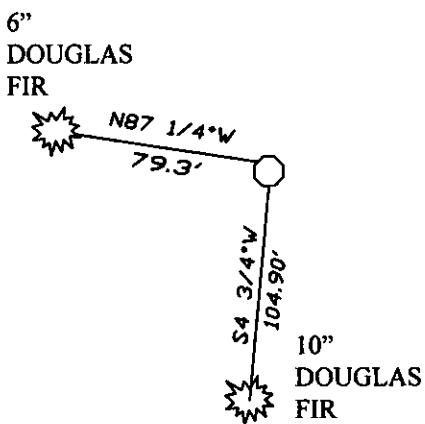

SKETCH OF CORNER

CERTIFICATION

I, Stephen Jeske
 Certify the information shown herein is true and correct.

Stephen Jeske
 Signature Ground Party Chief

I, Stephen Jeske
 certify that this Corner Record correctly represents work performed by me or under my direction in compliance with the "Corner Recordation Act" (70-22-101, et seq., M.C.A.)

Stephen Jeske
 Signature of Surveyor & Seal

Date: 05-27-08 Reg. No. 142301

Employer: J.R.S. Surveying, Inc.

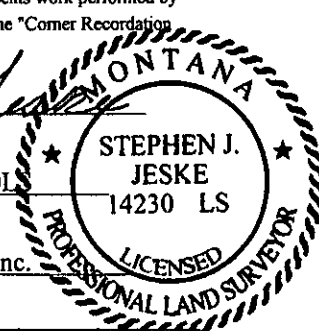

Office of Clerk and Recorder, County of _____ This "corner

record" was filed for record on 211724 BOOK: CCR CC&R'S PAGE: 11204 Pages: 1

was noted on the cross-index plat at STATE OF MONTANA LINCOLN COUNTY
 RECORDED: 05/29/2008 10:27 KOI: CC&R'S

book no. _____ TAMMY D. LAUER CLERK AND RECORDER

FEE: \$0.00 BY: *Lee Blomdahl, Deputy*
 TO: J.R.S. SURVEYING P.O. BOX 1050, LIBBY, MONTANA 59923

Cross Index No. AA13 T. 27N R. 28W PMM

	28		