

INSTRUCTIONS

1. Original and/or subsequent record used to evaluate the corner position.
2. Description of evidence found, note discrepancies in the record, state method of establishing lost or obliterated corners.
3. Description of monument and accessories set to perpetuate the corner position.
4. Sketch of corner, show all pertinent data which can best be shown in a sketch example, corner marking, topography ties, position of accessories, etc.
5. Certification must be signed and sealed by Land Surveyor registered in the State of Montana.
6. Fill in Cross Index & Section Diagram at bottom of sheet.

CERTIFIED CORNER RECORDATION

Corner N1/4 SEC. 21 T. 27N R. 28W P.M.M. Lincoln County

ORIGINAL GLO – Burton S. Adams and William E. Weeks - 1902

Set a limestone 24x10x6 inches, 18 inches in the ground for ¼ Section corner, marked ¼ on north face, from which:
 A fir, 20 inches diameter, bears N66°30'E, 78 links (51.48 feet) distant, marked "1/4 S16 BT".
 A pine, 30 inches diameter, bears S55°E, 63 links (41.58 feet) distant, marked "1/4 S21 BT".

FOUND:

Found original stone 19"x9"x7" with chiseled ¼ on west face in place, from which:
 A 31" pine bears S55°E, 41.3 feet distant with visible scribing and bearing tree tag.

ESTABLISH:

Replace original stone with 3¼" aluminum cap on standard 2½" aluminum monument, marked as shown below. Buried stone along the north side of monument. Monument 1.0' above ground with small rock cairn around base of monument, from which:

A 7" fir bears N21°W, 11.04 feet distant, blaze and scribe "1/4 S16 BT".
 Bearing trees were painted red and new bearing tree tags were attached.

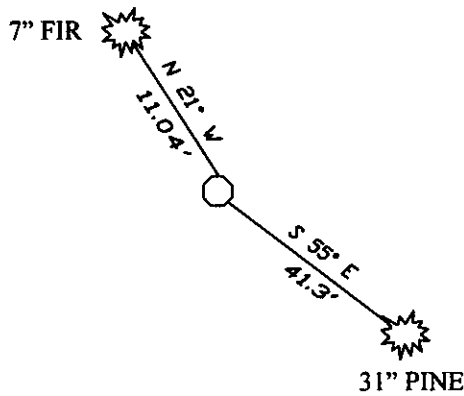
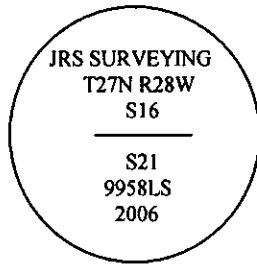

SKETCH OF CORNER

CERTIFICATION

I, Stephen Jeske
 Certify the information shown herein is true and correct.
Stephen Jeske
 Signature Ground Party Chief

I, Stephen Jeske
 certify that this Corner Record correctly represents work performed by me or under my direction in compliance with the "Corner Recordation Act" (70-22-10), et seq., M.C.A.)

Stephen Jeske
 Signature of Surveyor & Seal
 Date: 05-27-08 Reg. No. 14230 LS
 Employer: J.R.S. Surveying, Inc.

Office of Clerk and Recorder, County of _____ This "corner

record" was filed for record on

211721 BOOK: CCR CC&R'S PAGE: 11201 Pages: 1

was noted on the cross-index p. STATE OF MONTANA LINCOLN COUNTY

RECORDED: 05/29/2008 10:24 KOI: CC&R'S

book no. _____ TAMMY D. LAUER CLERK AND RECORDER

FEE: \$0.00

BY: *Heidi Blomdahl, Deputy*

TO: J.R.S. SURVEYING P.O. BOX 1050, LIBBY, MONTANA 59923

Cross Index No. N11 T. 27N R. 28W PMM

	21		