

INSTRUCTIONS

1. Original and/or subsequent record used to evaluate the corner position.
2. Description of evidence found, note discrepancies in the record, state method of establishing lost or obliterated corners.
3. Description of monument and accessories set to perpetuate the corner position.
4. Sketch of corner, show all pertinent data which can best be shown in a sketch example, corner marking, topography ties, position of accessories, etc.
5. Certification must be signed and sealed by Land Surveyor registered in the State of Montana.
6. Fill in Cross Index & Section Diagram at bottom of sheet.

CERTIFIED CORNER RECORDATION

Corner M.C. $\frac{S19}{S30}$ East Bank T. 27 N R. 27 W P.M.M. LINCOLN County

ORIGINAL AND/OR SUBSEQUENT RECORD

ORIGINAL RECORD: Set a Granite Boulder, 15" x 10" x 6", 10" in the ground, with 2 grooves in S face, marked M.C. on W face;
 From Which:
 A fir, 10" in diam. bears N 3° E, 58 lks dist. marked T27N R27W S19 M.C. B.T.
 A pine, 12" in diam. bears S 80° E, 34 lks. dist. marked T27N R27W S30 M.C. B.T.

EVIDENCE FOUND

Found Original Stone loosely set. From Which a 20" P. Pine with scribing visible bears S 80° E, 22.4'

PERPETUATION

Firmed stone up and left in place. Set a 5' steel Fence Post a approximately 1' East of monument. Established New RM a 21" P. Pine bears N 40° W 14.3'. Tagged original BT and new RM with MARLS Land Monument Sign Painted Red Band around Trees.

Note: Declination used - 20° E
 Measurements to center of Tree.

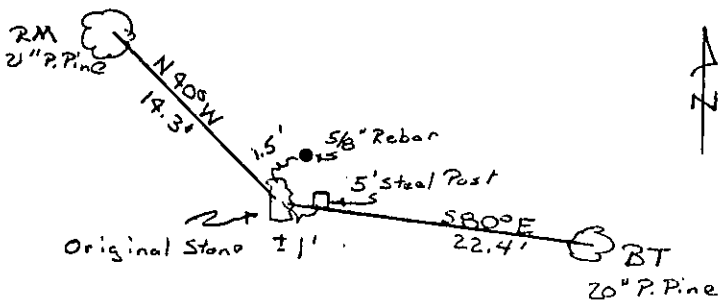

SKETCH OF CORNER

CERTIFICATION

I, Glenn R. Howard
 certify the information shown herein is true and correct.

Glenn R. Howard
 Signature Ground Party Chief

I, **TERRY L. DRUYVESTEIN**
 certify that this Corner Record correctly represents work performed by me or under my direction in compliance with the "Corner Recordation Act" (70-22-101, et seq., M.C.A.)

Terry L. Druyvestein
 Signature of Surveyor Seal 2927ES

Date: 07/90 Reg. No. 2927ES

Employer: STENSATTER DRUYVESTEIN & RED ASSOCIATES, INC.

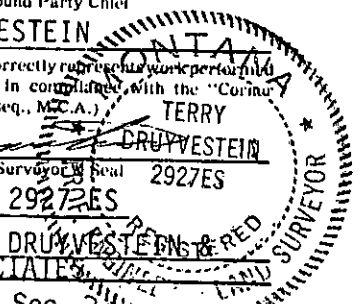

Office of Clerk and Recorder, County of Lincoln. This "corner record" was filed for record on 1-4-91

was noted on the cross-index plat and is assigned page No. 4387, in book No. _____

Just H. Sigel by Bill Beckhoff
 County Official

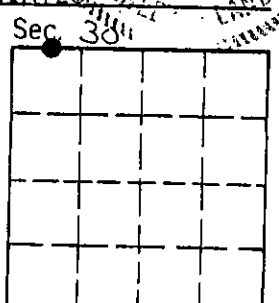

Cross Index No. B 1-2 T. 27 N R. 27 W P.M.M.

• corner this sheet