

INSTRUCTIONS

1. Original and/or subsequent record used to evaluate the corner position.
2. Description of evidence found, note discrepancies in the record, state method of establishing lost or obliterated corners.
3. Description of monument and accessories set to perpetuate the corner position.
4. Sketch of corner, show all pertinent data which can best be shown in a sketch example, corner marking, topography lines, position of accessories, etc.
5. Certification must be signed and sealed by Land Surveyor registered in the State of Montana.
6. Fill in Cross Index & Section Diagram at bottom of sheet.

CERTIFIED CORNER RECORDATION

Corner S29 1/4 S28 T. 27 N R. 27 W P.M.M. LINCOLN County

ORIGINAL AND/OR
SUBSEQUENT RECORD

ORIGINAL RECORD: Set a Shale Stone, 15"x10"x4", 10" in the ground, marked 1/4 on W face;
From Which:
A Fir, 8" in diam. bears, N47° E, 22 lks. dist. marked 1/4 S28 BT
A Tamarack, 24" in diam. bears, N 82 1/2° W, 32 lks. dist. marked 1/4 S29 B.T.

EVIDENCE FOUND Original Stone Not Found. Original BT's Not Found.

PERPETUATION Set 3 1/4" Alum. Cap on 3/4" x 24" Rebar at Proportioned Distance between Sec. Corners. Set 5' Steel Fence Post at approximately 1' South of monument. Established Two RM Trees. An 12" spruce bears N 12° W, 30.2'. A 6" Larch bears N56° W, 8.1'. Both RM Trees Blazed and Tagged with MARLS Land Monument Sign and Painted Red Band around Trees.

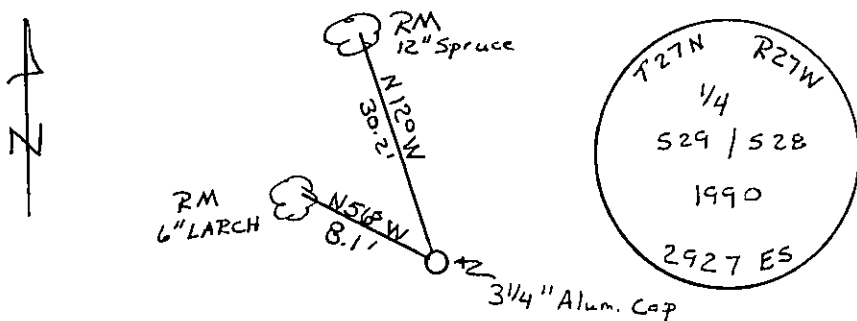

SKETCH OF CORNER

CERTIFICATION

I, Glenn R. Howard
certify the information shown herein is true and correct.

Glenn R. Howard
Signature Ground Party Chief

I, TERRY L. DRUYVESTEIN
certify that this Corner Record correctly represents work performed by me or under my direction in compliance with the Corner Recordation Act" (70-22-101 et seq., M.C.A.)

Terry L. Druyvestein
Signature of Surveyor & Seal

Date: 07/90 Reg. No. 2927 ES

Employer: STENSATTER DRUYVESTEIN & ASSOCIATES

Sec. 28

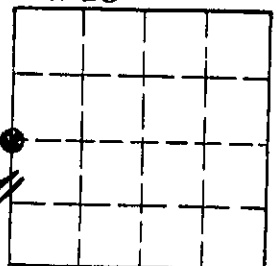

Office of Clerk and Recorder, County of Lincoln. This "corner

record" was filed for record on 1-4-91

was noted on the cross-index plat and is assigned page No. 4385, in

book No. _____

Janet D. Sigel by Bill Buckley
County Official

Cross Index No. T-9 T. 27 N R. 27 W P.M.M.

• corner this sheet