

INSTRUCTIONS

1. Original and/or subsequent record used to evaluate the corner position.
2. Description of evidence found, note discrepancies in the record, state method of establishing lost or obliterated corners.
3. Description of monument and accessories set to perpetuate the corner position.
4. Sketch of corner, show all pertinent data which can best be shown in a sketch example, corner marking, topography ties, position of accessories, etc.
5. Certification must be signed and sealed by Land Surveyor registered in the State of Montana.
6. Fill in Cross Index & Section Diagram at bottom of sheet.

CERTIFIED CORNER RECORDATION

Corner CE 1/4 S 31 T. 27 N R. 27 W P.M.M. LINCOLN County

ORIGINAL AND/OR
SUBSEQUENT RECORD None

EVIDENCE FOUND None

PERPETUATION Set 1 1/2" Alum. Cap on 5/8" x 24" Rebar. Set 5' Steel Fence Post 1' North of Monument. Established Two RM's. A 4" LP. Pine bears N44°E, 21.3' and a 6" LP. Pine bears S33°E, 15.7'. Both RM Trees Blazed and Tagged with MARLS Land Monument Sign

Note: Declination used - 18°E
Measurements taken to center of tree

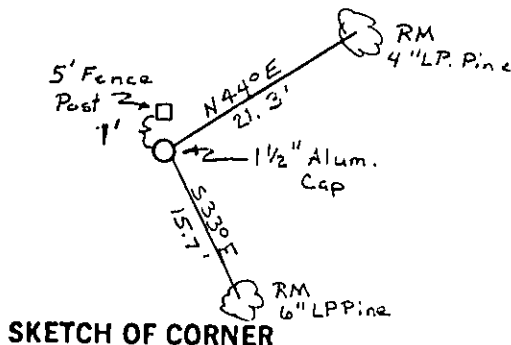
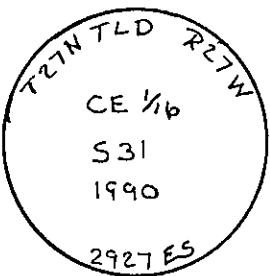

SKETCH OF CORNER

CERTIFICATION

I, Red Cone
certify the information shown heroff is true and correct.

Signature Ground Party Chief

I, TERRY L. DRUYVESTEIN
certify that this Corner Record correctly represents work performed by me or under my direction in compliance with the Corner Recordation Act (70-22-101, et seq., M.C.A.)

Signature of Surveyor & Seal

Date: 07/90 Reg. No. 2927 ES

Employer: STENSATTER DRUYVESTEIN & ASSOCIATES

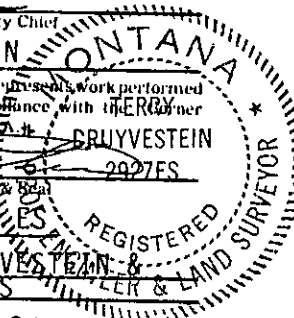

Office of Clerk and Recorder, County of Lincoln. This "corner record" was filed for record on 1-4-91

was noted on the cross-index plat and is assigned page No. 4363, In book No. _____

Janet BF. Sugel by Bill Buckhoff
County Official

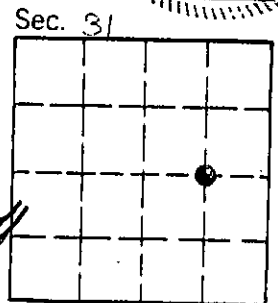

Cross Index No. X-4 T. 27 N R. 27 W P.M.M.

• corner this sheet