

INSTRUCTIONS

1. Original and/or subsequent record used to evaluate the corner position.
2. Description of evidence found, note discrepancies in the record, state method of establishing lost or obliterated corners.
3. Description of monument and accessories set to perpetuate the corner position.
4. Sketch of corner, show all pertinent data which can best be shown in a sketch example, corner marking, topography ties, position of accessories, etc.
5. Certification must be signed and sealed by Land Surveyor registered in the State of Montana.
6. Fill in Cross Index & Section Diagram at bottom of sheet.

CERTIFIED CORNER RECORDATION

Corner Sections 29, 30, 31 & 32 T. 27 N. R. 27 W. P.M.M. Lincoln County

I. August 20, 1900, G.L.O. survey by James M. Page and John P. Henselwood:

"80.00 Set a pine post 4 ft. long, 4 ins. sq., 24 ins. in the ground, for cor. of secs. 29, 30, 31, and 32, marked T. 27 N., S. 29 on N.E., R. 27 W., S. 32 on S.E., S. 31 on S.W., and S. 30 on N.W. faces; with 1 notch on S. and 5 notches on E. edges; from which

A pine, 10 ins. diam., bears N. 16° E., 105 lks. dist., marked T.27N., R.27W., S.29 B.T.

A tamarack, 10 ins. diam., bears S. 42° E., 71 lks., dist., marked T.27N., R.27W., S.32 B.T.

A tamarack, 36 ins. diam., bears S. 55° W., 60 lks., dist., marked T.27N., R.27W., S.31 B.T.

A fir, 10 ins. diam., bears N. 73° W., 35 lks., dist., marked T.27N., R.27W., S30 B.T."

II. Found the rotten remains of a wooden post 22" below the ground surface, when wood is removed a 4" x 4" square hole remains, from which:

A Ponderosa Pine 21" diam., brs. N. 15° E., 68.5 ft. (104 lks.) with original scribing visible.

A Larch stump 20" diam., brs. S. 42° E., 46.4 ft. (70 lks.) no scribing visible.

A Larch stump 36" diam., brs. S. 53° W., 39.8 ft. (60 lks.) no scribing visible.

A Douglas fir 22" diam., brs. N. 67° W., 22.5 ft. (34 lks.) partial original scribing visible.

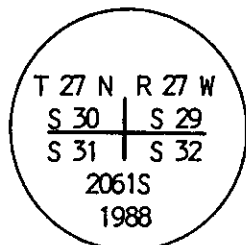
III. At the position of the found remains of the wooden post we drive a $\frac{3}{4}$ " diam. by 30" long aluminum rod, 26" into the ground. On top of the rod a $3\frac{1}{4}$ " aluminum cap is marked:

Fill in area around the rod and on the ground surface with concrete.

From which we establish new bearing trees to replace the two original trees which are now stumps:

A Douglas Fir 7" diam., brs. S. 70° E., 11.3 ft. scribed T27N R27W S32 BT.

A Douglas Fir 10" diam. brs. S. 21° W., 49.3 ft. scribed T27N R27W S31 BT.

A Montana Association of Registered Land Surveyors tag on a 4" diam. Douglas Fir brs. N. 60° W., 6.2 ft.

A 4" diam. brass benchmark marked "21A 1931 Elevation above Sea level 3566 Ft", set in concrete and slightly leaning brs. S. 27° W., 18.9 ft.

Painted scribe blazes red and posted Bearing Tree signs and Land Survey Monument signs on all bearing trees.

Bearing measurements taken with a hand compass utilizing 19° E. declination

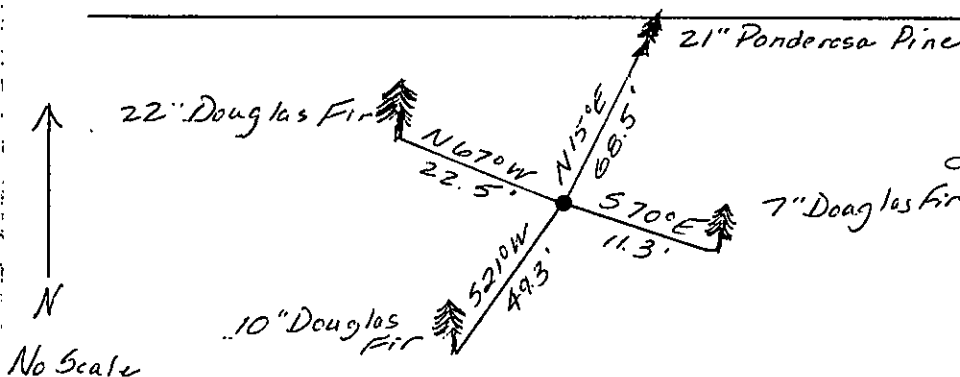

SKETCH OF CORNER

CERTIFICATION

L. Smith, K. Kern, R. Pearson G. Orison

certify the information shown herein is true and correct.

L. Smith K. Kern R. Pearson G. Orison
Signature Ground Party Chief

Warren L. Hersman

I, Warren L. Hersman
certify that this Corner Record correctly represents work performed by me or under my direction in compliance with the "Corner Recordation Act" (70-22-101 et seq., M.C.A.)

Warren L. Hersman
Signature of Surveyor & Seal

Date: 7/88 Reg. No. 2061S

Employer: Hersman Survey

Office of Clerk and Recorder, County of Lincoln. This "corner

record" was filed for record on Oct 3, 1988

was noted on the cross-index plat and is assigned page No. 3909, in

book No. _____

Janet B. Sugil by Bill Sugil
County Official

Cross Index No. V-5 T. 27 N R. 27 W P.M.M.

Sec. 32

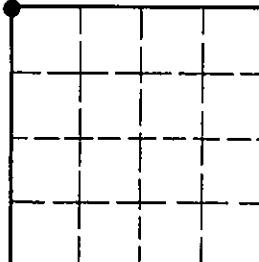

• - corner this sheet