

CERTIFIED CORNER RECORDATION

CORNER NW SEC. 16 T. 27N R. 27W P.M.M., LINCOLN COUNTY

FOUND: 3 1/4" ALUM CAP STAMPED AS SHOWN, FROM WHICH;
 8" FIR WITH TAG BEARS N68°E 11.0'.
 16" PINE WITH TAG BEARS S72°E 25.5'.
 23" FIR BEARS S60°W 13.90' WITH OVERGROWN SCRIBE.
 8" FIR WITH TAG BEARS N43°W 15.10'.

MAINTENANCE: REMOVED BRUSH AND TREE LIMBS FROM CORNER AND SET
 A 5 FOOT STEEL POST 2 FEET SOUTH OF CORNER.
 ATTACHED BT TAG'S AND PAINTED 6" BAND ON BT.

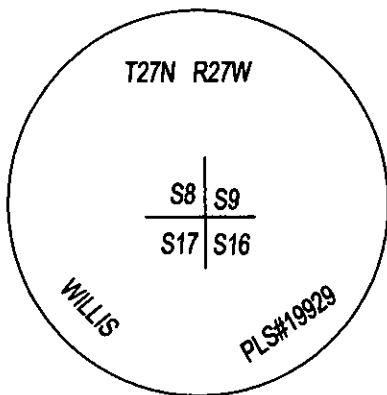
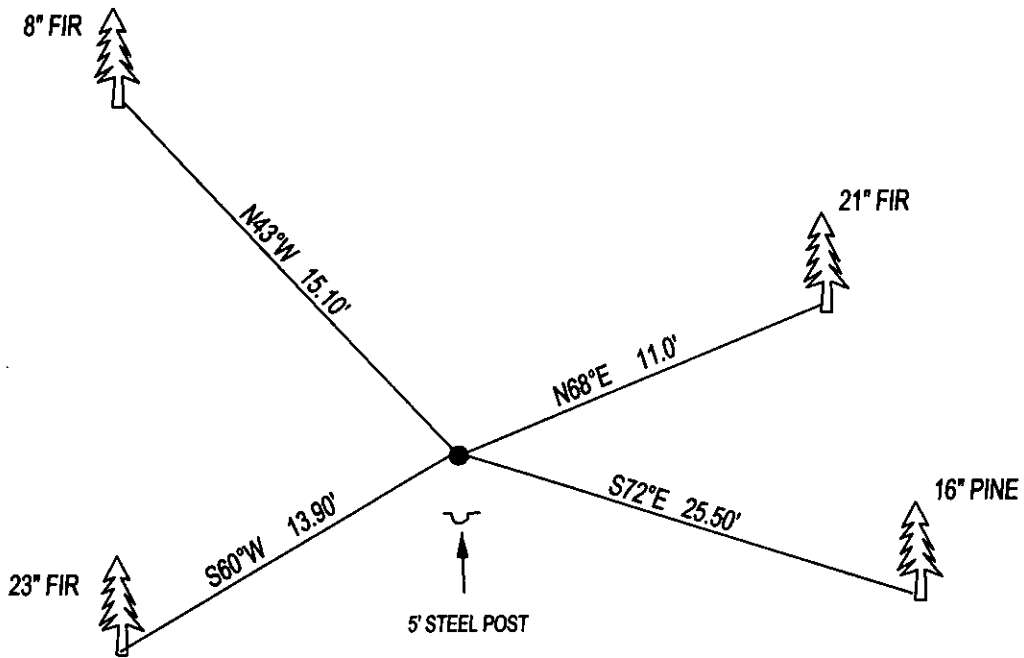

SKETCH OF CORNER

CERTIFICATION

I, DAN CROFT
 CERTIFY THE INFORMATION SHOWN HEREIN IS TRUE AND CORRECT.

SIGNATURE GROUND PARTY CHIEF

I, MARC J. CARSTENS
 CERTIFY THAT THIS CORNER RECORD CORRECTLY REPRESENTS WORK
 PERFORMED BY ME OR UNDER MY DIRECTION IN COMPLIANCE WITH THE
 "CORNER RECORDATION ACT" (70-22-101, ET SEQ., M.C.A.)

[Signature]
 SIGNATURE OF SURVEYOR & SEAL

07-11-13

DATE

CARSTENS SURVEYING

EMPLOYER

5940LS
 REG. NO.

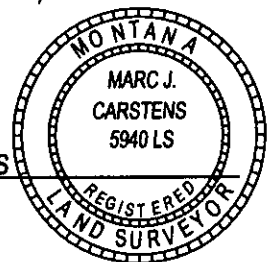

246246 BOOK: CCR CC&R'S PAGE: 12048 Pages: 1

STATE OF MONTANA LINCOLN COUNTY

RECORDED: 07/15/2013 11:41 KOI: CC&R'S

TAMMY D. LAUER CLERK AND RECORDER

FEE: \$0.00

FOR: FILED

COUNTY OFFICIAL

CROSS INDEX NO. J-9 T. 27N R. 27W P.M.M.

ADOPTED JULY 1, 1981, MONTANA BOARD OF PROFESSIONAL ENGINEERS & LAND SURVEYORS

SEC. 16

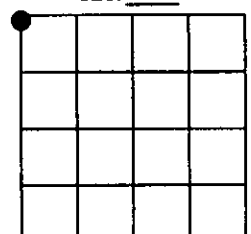

● CORNER THIS SHEET