

CERTIFIED CORNER RECORDATION

CORNER NW SEC. 15 T. 27N R. 27W P.M.M., LINCOLN COUNTY

FOUND: 3 1/4" B.L.M. BRASS CAP STAMPED AS SHOWN, FROM WHICH;
 8" FIR BEARS N10°E 12.0" WITH PITCHED OVER SCRIBE.
 14" DOUBLE FIR WITH TAG BEARS N26°E 19.30" WITH NO BLAZE.
 12" FIR SNAG BEARS N85°E 15.80" WITH FULL SCRIBE.
 12" FIR WITH TAG BEARS S41°W 23.15" WITH NO BLAZE.
 24" FIR SNAG BEARS N77°W 37.60" WITH OVERGROWN SCRIBE.
 6" FIR BEARS N78°W 23.50" WITH OVERGROWN SCRIBE.

MAINTENANCE: REMOVED BRUSH AND TREE LIMBS FROM CORNER AND SET
 A 5 FOOT STEEL POST 2 FEET SOUTH OF CORNER.
 ATTACHED BY TAG'S AND PAINTED 6" BAND ON BT'S.

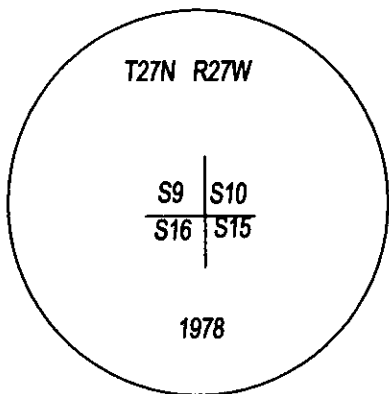
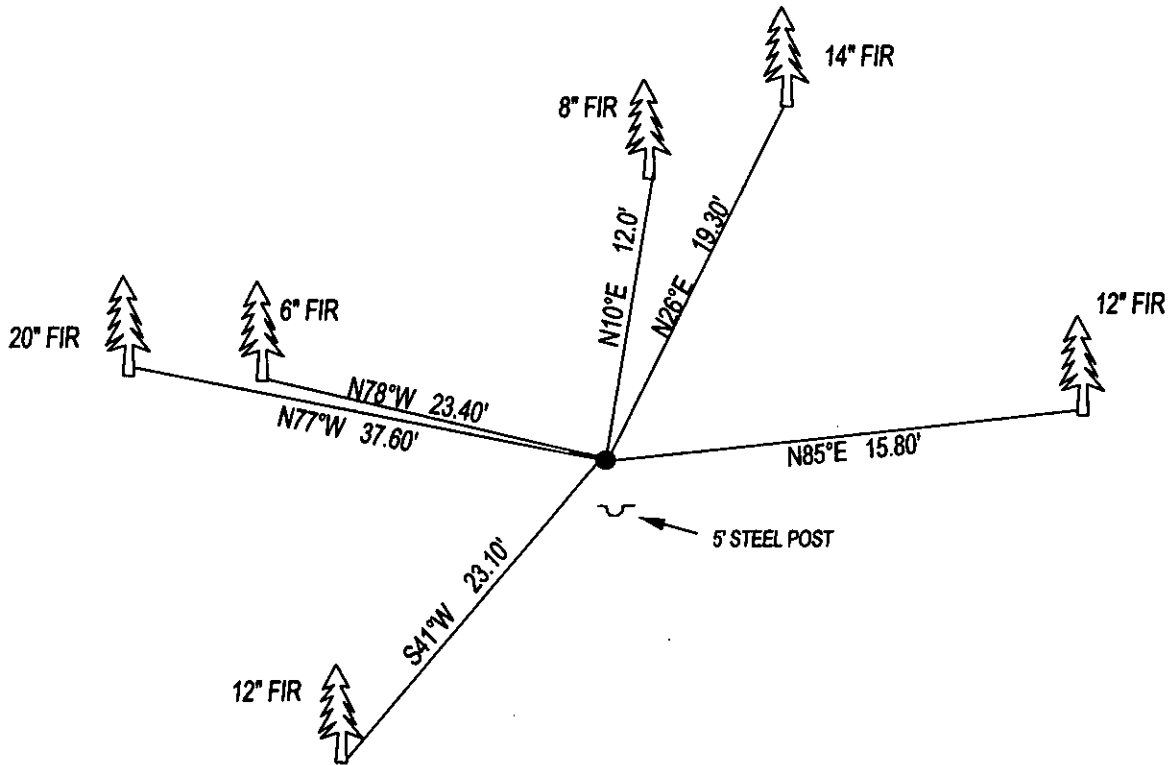

SKETCH OF CORNER

CERTIFICATION

I, DAN CROFT
 CERTIFY THE INFORMATION SHOWN HEREIN IS TRUE AND CORRECT.

SIGNATURE GROUND PARTY CHIEF

I, MARC J. CARSTENS
 CERTIFY THAT THIS CORNER RECORD CORRECTLY REPRESENTS WORK
 PERFORMED BY ME OR UNDER MY DIRECTION IN COMPLIANCE WITH THE
 "CORNER RECORDATION ACT" (70-22-101, ET SEQ., M.C.A.)

[Signature]
 SIGNATURE OF SURVEYOR & SEAL

07-02-13
 DATE

CARSTENS SURVEYING
 EMPLOYER

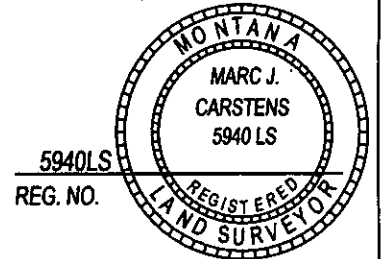

5940LS
 REG. NO.

OFFICE OF CLERK AND RECORDER, COUNTY OF LINCOLN
 THIS "CORNER RECORD" WAS FILED FOR RECO
 WAS NOTED ON T-
 AND IS ASSIGNED PAGE NO. _____ IN BOX

COUNTY OFFICIAL

CROSS INDEX NO. J-13 T. 27N R. 27W P.M.M.

ADOPTED JULY 1, 1981, MONTANA BOARD OF PROFESSIONAL ENGINEERS & LAND SURVEYORS

246194 BOOK: CCR CC&R'S PAGE: 12047 Pages: 1
 STATE OF MONTANA LINCOLN COUNTY
 RECORDED: 07/11/2013 10:50 KOI: CC&R'S
 TAMMY D. LAUER CLERK AND RECORDER
 FEE: \$0.00 BY: *[Signature]*
 FOR: CARSTENS LAND SURVEYING P.O. BOX 1374, POLSON, MONTANA

SEC. 15

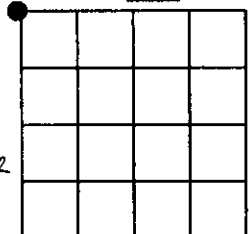

● CORNER THIS SHEET