

# CERTIFIED CORNER RECORDATION

CORNER SW SEC. 15 T. 27N R. 27W P.M.M., LINCOLN COUNTY

FOUND: 3 1/4" B.L.M. BRASS CAP STAMPED AS SHOWN, FROM WHICH;  
 21" FIR BEARS N36°E 20.50" WITH OVERGROWN SCRIBE.  
 25" FIR BEARS S50°E 24.80" WITH SCRIBE.  
 24" LARCH SNAG BEARS S89°W 23.10" WITH SCRIBE.  
 20" FIR BEARS N38°W 25.10" WITH OVERGROWN SCRIBE.

MAINTENANCE: REMOVED BRUSH AND TREE LIMBS FROM CORNER AND SET  
 A 5 FOOT STEEL POST 2 FEET NORTH OF CORNER.  
 ATTACHED BT TAG'S AND PAINTED 6" BAND ON BT'S.

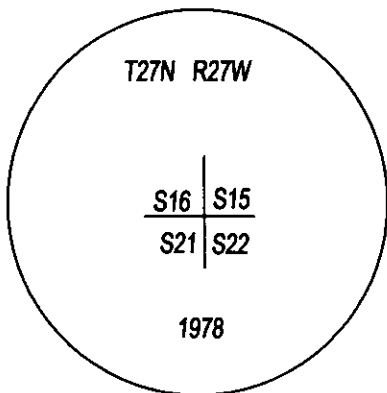
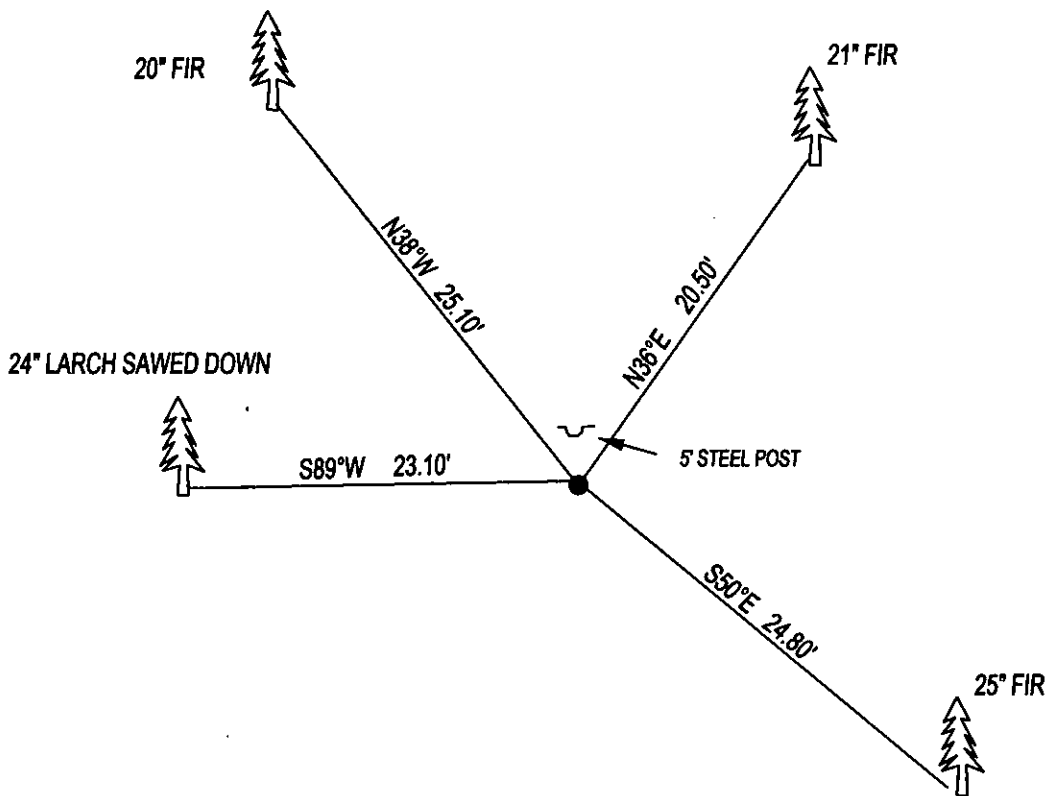

SKETCH OF CORNER

## CERTIFICATION

I, DAN CROFT  
 CERTIFY THE INFORMATION SHOWN HEREIN IS TRUE AND CORRECT.

SIGNATURE GROUND PARTY CHIEF

I, MARC J. CARSTENS  
 CERTIFY THAT THIS CORNER RECORD CORRECTLY REPRESENTS WORK  
 PERFORMED BY ME OR UNDER MY DIRECTION IN COMPLIANCE WITH THE  
 "CORNER RECORDATION ACT" (70-22-101, ET SEQ., M.C.A.)

*[Signature]*  
 SIGNATURE OF SURVEYOR & SEAL

07-02-13

DATE

CARSTENS SURVEYING

EMPLOYER

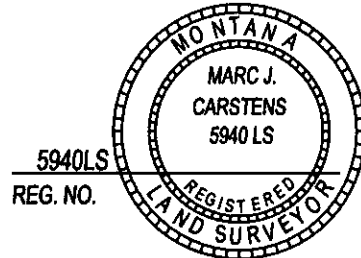

5940LS  
 REG. NO.

OFFICE OF CLERK AND RECORDER, COUNTY OF LINCOLN

THIS "CORNER RECORD" WAS FILED FOR 246192 BOOK: CCR CC&R'S PAGE: 12045 Pages: 1

AND IS ASSIGNED PAGE NO. WAS NOT. STATE OF MONTANA LINCOLN COUNTY

RECORDED: 07/11/2013 10:40 KOI: CC&R'S

TAMMY D. LAUER CLERK AND RECORDER

FEE: \$0.00 BY: *[Signature]*

FOR: CARSTENS LAND SURVEYING P.O. BOX 1374, POLSON, MONTANA

CROSS INDEX NO. N-13 T. 27N R. 27W P.M.M.

ADOPTED JULY 1, 1981, MONTANA BOARD OF PROFESSIONAL ENGINEERS & LAND SURVEYORS

SEC. 15

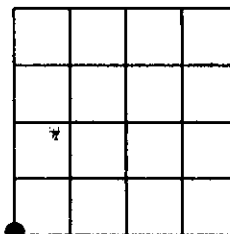

● CORNER THIS SHEET