

# CERTIFIED CORNER RECORDATION

Corner NE CORNER GOV'T LOT 11 T. 27N R. 27W P.M.M. County LINCOLN  
SECTION 4

RECORD: NONE

SET: 5/8"x24" REBAR WITH YPC, STAMPED AS SHOWN, FROM WHICH:  
9" FIR BEARS S85°E 12.30' SCRIBED RM.  
7" LODGEPOLE BEARS S31°W 23.80' SCRIBED RM.

SET A STEEL POST 50' SOUTH AND 3' WEST OF CORNER.  
ATTACHED BT TAGS AND PAINTED A RED 6" BAND AND SCRIBE RED

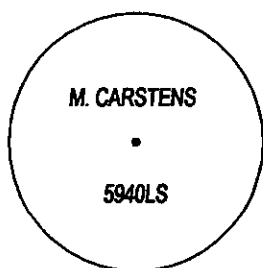
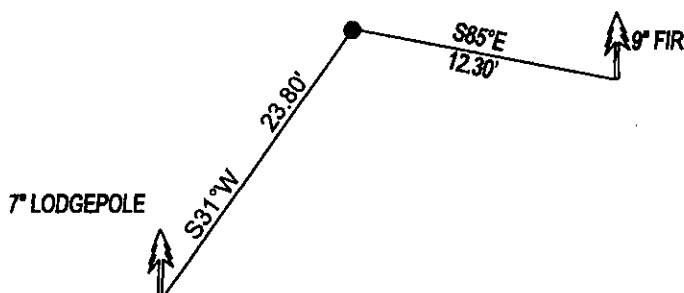

SKETCH OF CORNER

## CERTIFICATION

DAN CROFT

certify the information shown herein is true and correct.

Signature Ground Party Chief

MARC J. CARSTENS

certify that this Corner Record correctly represents work performed by me or under my direction in compliance with the "Corner Recordation Act" (M-22-101, et seq., M.C.A.)

[Signature]  
Signature of Surveyor & Seal

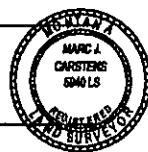

Date: 7-2009 Reg. No. 5940LS

Employer: CARSTENS LAND SURVEYING

Office of Clerk and Recorder, County of LINCOLN . This "corner

record" was filed for record on 220443 BOOK: CCR CC&R'S PAGE: 11321 Pages: 1

STATE OF MONTANA LINCOLN COUNTY

was noted on the cross-index plat on RECORDED: 07/21/2009 10:10 KOI: CC&R'S

book No. TAMMY D. LAUER CLERK AND RECORDER

FEE: \$0.00

BY: [Signature]

TO: CARSTENS LAND SURVEYING P.O. BOX 1374, POLSON, MONTANA

Cross Index No. A-8-11 T. 27N R. 27W PMM

Adopted July 1, 1981, Montana Board of Professional Engineers & Land Surveyors

Sec. 4

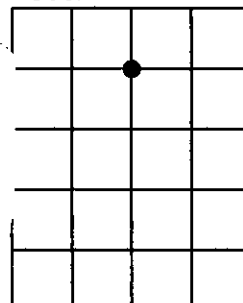

• corner this sheet

