

# CERTIFIED CORNER RECORDATION

Corner NORTH EAST SECTION 24 T. 27 N. R. 27 W. P.M.M. LINCOLN County

G.L.O. RECORD: SHALE STONE, 18" X 15" X 5", 13" IN THE GROUND FOR COR. OF SECS. 13, 18, 19 & 24 MARKED WITH 3 NOTCHES ON THE S. AND 3 NOTCHES ON N. EDGES FROM WHICH

- A 5" FIR BEARS N2°E 13 LKS. DIST., MARKED T. 27 N., R. 26 W., S. 18, B.T.
- A 8" TAMARACK BEARS S52°E 46 LKS. DIST., MARKED T. 27 N., R. 26 W., S. 19, B.T.
- A 8" SPRUCE BEARS S20°W 9 LKS. DIST., MARKED T. 27 N., R. 27 W., S. 24, B.T.
- A 15" SPRUCE BEARS N62°W 19 LKS. DIST., MARKED T. 27 N., R. 27 W., S. 13, B.T.

- '2006' FOUND: ORIGINAL STONE
- A 19" SPRUCE BEARS S20°W 6.5 FEET DIST., SCRIBED B.T.
  - A 5" FIR BEARS N69°E 10.4 FEET DIST., SCRIBED B.T.

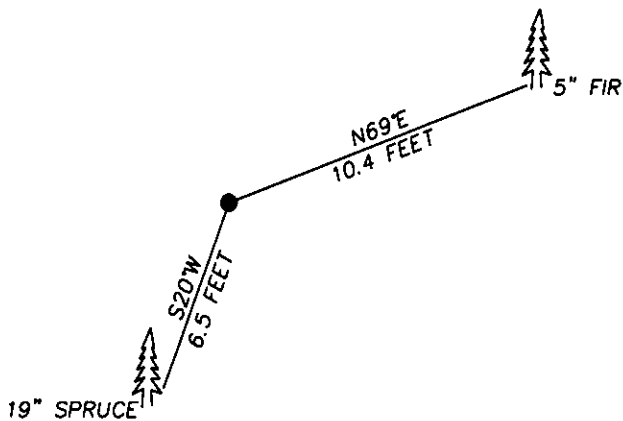

SKETCH OF CORNER

CERTIFICATION

I, VIC ROBINSON  
 certify the information shown herein is true and correct.  
*Vic Robinson*  
 Signature Ground Party Chief

I, MARC J. CARSTENS  
 certify that this Corner Record correctly represents the work performed by me or under my direction in compliance with the 'Corner Recordation Act' (70-22-101, et seq., M.C.A.)  
*Marc J. Carstens*  
 Signature of Surveyor & Seal

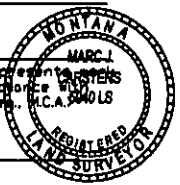

Date: 10-16-06 Reg. No. 5940 I.S.  
 Employer: CARSTENS LAND SURVEYING

Office of Clerk and Recorder, County of LINCOLN. This 'corner record' was filed for r

198411 BOOK: CCR CC&R'S PAGE: 10951 Pages: 1  
 STATE OF MONTANA LINCOLN COUNTY  
 was noted on the cross RECORDED: 10/27/2006 9:55 KOI: CC&R'S  
 CORAL M. CUMMINGS CLERK AND RECORDER  
 book No. \_\_\_\_\_ FEE: \$0.00 BY: *Coral M. Cummings*  
 TO: FILED ,

Cross Index No. N-25 T. 27N R. 27W P.M.M.

Adopted July 1, 1981, Montana Board of Professional Engineers & Land Surveyors

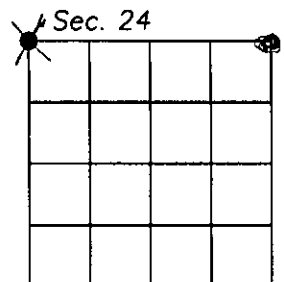

• corner this sheet