

CERTIFIED CORNER RECORDATION

Corner SOUTHWEST SECTION 24 T. 27 N. R. 27 W. P.M.M. LINCOLN County

G.L.O. RECORD: SHALE STONE, 16" X 10" X 6", 11" IN THE GROUND FOR COR. OF SECS. 23, 24, 25 & 26 MARKED WITH 2 NOTCHES ON THE S. AND 1 NOTCH ON E. EDGES FROM WHICH

- A 15" PINE BEARS N28°E 54 LKS. DIST., MARKED T. 27 N., R. 27 W., S. 24, B.T.
- A 18" FIR BEARS S88°E 50 LKS. DIST., MARKED T. 27 N., R. 27 W., S. 25, B.T.
- A 6" FIR BEARS S35°W 8 LKS. DIST., MARKED T. 27 N., R. 27 W., S. 26, B.T.
- A 15" FIR BEARS N3°W 44 LKS. DIST., MARKED T. 27 N., R. 27 W., S. 23, B.T.

'1978' FOUND: SHALE STONE, 16" X 10" X 6", 11" IN THE GROUND FOR COR. OF SECS. 23, 24, 25 & 26 MARKED WITH 2 NOTCHES ON THE S. AND 1 NOTCH ON E. EDGES FROM WHICH

- A 36" PINE BEARS N28°E 54 LKS. DIST., MARKED T. 27 N., R. 27 W., S. 24, B.T., WITH AN OVERGROWN BLAZE.
- A 26" FIR BEARS S88°E 50 LKS. DIST., MARKED T. 27 N., R. 27 W., S. 25, B.T., WITH AN OVERGROWN BLAZE.
- A 16" FIR BEARS S35°W 8 LKS. DIST., MARKED T. 27 N., R. 27 W., S. 26, B.T., WITH AN OVERGROWN BLAZE.
- A 28" FIR BEARS N3°W 44 LKS. DIST., MARKED T. 27 N., R. 27 W., S. 23, B.T., WITH AN OVERGROWN BLAZE.

AT THE CORNER POINT: SET AN IRON POST, 30" LONG, 2 1/2" DIA., 22" IN THE GOUND, WITH BRASS CAP MKD. BURY ORIGINAL STONE ALONGSIDE AND RAISE A FLAT MOUND OF STONE, 2 1/2 FT. DIAM. BASE.

'2006' FOUND: 3 1/2" BRASS CAP .8 FEET OUT OF GROUND FOR COR. OF SECS. 23, 24, 25 & 26

- A 36" PINE BEARS N28°E 54 LKS. DIST., WITH AN OVERGROWN BLAZE.
- A 26" FIR BEARS S88°E 50 LKS. DIST., WITH AN OVERGROWN BLAZE.
- A 16" FIR BEARS S35°W 8 LKS. DIST., WITH AN OVERGROWN BLAZE.
- A 30" FIR BEARS N3°W 44 LKS. DIST., WITH AN OVERGROWN BLAZE.

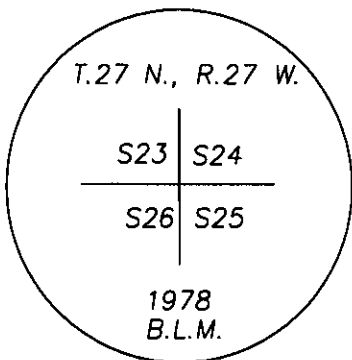
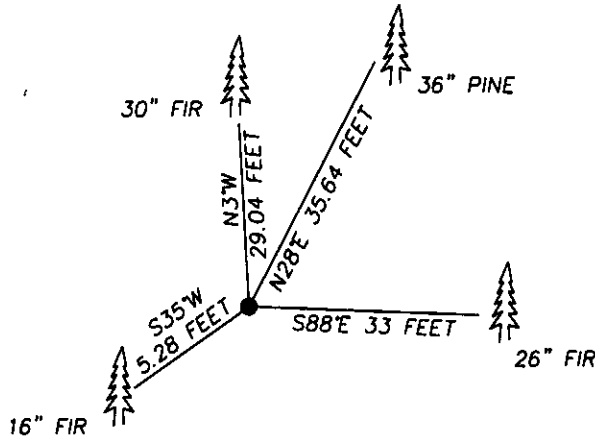

SKETCH OF CORNER

CERTIFICATION

I, VIC ROBINSON
 certify the information shown herein is true and correct.
Vic Robinson
 Signature Ground Party Chief

I, MARC J. CARSTENS
 certify that this Corner Record correctly represents the corner
 performed by me or under my direction in compliance with
 the "Corner Recordation Act" (70-22-101, et seq., M.C.A.)
Marc J. Carstens
 Signature of Surveyor & Seal

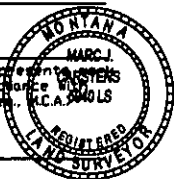

Date: 10-16-06 Reg. No. 5940 IS
 Employer: CARSTENS LAND SURVEYING

Office of Clerk and Recorder, County of LINCOLN . This 'corner
 198407 BOOK: CCR CC&R'S PAGE: 10947 Pages: 1
 record' was filed for STATE OF MONTANA LINCOLN COUNTY
 was noted on the CLERK'S RECORD: 10/27/2006 9:35 KOI: CC&R'S
 book No. _____ FEE: \$0.00 BY: *Coral M. Cummings*
 TO: FILED CORAL M. CUMMINGS CLERK AND RECORDER

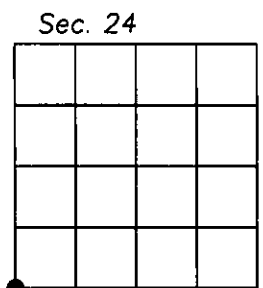

• corner this sheet

Cross Index No. R-21 T. 27N R. 27W P.M.M.