

CERTIFIED CORNER RECORDATION

Corner 80 1/16 Sec. 6 T. 27N R. 26W P.M., MT Lincoln Flathead County

- I. No history found.
- II. No evidence found.
- III. At the corner point, as determined by survey, set a 30 ins. long, 3/4 in. diam. aluminum rod, 28 ins. in the ground, with a 3 1/4 ins. diam. aluminum cap, mkd. as shown below:

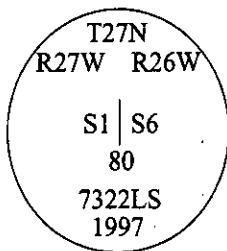

Established two bearing trees:

- A fir, 14 ins. diam., bears N46°E, 128.1 ft. dist., mkd. "80 1/16 S6 BT".
- A spruce, 23 ins. diam., bears N72°E, 191.6 ft. dist., mkd. "80 1/16 S6 BT".

Painted bearing trees and attached Land Survey Monument and Bearing Tree signs.

Magnetic Declination: 20° East.

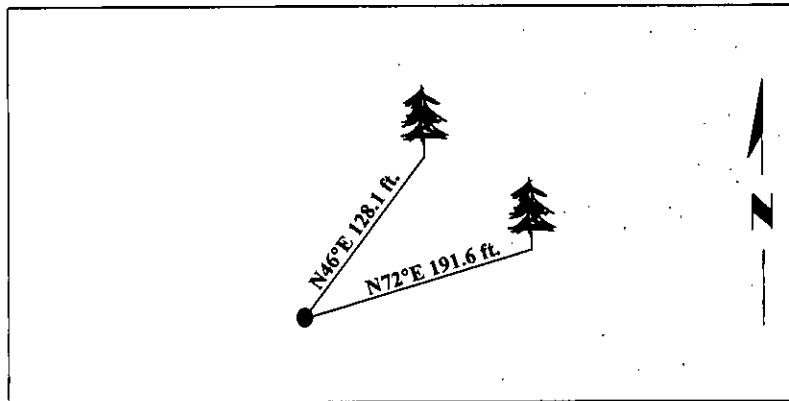

SKETCH OF CORNER

CERTIFICATION
I, Mark Federman
certify the information shown herein is true and correct.

I, Alvah F. Hughes
certify that this Corner Record correctly represents work performed by me or under my direction in compliance with the "Corner Recordation Act" (70-22-101, et seq., M.C.A.)
Alvah F. Hughes
Signature of Surveyor & Seal
Date: 12/05/97
Reg. No.: 7322LS
Employer: U.S. FOREST SERVICE

Office of Clerk and Recorder, County of Lincoln. This "corner record" was filed for record on 12-26-97 and was noted on the cross-index plat and is assigned page No. 10055 in book No. _____
Coral M. Cumming
County Official

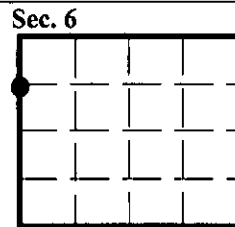

● - corner this sheet

CROSS INDEX PLAT

T. 27 R. 27 MER.

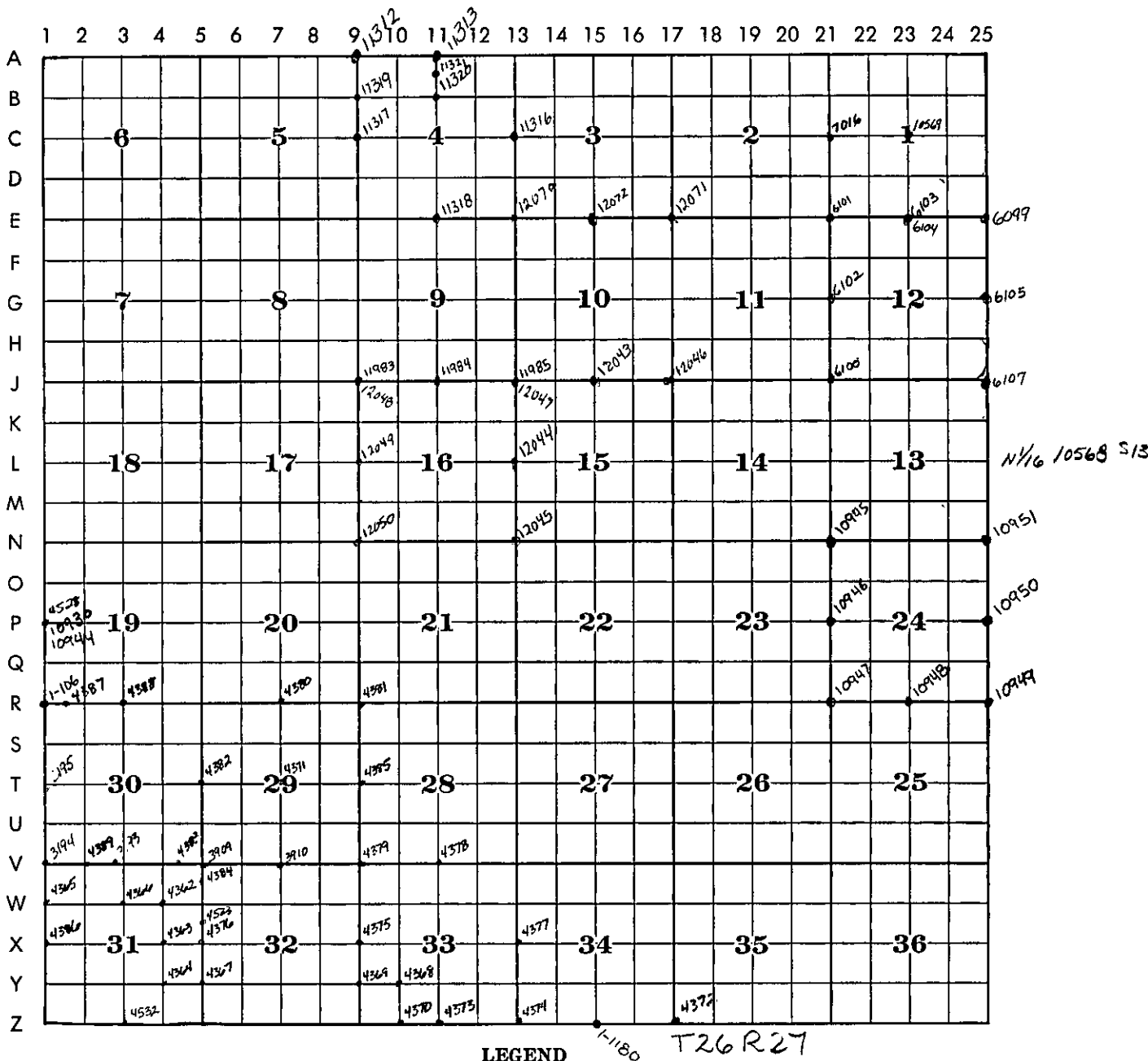

Each corner certificate is identified by an alphabetical-numerical coordinate number which is derived from the system shown on the township diagram. For example, the quarter-corner between Section 5 and 6 is identified as Corner C-5.

Corners such as meander corners or subdivision corners which are not located at intersecting lines on the above diagram will be identified by reference to the nearest applicable coordinate lines, thus:
AB-1; M-1-2; VW-19-20.

Corners common to adjoining townships will be identified by coordinates of the townships in which the certificates are to be filed.

Within each township record, the certificates will be filed in alphabetical-numerical sequence.