

CERTIFIED CORNER RECORDATION

Corner 4 MS 7368A Sec. 13 T. 26 N R. 31 W P.M., MT Lincoln County

I. 1904 G.L.O. original survey by Abram L. Jaqueth: Set a quartzite stone, 25 x 12 x 10 ins., 20 ins. deep, chiseled 4-7368A, from which:

A balsam fir, 8 ins. diam., bears S66°20'E, 12.3 ft. dist., scribed "B.T. 4-7368A".
A hemlock, 12 ins. diam., bears S89°40'W, 12.3 ft. dist., scribed "B.T. 4-7368 A".

II. Found a stone, firmly set, 9 x 9 ins., 9 ins. above ground, chiseled "4/7366A" on NW face and "X" on top. (Note: Stone marked incorrectly). No evidence of original bearing trees found, due to extreme wild fire activity.

III. Established two new bearing trees:

A hemlock, 11 ins. diam., bears N27°E, 13.0 ft. dist., scribed "4 MS 7368A BT."
A fir, 7 ins. diam., bears N67°E, 14.9 ft. dist., scribed "4 MS 7368A BT."
(Distances measured to faces of B.T.'s).

Painted bearing trees and attached Land Survey Monument and Bearing Tree signs.

Magnetic Declination: 20° East.

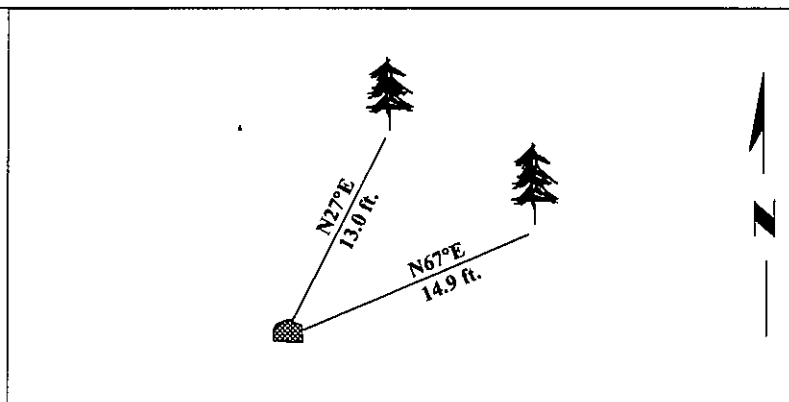

SKETCH OF CORNER

CERTIFICATION

I, Rex O. Rice

certify the information shown herein is true and correct.

Rex O. Rice

I, Alvah F. Hughes

certify that this Corner Record correctly represents work performed by me or under my direction in compliance with the "Corner Recordation Act" (70-22-101, et seq., M.C.A.)

Alvah F. Hughes
Signature of Surveyor & Seal

Date: 11/25/96

Reg. No.: 7322LS

Employer: U.S. FOREST SERVICE

Sec. 13

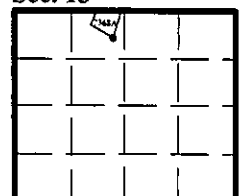

• - corner this sheet

Office of Clerk and Recorder, County of LINCOLN. This "corner record" was filed for record on FEB 3, 1997 was noted on the cross-index plat and is assigned page No. 9131 in book No. CORAL M. CUMMINGS

County Official *By JLB*

Cross Index No. 4 MS 7368A T. 26N R. 31W P.M., MT