

# CERTIFIED CORNER RECORDATION

Corner 1 MS 7368A Sec. 12 T. 26 N R. 31 W P.M., MT Lincoln County

I. 1904 G.L.O. original survey by Abram L. Jaqueth: Set a quartzite stone, 30 x 15 x 7 ins., 24 ins. deep, chiseled 1-7368A, from which:

A balsam fir, 8 ins. diam., bears N80°E, 25.4 ft. dist., scribed "B.T. 1-7368A".  
A hemlock, 24 ins. diam., bears S72°20'W, 24.6 ft. dist., scribed "B.T. 1-7368 A".

II. Found a stone, firmly set, 12 x 7 ins., 8 ins. above ground, with visible chisel marks on the SW face, from which:

Rotten remains, bears S66°W, 18.5 ft. dist. (Rec. S72°W, 24.6 ft.).

III. Established two new bearing trees:

A hemlock, 9 ins. diam., bears N28°E, 10.5 ft. dist., scribed "1 MS 7368A BT."  
A hemlock, 7 ins. diam., bears S8°E, 17.5 ft. dist., scribed "1 MS 7368A BT."  
(Distances measured to faces of B.T.'s).

Painted bearing trees and attached Land Survey Monument and Bearing Tree signs.

Magnetic Declination: 20° East.

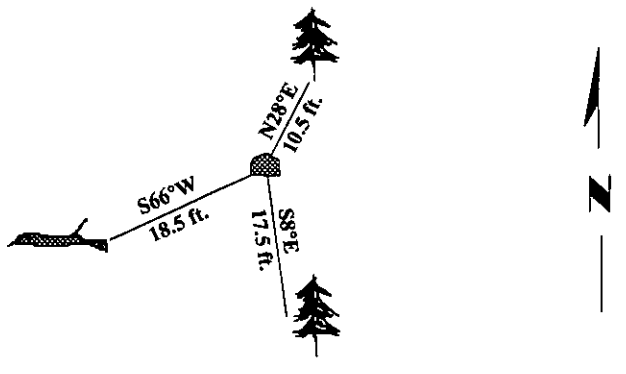

SKETCH OF CORNER

## CERTIFICATION

I, Rex O. Rice  
certify the information shown herein is true and correct.

Rex O. Rice

I, Alvah F. Hughes  
certify that this Corner Record correctly represents work performed by me, or under my direction in compliance with the "Corner Recordation Act", §70-22-101, et seq., M.C.A.)

Alvah F. Hughes  
Signature of Surveyor & Seal

Date: 11/25/96

Reg. No.: 7322LS

Employer: U.S. FOREST SERVICE

Sec. 12

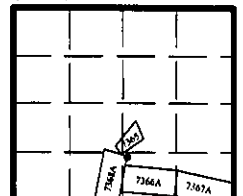

• - corner this sheet

Office of Clerk and Recorder, County of LINCOLN. This "corner record" was filed for record on FEB 2, 1997 was noted on the cross-index plat and is assigned page No. 9129, in book No. CORAL M. CUMMINGS

County Official [Signature]

Cross Index No. 1 MS 7368A T. 26N R. 31W P.M., MT