

CERTIFIED CORNER RECORDATION

Corner **MS 7368-A COR. 2 Sec. 12 T. 26N R. 31W P.M.,MT Lincoln County**
SUMMIT LODGE

- I. 1904 Original Mineral Survey by U.S. Deputy Mineral Surveyor Abram L. Jaqueth: Set a quartzite stone 26x12x8 ins. 20 ins. deep chiseled 2-7368A for Cor. No. 2; from which:
- A balsam fir tree 8 ins. diam. bears N 51°38'E 31.5 ft.
 - A hemlock tree 18 ins. diam. bears S 71°E 3.8 ft.
 - Both trees are blazed and scribed B.T. 2-7368A.

- II. Found original quartzite stone monument 12x6 ins., 8 ins. above ground firmly set with 2-7368A chiseled on face. No evidence of original bearing trees were recovered.

- II. We established two new bearing trees described as follows:

- A subalpine hemlock, 6 ¼ ins. diameter bears N 21°W, 10.80 ft. distant scribed (MS 7368-A BT).
- A subalpine hemlock, 13 ins. diameter bears S 83°E, 12.00 ft. distant scribed (MS 7368-A BT).

Attach bearing tree and land survey monument signs to both trees.

Paint scribed faces and 6 in. wide bands red on both trees.

Removed all brush and debris in a 10.00 ft. radius from around corner.

Set a 6 ft. galvanized steel guard post with survey monument and property boundary decals, 3.0 ft. south of corner.

SKETCH OF CORNER

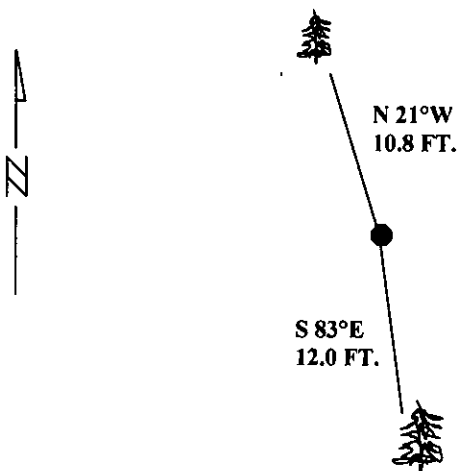

CERTIFICATION

I, John R. Damon certify the information shown herein is true and correct

John R. Damon
Signature of Ground Party Chief

I, Alvah F. Hughes certify that this Corner Record correctly represents work performed by me or under my direction in compliance with the "Corner Recordation Act: (70-22-101, et seq., M.C.A.)"

Alvah F. Hughes
Signature of Surveyor & Seal

Date: 3/22/2000

Reg. No.: 7322LS

Employer: Kootenai Surveyors, Inc.

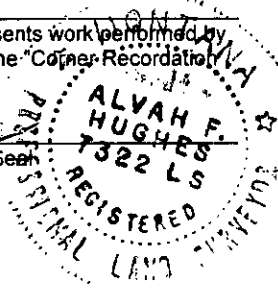

Office of Clerk and Recorder, County of Lincoln. This "corner record" was filed for record on Apr 7, 2000 was noted on the cross-index plat and is assigned page No. 10440 in book No. _____

Coral M. Cummins by dsb
County Official

