

INSTRUCTIONS

1. Original and/or subsequent record used to evaluate the corner position.
2. Description of evidence found, note discrepancies in the record, state method of establishing lost or obliterated corners.
3. Description of monument and accessories set to perpetuate the corner position.
4. Sketch of corner, show all pertinent data which can best be shown in a sketch example, corner marking, topography ties, position of accessories, etc.
5. Certification must be signed and sealed by Land Surveyor registered in the State of Montana.
6. Fill in Cross Index & Section Diagram at bottom of sheet.

CERTIFIED CORNER RECORDATION

Corner E 1/4 of Sec. 36 T. 26 N. R. 30 W. P.M.M. Lincoln County

- I. 1908 original G.L.O. record by H. B. GRANT: Set a slate stone, 16 X 8 X 8 ins., 11 ins. in the ground, for 1/4 sec. cor., marked 1/4 on W. face, from which:

A fir, 6 ins. diam., bears S70° E, 28 lks. dist., marked 1/4 S 31 BT.

A fir, 16 ins. diam., bears N30° W, 20 lks. dist., marked 1/4 S 36 BT.

1916 G.L.O. resurvey by F. WALTERS et al: Set an iron post, 3 ft. long, 1 in. in diam., 24 ins. in the ground, for 1/4 sec. cor. for sec. 36 only, with brass cap marked:

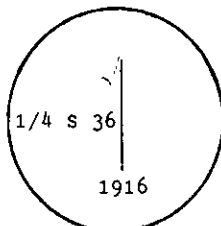

and raise a mound of stone, 2 ft. base, 1 1/2 ft. high, W. of cor..

- II. No original corner monument found, due road construction.

No original bearing trees found, due past fire.

- III. At the position determined by single proportion measurement, set a 3/4 ins. dia., 30 in. long aluminum rod, with a 3 1/4 in. diam. aluminum cap, 6 ins. below Allen Peak roadbed, marked as shown below:

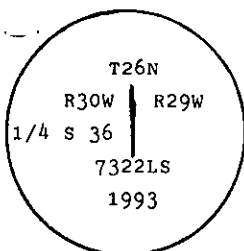

SEE REVERSE FOR DETAILS.

Established two new bearing trees:

A pine, 11 ins. diam., bears N11° E, 18.9 ft. dist., mkd. 1/4 S36 BT.

A larch, 11 ins. diam., bears S79° W, 53.0 ft. dist., mkd. 1/4 S36 BT.

Painted a red band around bearing trees and attached Land Survey Monument and Bearing Tree signs.

Set a 6 ft. galvanized steel guard post with Land Survey Marker and Property Boundary decals, SOUTH, 3 ft.

Magnetic Declination: 20° East.

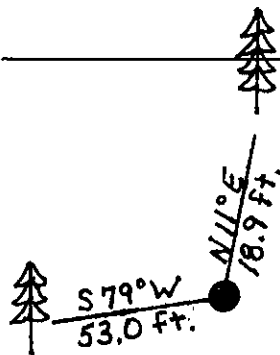

SKETCH OF CORNER

CERTIFICATION

Kenneth Kern

I, Kenneth Kern certify the information shown herein is true and correct.

Kenneth Kern
Signature Ground Party Chief

Alvah F. Hughes

I, Alvah F. Hughes certify that this Corner Record correctly represents work performed by me or under my direction in compliance with the "Corner Recordation Act" (70-22-101, et seq., M.C.A.).

Alvah F. Hughes
Signature of Surveyor & Seal

Date: 12/15/93 Reg. No. 7322LS

Employer: U.S. FOREST SERVICE

Sec. 36

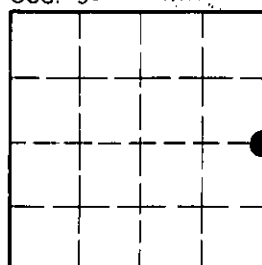

Office of Clerk and Recorder, County of Lincoln. This "corner record" was filed for record on Jan 19, 1993 was noted on the cross-index plat and is assigned page No. 5325, in book No. Coral M. Cumming GDB County Official

Cross Index No. X-25 T. 26 N R. 30 W P.M.M.

• - corner this sheet

N

(GLO - SOUTH - BASIS OF BEARING)

25
36

FD BC

30
31

(5.83 chs.)
385.39'

SET
AC
E 1/4
S36

CORNER FALLS ALONG NORTHERLY
EDGE OF ALLEN PEAK ROAD.

MEAS. 5231.47'
(GLO - 79.14' chs.)

36
6
FD BC
31

() = GLO RECORD

G = SET CORNER
AS NOTED