

INSTRUCTIONS

1. Original and/or subsequent record used to evaluate the corner position.
2. Description of evidence found, note discrepancies in the record, state method of establishing lost or obliterated corners.
3. Description of monument and accessories set to perpetuate the corner position.
4. Sketch of corner, show all pertinent data which can best be shown in a sketch example, corner marking, topography ties, position of accessories, etc.
5. Certification must be signed and sealed by Land Surveyor registered in the State of Montana.
6. Fill in Cross Index & Section Diagram at bottom of sheet.

CERTIFIED CORNER RECORDATION

Corner NW Cor. of Sec. 35 T. 26 N., R. 30 W., P.M.M. LINCOLN County

I. 1916 G.L.O. Original Record by S. Frank Walters: Set limestone, 24x12x10 ins., 18 ins. in the ground, for the cor. of secs. 26, 27, 34 and 35, mkd. with 1 notch on S. and 2 notches on E. edges, and raise a mound of stone, 2 ft. base, 1 1/2 ft. high W. of cor.

1968 B.L.M. Remonumentation: The cor. of secs. 26, 27, 34 and 35, monumented with a limestone, 24x12x10 ins., firmly set, mkd. with 2 notches on the E. edge and 1 notch on the S. edge and witnessed by a mound of stone W.

At the corner point

Set an iron post, 30 ins. long, 2 1/2 ins. diam., 24 ins. in the ground, with brass cap mkd.

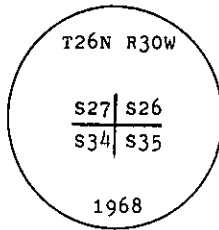

from which

- A pine, 9 ins. diam., bears N.41° E., 31 lks. dist., mkd. T26N R30W S26 BT.
- A pine, 10 ins. diam., bears S.41° E., 39 lks. dist., mkd. T26N R30W S35 BT.
- A pine, 9 ins. diam., bears S.51° W., 43 lks. dist., mkd. T26N R30W S34 BT.
- A pine, 8 ins. diam., bears N.41° W., 23 lks. dist., mkd. T26N R30W S27 BT.

Bury the original stone alongside the iron post.

II. Found a B.L.M. brass cap protruding 8 ins. out of the ground, mkd as shown above, from which

- A pine, 11 ins. dia., bears N.41° E., 20.9 ft. dist., (31 lks.) scribed T26N R30W S26 BT.
- A pine, 12 ins. dia., bears S.42° E., 25.6 ft. dist., (39 lks.) visible scribe 35 BT.
- A pine, 10 ins. dia., bears S.50° W., 28.3 ft. dist., (43 lks.) scribed T26N R30W S34 BT.
- A pine, 10 ins. dia., bears N.43° W., 10.3 ft. dist., (23 lks.) scribe overgrown.

III. Painted red bands around the bearing trees and attached Land Survey Monument and Bearing Tree signs. Set a 6 ft. galvanized steel guard post with Land Survey Marker and Property Boundary decals. South 3 ft. Magnetic Declination 20° E.

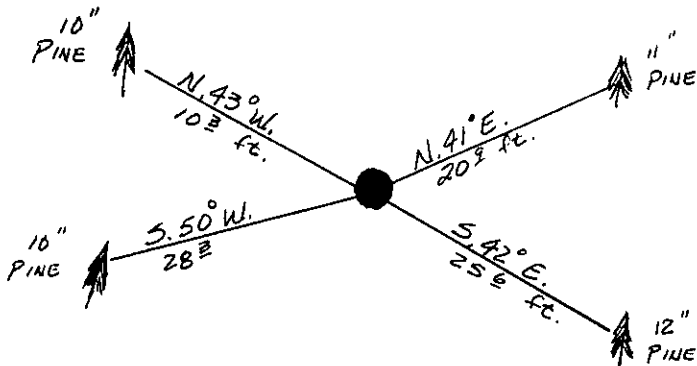

SKETCH OF CORNER

CERTIFICATION
Gary C. Crismon

I. certify the information shown herein is true and correct.

Gary C. Crismon
Signature Ground Party Chief
Alvah F. Hughes

I. certify that this Corner Record correctly represents work performed by me or under my direction in compliance with the "Corner Recordation Act" (70-22-101, et seq., M.C.A.)

Alvah F. Hughes
Signature of Surveyor & Seal
01/07/91 7323 322 LS

Date: _____ Reg. No. _____
U.S. FOREST SERVICE REGISTERED SURVEYOR
Employer: _____

Office of Clerk and Recorder, County of Lincoln. This "corner record" was filed for record on 1-10-91 was noted on the cross-index plat and is assigned page No. 4506, in book No. _____

Coral M. Cummings by Bill Buehly
County Official

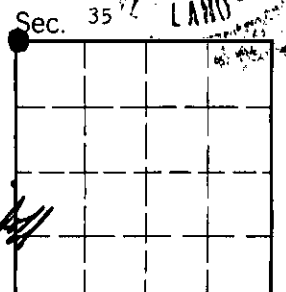

V 17 Cross Index No. _____ T. _____ R. _____ PMM

• - corner this sheet