

INSTRUCTIONS

1. Original and/or subsequent record used to evaluate the corner position.
2. Description of evidence found, note discrepancies in the record, state method of establishing lost or obliterated corners.
3. Description of monument and accessories set to perpetuate the corner position.
4. Sketch of corner, show all pertinent data which can best be shown in a sketch example, corner marking, topography ties, position of accessories, etc.
5. Certification must be signed and sealed by Land Surveyor registered in the State of Montana.
6. Fill in Cross Index & Section Diagram at bottom of sheet.

CERTIFIED CORNER RECORDATION

Corner Sec Cor. Secs. 16, 17, 20, 21 T. 26 N. R. 29 W. P.M.M. Lincoln County

I. 1900 G.L.O. record by Burton S. Adams: Set a limestone and four bearing trees.

1984 Land Corner Record by Dick R. Griffin: Found set granite stone (3" X 12" X 6" high) with 4 notches on South and 4 notches on East face. Rock pile on North East side. Location sign is posted on 6 in. larch 11 lks. N 75° E of corner.

Set a 3" X 30" aluminum pipe with 3 1/2" aluminum cap stamped as shown below. Buried original stone upside down on East side of pipe. Raised a 3' diameter X 1' high granite mound around monument. Drove 6' steel post with 54-9 sign 1' North of corner. Monument protruding 6".

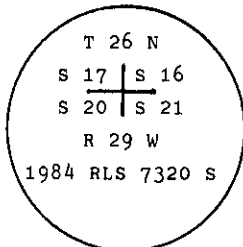

from which

- A 10" ponderosa pine bears N 41° W, 21.9'.
- A 10" ponderosa pine bears N 50° E, 13.3'.
- A 15" ponderosa pine bears S 50° E, 14.5'.
- A 8" larch bears S 39° W, 15.3'.

All BT's are base blazed and scribed "BT" with blaze painted red. All BT's have 6' red band painted 6' high and 54-3 signs attached.

II. Found a U.S.F.S. aluminum cap firmly set in place, with small rock collar, marked as shown above, and a 6 ft. galv. steel post 1 ft. NORTH of corner.

from which

- A fir 10 ins. diam., bears N 50° E, 13.3 ft. dist., mkd. SW S 16 BT. (Rec. Ponderosa pine)
- A fir 14 ins. diam., bears S 50° E, 14.5 ft. dist., mkd. NW S 21 BT. (Rec. Ponderosa pine)
- A fir 8 ins. diam., bears S 39° W, 15.3 ft. dist., mkd. NE S 20 BT. (Rec. Larch)
- A fir 11 ins. diam., bears N 41° W, 21.9 ft. dist., mkd. SE S 17 BT. (Rec. Ponderosa pine)

III. Aluminum cap and all accessories found in good condition.

Magnetic Declination: 20° East

CERTIFICATION

I. Kenneth R. Kern  
 certify the information shown herein is true and correct.  
Kenneth R. Kern  
 Signature Ground Party Chief

II. Alvah F. Hughes  
 certify that this Corner Record correctly represents a proper corner formed by me or under my direction in compliance with the "Corner Recordation Act" (70-22-101, et seq., M.C.A.)  
Alvah F. Hughes  
 Signature of Surveyor & Seal  
 Date: 6/29/92 Reg. No. 7322-LS  
 Employer: U.S. FOREST SERVICE

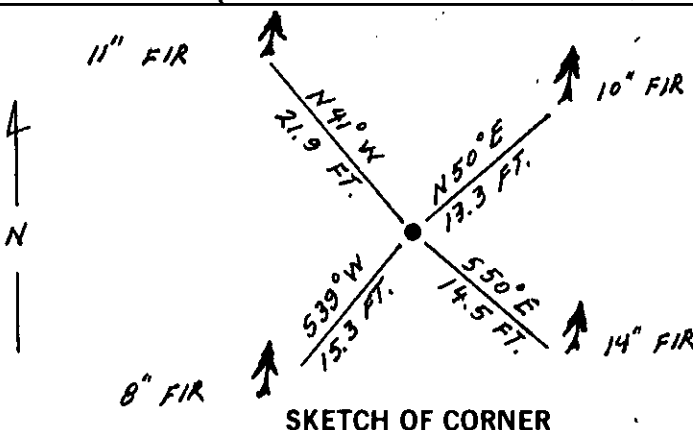

SKETCH OF CORNER

Office of Clerk and Recorder, County of Lincoln. This "corner record" was filed for record on 12-14-92 was noted on the cross-index plat and is assigned page No. 5149, in book No. Coral M Cummings by BKB

County Official

N-09 26 N 29 W  
 Cross Index No. \_\_\_\_\_ T. \_\_\_\_\_ R. \_\_\_\_\_ P.M.M.

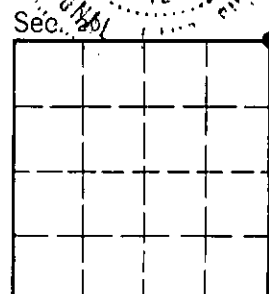

• - corner this sheet