

## INSTRUCTIONS

1. Original and/or subsequent record used to evaluate the corner position.
2. Description of evidence found, note discrepancies in the record, state method of establishing lost or obliterated corners.
3. Description of monument and accessories set to perpetuate the corner position.
4. Sketch of corner, show all pertinent data which can best be shown in a sketch example, corner marking, topography ties, position of accessories, etc.
5. Certification must be signed and sealed by Land Surveyor registered in the State of Montana.
6. Fill in Cross Index & Section Diagram at bottom of sheet.

## CERTIFIED CORNER RECORDATION

Corner C 1/4 Sec. 30 T. 26 N. R. 29 W. P.M.M. Lincoln County

I. Section subdivision record, C.O.S. #1330 by D. K. Marquardt, reg. # 2989 ES in 1984:

"Set 5/8 ins. diam. x 24 ins. rebar with plastic cap, stamped 2989 E.S."

II. Found a 5/8 ins. diam. rebar, 4 ins. out of ground, with yellow plastic cap, mkd. D.K. Marquardt 2989ES.

III. In place of found rebar, set a 2 1/2 ins. diam. aluminum pipe, 30 ins. long, 24 ins. in the ground with attached 3 1/4 ins. dia. U.S.D.A. Forest Service aluminum cap, marked as shown:

T26N R29W  
C 1/4 S30  
7322LS  
1991

from which

A ponderosa pine, 8 ins. diam., bears N38°E, 11.4 ft. dist., mkd. C 1/4 S30 BT.

A ponderosa pine, 14 ins. diam., bears S44°E, 10.7 ft. dist., mkd. C 1/4 S30 BT.

Place rebar inside aluminum pipe monument.

Set a 6 ft. galvanized steel guard post with "Survey Marker" and "Property Boundary" decals attached, 3 ft., North. Painted a red band around each bearing tree and attached "Land Survey Monument" & "Bearing Tree" signs.

Magnetic Declination: East, 20°

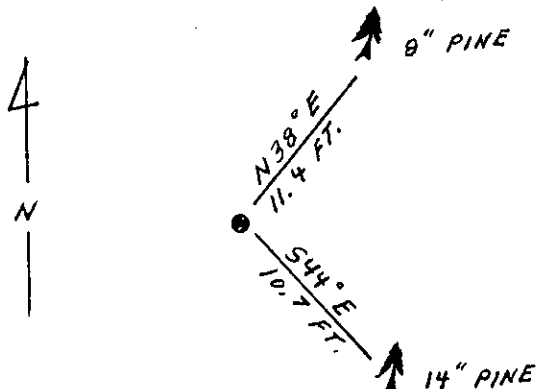

SKETCH OF CORNER

## CERTIFICATION

I, Kevin A. Todd  
certify the information shown herein is true and correct.

Kevin A. Todd  
Signature Ground Party Chief

I, Alvah F. Hughes

certify that this Corner Record correctly represents work performed by me or under my direction in compliance with the Montana Recordation Act" (70-22-101, et seq., M.C.A.)

Alvah F. Hughes  
Signature of Surveyor & Seal

Date: 11/19/91 Reg. No. 7322

Employer: U.S. FOREST SERVICE

Office of Clerk and Recorder, County of Lincoln. This "corner record" was filed for record on Dec 18, 1991 was noted on the cross-index plat and is assigned page No. 4613 in book No. Coral M Cummings by Bill Buckhoff

County Official

T3

26 N 29 W

Cross Index No. T. R. PMM

Sec. 30

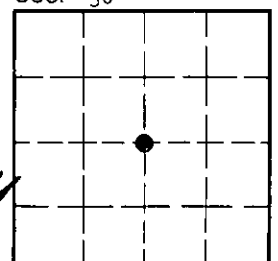

• - corner this sheet