

CERTIFIED LAND CORNER RECORDATION

DESCRIPTION OF CORNER EVIDENCE FOUND, AND ORIGINAL RECORD (IF KNOWN)

ORIGINAL G.L.O. NOTES: "Set a limestone, 14X10X5 ins., 10 ins. in the ground, for 1/4 sec. cor. marked 1/4 on W. face; from which A tamarack, 28 ins. diam., bears N.29°15'E., 35 lks. dist., marked 1/4 S 17 B T. A Fir, 10 ins. diam., bears S.9°45'W., 38 lks. dist., marked 1/4 S 18 B T."

FOUND: B.L.M. BRASS-CAP MONUMENT

DESCRIPTION OF MONUMENT AND ACCESSORIES ESTABLISHED TO PERPETUATE THE ORIGINAL LOCATION OF THIS CORNER:

Date of work: June 26, 1975

SEE ATTACHED SHEETS
TAKEN FROM B. L. M. RECORDS

SKETCH, WITH COURSE AND DISTANCE TO ADJACENT CORNERS IF DETERMINED IN THIS SURVEY.
(MAY SKETCH OR PASTE REPRODUCTION ON REVERSE SIDE.)

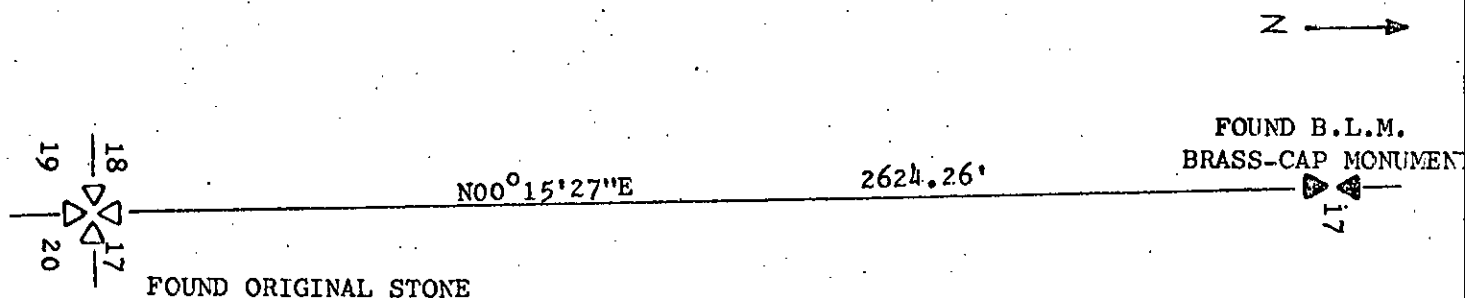

Surveyor's Seal

I, JAMES BURTON
certify that the information shown herein is true and correct.

Signature of Ground Party Chief

I, M. L. HAIGES
certify that I have carefully performed or reviewed the work done on the diagrammed corner as reported on this recordation form and approve the same.

Signature of Surveyor

DIAGRAM OF CORNER:

N. T26N R29W

18 17

E. 1/4 Cor. Sec. 18
= Corner recorded on the sheet

2520 S
Registration Number

Office of Clerk and Recorder, County of Lincoln

This "corner record" was filed for record on the 30th day of June 1975, was noted on the cross-index plat and is assigned page No. 379, in book No. 1

County Official

Township 26 North, Range 29 West, Principal Meridian, Montana

CHAINS

A pine, 5 ins. diam., bears N. 46° E., 9 lks. dist., mkd. $\frac{1}{4}$ S30 BT.

A pine, 5 ins. diam., bears S. 63° W., 10 lks. dist., mkd. $\frac{1}{4}$ S31 BT.

Bury the original stone alongside of the iron post.

The $\frac{1}{4}$ sec. cor. of secs. 19 and 30, monumented with a limestone, 12 x 10 x 5 ins., firmly set and mkd. $\frac{1}{4}$ on the N. face, and witnessed by the remains of one of the original bearing trees.

At the corner point

Set an iron post, 30 ins. long, $2\frac{1}{2}$ ins. diam., 27 ins. in the ground, with brass cap mkd.

T26N R29W

$\frac{1}{4}$ S 19
S 30
1964

from which

The remains of the original bearing tree:

A stumphole, bears S. 8° W., 8 lks. dist., remains of tree lying on ground, mkd. $\frac{1}{4}$ S30 BT. (Record: S. 8° E., 8 lks.)

The new bearing trees:

A pine, 6 ins. diam., bears S. 6° W., 20 lks. dist., mkd. $\frac{1}{4}$ S30 BT.

A pine, 5 ins. diam., bears N. 61° W., 5 lks. dist., mkd. $\frac{1}{4}$ S19 BT.

Bury the original stone alongside of the iron post.

The $\frac{1}{4}$ sec. cor. of secs. 17 and 18, monumented with a limestone, 14 x 10 x 5 ins., loosely set and mkd. $\frac{1}{2}$ on the W. face, and witnessed by the remains of one of the original bearing trees.

At the corner point

Set an iron post, 30 ins. long, $2\frac{1}{2}$ ins. diam., 27 ins. in the ground, with brass cap mkd.

T26N R29W

$\frac{1}{2}$
S 18 S 17
1964

from which

The remains of the original bearing tree:

A dead larch, 26 ins. diam., bears N. $29\frac{1}{4}^{\circ}$ E., 35 lks. dist., mkd. $\frac{1}{4}$ S17 BT. (Record)

The new bearing trees:

A pine, 12 ins. diam., bears S. $80\frac{1}{2}^{\circ}$ E., 53 lks. dist., mkd. $\frac{1}{4}$ S17 BT.

Township 26 North, Range 29 West, Principal Meridian, Montana

CHAINS

A pine, 12 ins. diam., bears S. 42° W., 51 lks.
dist., mkd. $\frac{1}{4}$ S18 BT,

Bury the original stone alongside of the iron post.

The $\frac{1}{4}$ sec. cor. of secs. 8 and 17, monumented with a limestone, 14 x 8 x 6 ins., firmly set and mkd. $\frac{1}{4}$ on the N. face, and witnessed by the remains of one of the original bearing trees.

At the corner point

Set an iron post, 30 ins. long, $2\frac{1}{2}$ ins. diam., 27 ins. in the ground, with brass cap mkd.

T26N R29W

$\frac{1}{4}$ S 8
S 17
1964

from which

The remains of the original bearing tree:

A stump, 20 ins. diam., bears S. $73\frac{1}{2}^{\circ}$ W., 64 lks. dist. (Record)

The new bearing trees:

A pine, 5 ins. diam., bears N. 36° E., 36 lks. dist., mkd. $\frac{1}{4}$ S8 BT.

A pine, 10 ins. diam., bears S. 15° W., 16 lks. dist., mkd. $\frac{1}{4}$ S17 BT.

Bury the original stone alongside of the iron post.

Township 26 North, Range 30 West

These field notes are those of the remonumentation of certain corners of the survey executed by Fred I. Hubbard, in 1903, in Township 26 North, Range 30 West, of the Principal Meridian, Montana.

The $\frac{1}{4}$ sec. cor. of secs. 2 and 3, monumented with a sandstone, 14 x 10 x 6 ins., firmly set and mkd. $\frac{1}{4}$ on the W. face, and witnessed by the remains of the original bearing trees.

At the corner point

Set an iron post, 30 ins. long, $2\frac{1}{2}$ ins. diam., 27 ins. in the ground, with brass cap mkd.

T26N R30W

$\frac{1}{4}$
S 3 S 2
1964

from which

The remains of the original bearing trees:

A stump, 20 ins. diam., bears S. 37° E., 14 lks. dist., visible marks $\frac{1}{4}$ S2. (Record)