

INSTRUCTIONS

1. Original and/or subsequent record used to evaluate the corner position
2. Description of evidence found, note discrepancies in the record, state method of establishing lost or obliterated corners
3. Description of monument and accessories set to perpetuate the corner position
4. Sketch of corner, show all pertinent data which can best be shown in a sketch example, corner marking, topography ties, position of accessories, etc.
5. Certification must be signed and sealed by Registered Land Surveyor in State of Montana
6. Fill in Cross Index & Section Diagram at bottom of sheet.

CERTIFIED CORNER RECORDATION

Corner S 8 | S 9 S 17 | S 16 T. 26 N R. 29 W P.M.M. : Lincoln County
 Date of work: December, 1982

1. {a} 1903 - B.L.M. Original Record;
 Set a limestone, 22x16x8 ins., 17 ins. in the ground, for cor. of secs. 8, 9, 16 and 17, marked with 4 notches, each, on S. and E. edges, from which:
 A tamarack, 30 ins. diam., bears N. 38°10' E., 18 lks. dist., marked T26N R29W S9 BT.
 A fir, 8 ins. diam., bears S. 73° E., 19 lks. dist., marked T26N R29W S16 BT.
 A pine, 9 ins. diam., bears S. 31°45' W., 25 lks. dist., marked T26N R29W S17 BT.
 A pine, 10 ins. diam., bears N. 19° W., 25 lks. dist., marked T26N R29W S8 BT.
 {b} 1964 - B.L.M. record; found a limestone, 22x16x8 ins., firmly set and marked with 4 grooves on the S. and E. faces, and witnessed by the remains of one of the original bearing trees. At the corner point. Set an iron post, 30 ins. long, 2 1/2 ins. diam., 28 ins. in the ground, with brass cap marked as shown below; from which:
 The remains of the original bearing tree:
 A stump, 30 ins. diam., bears N. 38° E., 18 lks. dist., with illegible scribing. {Record: N. 38°10' E., 18 lks.}
 The new bearing trees:
 A pine, 5 ins. diam., bears N. 75 3/4° E., 20 lks. dist., mkd. T26N R29W S9 BT.
 A pine, 5 ins. diam., bears S. 9° E., 28 lks. dist., mkd. T26N R29W S16 BT.
 A pine, 5 ins. diam., bears S. 33° W., 39 lks. dist., mkd. T26N R29W S17 BT.
 A pine, 5 ins. diam., bears N. 62° W., 19 lks. dist., mkd. T26N R29W S8 BT.
 Bury the original stone alongside of the iron post.
2. 1982- Found a 2 1/2 ins. iron post, approx. 2 ins. above ground with B.L.M. brass cap marked as shown below; from which:
 A stump, 30 ins. diam., bears N. 38° E., 18 lks. dist., with illegible scribing. {Record: N. 38°10' E., 18 lks.}
 A pine, 6 ins. diam., bears N. 75 3/4° E., 20 lks. dist., mkd. T26N R29W S9 BT.
 A pine, 6 ins. diam., bears S. 9° E., 28 lks. dist., mkd. T26N R29W S16 BT.
 A pine, 8 ins. diam., bears S. 33° W., 39 lks. dist., mkd. T26N R29W S17 BT.
 A pine, 8 ins. diam., bears N. 62° W., 19 lks. dist., mkd. T26N R29W S8 BT.
 A pine, 6 ins. diam., bears approx. North, approx. 8 ft., with location poster.
3. ~~No additional accessories set to perpetuate monument.~~

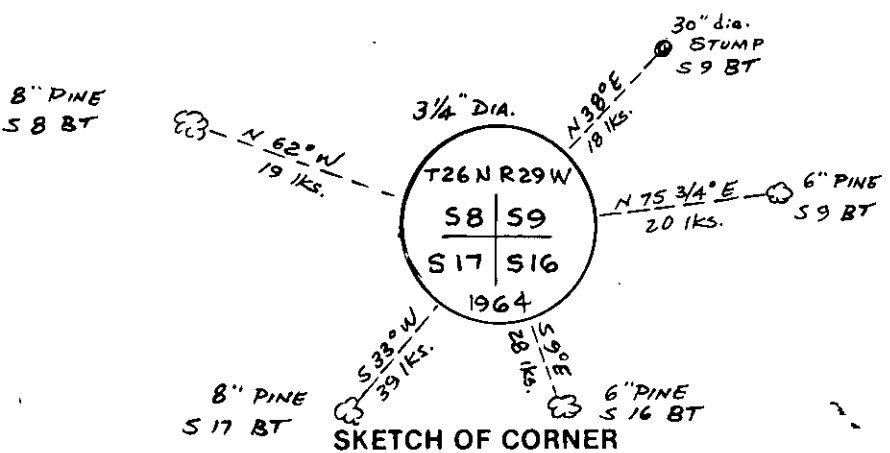

CERTIFICATION

I, L.A. Dolezal
 certify the information shown herein is true and correct.
 Signature of Ground Party Claimant

I, Melvin D. Lauteren
 certify that this Corner Record correctly represents work performed by me or under my direct or indirect supervision in compliance with the "Corner Recordation Act" (70-22-101, M.C.A.)
 Signature of Surveyor & Seal

Date: 1-7-83 Reg. No. 4232 S
 Employer: Kootenai Engineering, Inc.

Office of Clerk and Recorder, County of Lincoln. This "corner record" Sec. 9-T26N-R29W-PMM
 was filed for record on the 20th day of April 19 83, was noted on the cross-index plat and
 is assigned page No 2202, in book No. Janet B. L. Sigel by Henry L. Hawke
 County Official Deputy
 Cross Index No. J-9 T. 26 R. 29 P.M.M.
 - corner this street