

INSTRUCTIONS

1. Original and/or subsequent record used to evaluate the corner position.
2. Description of evidence found, note discrepancies in the record, state method of establishing lost or obliterated corners.
3. Description of monument and accessories set to perpetuate the corner position.
4. Sketch of corner, show all pertinent data which can best be shown in a sketch example, corner marking, topography ties, position of accessories, etc.
5. Certification must be signed and sealed by Registered Land Surveyor to State of Montana.
6. Fill in Cross Index & Section Diagram at bottom of sheet.

CERTIFIED CORNER RECORDATION

Corner

| | |
|-----|------|
| S 4 | S 3 |
| S 9 | S 10 |

 T. 26 N R. 29 W P.M.M. Lincoln County

1. (a) 1903 - B.L.M. Original record; set a fir post, 3 ft. long, 4 ins. sq., 24 ins. in the ground, for cor. of secs. 3,4,9 and 10 marked:

T26N S3 on NE,
R29W S10 on SE,
S9 on SW, and
S4 on NW faces; marked with 5 notches on S and 3 notches on E edge, from which:

- A Fir, 9 ins. diam., bears N80°E, 25 lks dist., marked T26N R29W S3BT.
- A Tamarack, 30 ins. diam., bears S71° 45'E, 7 lks. dist., marked T26N R29W S10BT.
- A Pine, 10 ins. diam., bears S22°45'W, 20 lks. dist., marked T26N R29W S9BT.
- A Fir, 10 ins. diam., bears N54°W, 40 lks. dist., marked T26N R29W S4BT.

(b) 1964 - B.L.M. record; found a disintegrated wooden post, firmly set in the ground, and witnessed by the remains of two of the original bearing trees. At the corner point; Set an iron post, 30 ins. long, 2 1/2 ins. diam. 27 ins. in the ground, with brass cap marked as shown below; from which:

The remains of the original bearing trees:

- A stump, 36 ins. diam., bears S71-3/4°E, 7 lks. dist., visible marks BT.(Record)
- A Pine, 12 ins. diam., bears S22-3/4°W, 20 lks. dist., marked with an overgrown blaze. (Record)

The new bearing trees:

- A Pine, 8 ins. diam., bears S32°E, 139 lks. dist., marked T26N R29W S10BT.
- A Pine, 12 ins. diam., bears N46-3/4°W, 129 lks. dist., marked T26N R29W S4BT.

Bury the remains of the original wooden post alongside of the iron post.

2. 1982 - Found a 2 1/2" iron post approx. 8 ins. above ground with BLM brass cap marked as shown below; from which:

- A Larch stump, 36 ins. diam., bears S71-3/4°E, 7 lks. dist., visible marks BT (Record)
- A dead Pine, 14 ins. diam., bears S22-3/4°W, 20 lks. dist., marked with an overgrown blaze, partially opened (Record)
- A Pine, 11 ins. diam., bears S32°E, 139 lks. dist., marked with partially overgrown blaze. (Record)
- A Pine, 16 ins. diam., bears N46-3/4°W, 129 lks. dist., marked with partially overgrown blaze. (Record)

3. No additional accessories set to perpetuate monument.

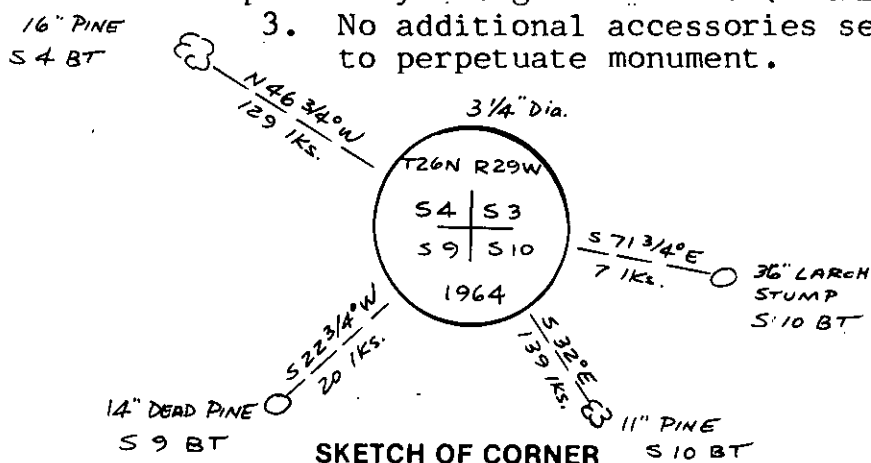

SKETCH OF CORNER

CERTIFICATION

I, L. A. Dolezal
 certify the information shown herein is true and correct.
 Signature L. A. Dolezal
 Title County Party Chief

I, Melvin D. Lauteren
 certify that this Corner Record correctly represents work performed by me or under my direction in compliance with the Corner Recordation Act (70-22-10), et seq., M.C.A.S.
 Signature Melvin D. Lauteren
 Title REGISTERED LAND SURVEYOR

Date: 10/15/82 Reg. No. 4232

Employer: KOOTENAI ENGINEERING, INC.

Office of Clerk and Recorder, County of LINCOLN. This "corner record" Sec. 9-T26N-R29W-PMM was filed for record on the 15 day of OCT 1982, was noted on the cross-index plat and is assigned page No. 1959, in book No. Eleanor L. Vaughn by Betty L. Conces County Official deputy

Cross Index No. 26 R. 29 P.M.M.

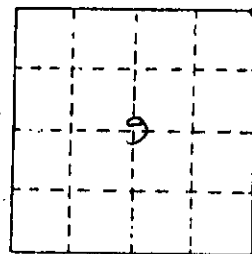

• corner this sheet