

1. Original and/or subsequent record used to evaluate the corner position.
2. Description of evidence found, note discrepancies in the record, state method of establishing lost or obliterated corners.
3. Description of monument and accessories set to perpetuate the corner position.
4. Sketch of corner, show all pertinent data which can best be shown in a sketch example, corner marking, topography ties, position of accessories,
5. Certification must be signed and sealed by Land Surveyor registered in the State of Montana.

CERTIFIED CORNER RECORDATION

Corner: Section Corner; Secs. 2, 3, 34 & 35 T. 25N & 26N R. 29W P.M.M. Lincoln County
1903 GLO Record: Set limestone and established 4 bearing trees

1978 BLM Record: Found original stone and 4 original bearing trees.
An 18" pine, bears N65°E, 107 lks (70.62 ft.), with an overgrown blaze
A 16" pine, bears S80 1/2°E, 91 lks (60.06 ft.), mk'd T25N R29W S2 BT
(GLO Record S80°30'E)
A 20" pine, bears S30°3/4'W, 140 lks (92.4 ft.), with an overgrown blaze
A 12" pine, bears N22 1/4°W, 134 lks (88.4 ft.), mk'd T26N R29W S34 BT
(GLO Record 123 lks)
Set an iron post 30 ins. long, 2 1/2" diam., 16" in the ground, and in a supporting collar of stone
3 feet diameter to top, with brass cap. Buried original stone alongside the iron post.

2006 Record:
(Staples) Found standard 3 1/4" brass cap on 2 1/2" iron pipe, 1 1/2 ft. above the ground in a mound of
stone, from which:
A 26" Ponderosa pine, bears S29 1/2°W, 93.29 ft., with overgrown scribe & BT tag
"N30 3/4°E, 140 lks (92.4 ft.)"
A 22" Ponderosa pine, bears S80 3/4°E, 61.25 ft., with a partially overgrown scribe
"T25NR29WS2 & BT tag "N80 1/2°W, 91 lks (60.06 ft.)"
A 27" Ponderosa pine, bears N64 1/2°E, 70.28 ft., with an overgrown scribe & BT tag
"S65°W, 107 lks(70.62 ft.)"
A 19" Ponderosa pine, bears N22 1/4°W, 87.60 ft., with a partially overgrown scribe
"26NR29WS3" & BT tag "S22 1/4°, 134 lks(88.44 ft.)"

2009 Found: We find a standard BLM monument with a 3 1/4" brass cap, firmly set, in good condition, rising
18" above the ground, in mound of stone; marked as shown below, from which:
A 20" Ponderosa pine bears N64 1/2°E, 70.3 ft., with an overgrown blaze
An 18" Ponderosa pine bears S80 3/4°E, 61.3 ft., with visible scribing
A 24" Ponderosa pine stump, 5 ft. high, bears S29 1/2°W, 93.3 ft., with an overgrown
blaze
An 18" Ponderosa pine bears N25°W, 87.6 ft., with visible scribing

2009 Perpetuation: We establish no new reference monuments
We attach new P54-1 & P71-10 signs on existing steel post.
We paint red bands on the existing bearing trees, and attached USFS signs 54-3 & 54-9.
SEE COS NO. 3992

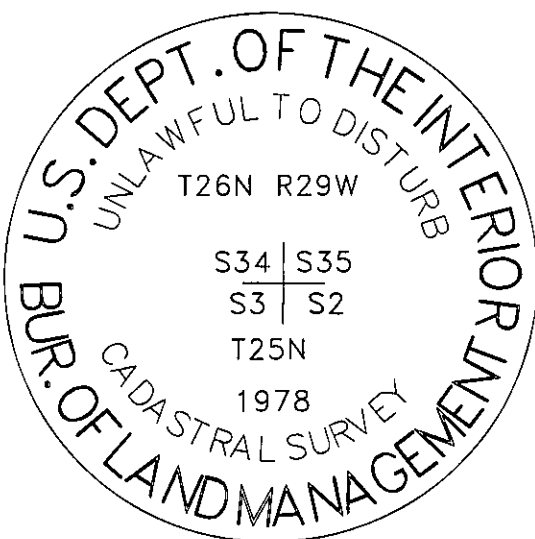

SKETCH OF CORNER

CERTIFICATION

I, Chad R. Breuer
certify the information shown herein is true and
correct.
Chad R. Breuer
Signature Ground Party Chief

I, Ken E Jenkins
certify that this Corner Record correctly
represents work performed by me or under my
direction in compliance with the Corner
Recordation Act" (70-22-101, et seq., M.C.A.)
Ken E Jenkins
Signature of Surveyor & Seal

Date: 8/2009 Reg. No. 9330-LS
Employer: Montana Northwest Company
PO Box 8777, Missoula, MT 59807
406-721-4033 Project No. 1617-09

Office of Clerk and Recorder, County of _____ This "corner
record" was filed for record on _____
was noted on the cross-index plat:
book No. _____

224872 BOOK: CCR CC&R'S PAGE: 11498 Pages: 1
STATE OF MONTANA LINCOLN COUNTY
RECORDED: 03/05/2010 9:40 KOI: CC&R'S
TAMMY D. LAUER, CLERK AND RECORDER
FEE: \$0.00 BY: *Tammy D. Lauer*
TO: MONTANA NORTHWEST COMPANY P.O. BOX 8777, MISSOULA, MONTANA
Cross Index No. Z-17 T. 26N R 29W PMM

Sec. 34

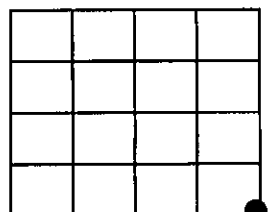

● Corner this sheet